

# Wine Country Classic Horse Show

## *SPRING FLING*

March 19 - 20, 2022

Galway Downs Equestrian Center, Temecula, California



### Rail Classes

Andalusian/ Lusitano, Open Breed Classes, American Colonial Ranching  
Breeds: *Spanish Barbs, BLM Mustangs, America's First Horse, Kiger Mustang, Morgan, Sulphur Horse*

Halter, Showmanship, Hunt Seat, Dressage Suitability, Dressage Hack, Show Hack, Saddle Seat, Western, Costume, Opportunity & Hunter / Jumper

### USA Working Equitation - Rated Show

Ranch Riding - WRHA

CDS Dressage

WDAA Western Dressage

WDAA Recognized Show #22-216



ALL SHOW INFORMATION AVAILABLE AT:

[www.WCCHorseShow.com](http://www.WCCHorseShow.com)

### **MANAGEMENT & STAFF**

WCCHS Manager: Chris Willson  
WCCHS Secretary: Ashlyn Dorsey  
WCCHS Coordinators: Amanda Latta-Portillo & Cheryl Croasmun  
Sponsorship Coordinator: Ashlyn Dorsey  
Veterinarian: Temeku Equine / On-Call  
Farrier: Sean Lorenzana, CF  
EMT: TBA  
Photographers: Steed & Hound Photography & Flagtvet Photography

### **RAIL CLASSES - LOS ARBOLES ARENA**

*Andalusian/Lusitano, American Colonial Ranching Breeds,  
Open Breed & Ranch Riding Classes*  
Judge: Gary Mullin, CA  
Paddock Marshal: TBA  
Announcer: Sean Dawson  
Ring Steward: Kathy Callahan-Smith, CA

### **WORKING EQUITATION - SYCAMORE ARENA**

Judge (Levels 1-5): Erica Peet, (r), IL.  
Judge (Level 6-7): Amy Star, (S), AZ.  
Manager: Julie Alonzo  
Secretary: Ashlyn Dorsey  
Assistant Secretary & Scorer: Janice Kall  
Technical Delegate: Amy Star  
Announcer: Peggy Knapp  
Paddock Marshal: Val Pearson  
WE Coordinators: Robin Bond and Glynn Hoekstra

### **DRESSAGE & WESTERN DRESSAGE - DRESSAGE ARENA**

*Judge: Renee Johnson, (S), WD (R) - CA.  
Scribe: TBA  
Technical Delegate: TBA*

## **STAFF & MANAGEMENT CONTACT INFORMATION**

WCC Manager	Chris Willson	<a href="mailto:crwproductionsinc@gmail.com">crwproductionsinc@gmail.com</a>	760-443-6723
WCC Secretary	Ashlyn Dorsey	<a href="mailto:ashlyn@kellerhousepresents.com">ashlyn@kellerhousepresents.com</a>	303-916-7962
WCC Coordinator	Amanda Latta-Portillo	<a href="mailto:winecountryclassichorseshow@gmail.com">winecountryclassichorseshow@gmail.com</a>	858-245-2148
WCC Coordinator	Cheryl Croasmun	<a href="mailto:c3showhorses@gmail.com">c3showhorses@gmail.com</a>	818-314-0798
WE Manager	Julie Alonzo	<a href="mailto:workingequitationoregon@gmail.com">workingequitationoregon@gmail.com</a>	Text 530-521-8755
Farrier	Sean Lorenzana, CJF.		661-972-5566
Veterinarian	Dr. Huth, Temeku Equine	<a href="https://www.temekuequine.com">https://www.temekuequine.com</a>	951-302-6646

Dear Friends of the Wine Country Classic Horse Show,

The Wine Country Classic Horse Show Management Team would like to thank you in advance for your support of the ***Wine Country Classic SPRING FLING Horse Show*** which will be held on March 19 - 20, 2022 at the Galway Downs Equestrian Center in Temecula, California. Just like last year, we promise to make this a memorable event that will provide the opportunity for community engagement amongst the different arenas and a stage for exposure and education on breeds and disciplines that are new to our show community.

This fun-filled weekend will be bringing a diverse group of horse competitors to the show ring. We will be kicking off the show on Friday evening with a **Welcome Party hosted by EQUIVONT**. On Saturday and Sunday the Sycamore Arena will be the stage for the **USA Working Equitation** Rated Show to kick off the 2022 show season. The Los Arboles Arena, sponsored by **Hacienda Laubela** will showcase a variety of breeds including classes for **Open Breed, Andalusians & Lusitanos, American Colonial Ranching Breeds, and Sulphur Horses**. A wide class offering to cover all disciplines will include, Halter, Showmanship, Hunt Seat, Dressage Suitability, Dressage Hack, Show Hack, Saddle Seat, Western, Costume and new this year the addition of Hunter / Jumper classes. There are also many classes for Youth, Green Horses and Just For Fun Classes too.

On Saturday we will offer; **Ranch Riding** classes licensed by **West Coast Ranch Horse Association** to include Ranch Confirmation, Ranch Rail, Ranch Riding and Ranch Trail to levels Open, Amateur, Youth and Green.

On Sunday, the Dressage arena will offer **Dressage** classes licensed by the **California Dressage Society** as well as **Western Dressage** licensed by **Western Dressage Association of America**.

While you are there, don't forget to take a stroll through Vendor Row and visit all of the vendors providing everything from, tack, jewelry, supplements, clothing and services.

As you know, a lot of time and planning goes into planning an event of this magnitude, We rely heavily on your support, through sponsorship, monetary and in-kind, participation and volunteering. You can find Sponsorship Opportunities on our website: [www.WCChorseshow.com](http://www.WCChorseshow.com) If you have any questions please contact us. We look forward to seeing everyone and their beautiful horses next month.

With sincere appreciation,

~The Wine Country Classic Management Team  
[WineCountryClassicHorseShow@gmail.com](mailto:WineCountryClassicHorseShow@gmail.com)  
[www.WCChorseshow.com](http://www.WCChorseshow.com)

# LOCATION | GALWAY DOWNS EQUESTRIAN CENTER

38801 Los Corralitos Rd, Temecula, CA 92592

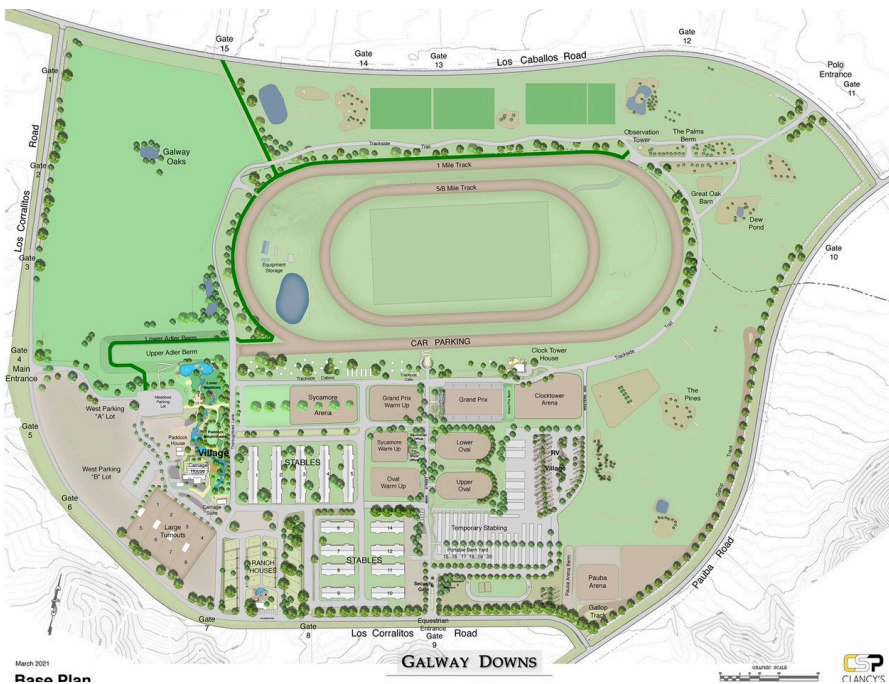

Galway Downs is a premier multi-purpose equestrian facility located in Temecula, California. Spanning over 240 acres, Galway Downs boasts 400 permanent stalls, a 1-mile race track, 5/8 mile training track, polo field, 14 arenas for training and competition, 15 miles of trails, 25 RV hook-ups, and numerous other amenities that make it a destination for equestrians of every discipline from across the country

## Directions

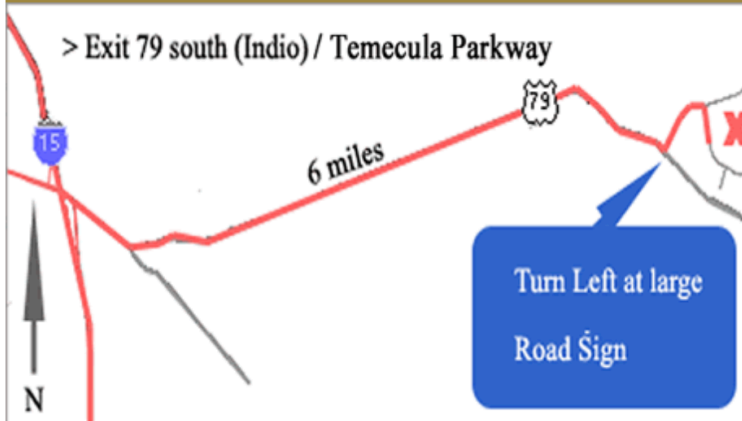

Galway Downs is located at 38801 Los Corralitos Road in Temecula, California. From I-15 take 79 South. Turn left on Los Caballos Rd, then Right on Los Corralitos.

[More Info](#)

## Directions

**Galway Downs Equestrian Center**  
38801 Los Corralitos Rd, Temecula, CA 92592

Please Note: Some GPS systems do not provide correct directions to the facility. Please refer to directions below.

### From North

Head South on Highway 15,  
Take Exit 58 toward CA-79S/Temecula Parkway,  
In 5.9 miles turn right on CA-79/Temecula Parkway,  
In 0.5 mile turn left onto Los Caballos Road,  
In 0.5 mile turn right onto Los Corralitos Road.

### From San Diego:

Head North on Highway 15,  
Take Exit 58 toward CA-79S/Temecula Parkway,  
In 5.9 miles turn right on CA-79/Temecula Parkway,  
In 0.5 mile turn left onto Los Caballos Road,  
In 0.5 mile turn right onto Los Corralitos Road.

## CLASS ENTRIES

To enter ALL Rail Classes, Ranch Riding and Dressage and Western Dressage Visit [Horse Show Time](#)

## WORKING EQUITATION ENTRIES

[Click Here to Submit Your Entry](#)

**Stall Reservation & Shavings/Feed Order:** [Click Here to Order](#)

**Vendor Application:** [Apply Here](#)

## Sponsorship Information

[Become part of the WCC Sponsorship Family Here](#)

**Lodging & Accommodation Options:** [Click Here](#)

## FEE SCHEDULE

Horse Stall	\$175 (Reservations made after March 1st \$200)
Tack Stalls	\$175
Day Stall	\$75 per day
Administrative Fee	\$75 ( Office Fee, CA Drug Fee, Photography Fee)
Haul-in / Grounds Fee	\$55 per horse / per day including schooling day
Rail Classes	\$35 per class
Working Equitation Entry Fee	\$300 All Levels / \$100 to enter 2nd show if time permits)
Late Entry Fee	\$50 per horse
Non-competing Horse Fee	\$35 per horse / per day
Returned Check	\$25
Credit Card Convenience Charge	3%
<b>Dressage Fees (In addition to above)</b>	
Dressage / Western Dressage	\$45 per class
CDS Travel Grant	\$ 3
CDS Non-member Fee*	\$25
Change Fee after closing	\$25

\*CDS Membership Form and Non-member forms available at the end of the Prize List

## FEED & SHAVINGS

Order Here <https://forms.gle/Q8Cm6T97r9EdSBGQ8>

Shavings	\$12 per bale (no outside bedding allowed)
Alfalfa	\$25 per bale
Bermuda	\$25 per bale
Teff	\$25 per bale
Orchard	\$32 per bale
Timothy	\$32 per bale

\*Feed and Shavings will be delivered to the stalls. Same day orders must be made in the show office prior to 4:00 pm. Please note that these prices may change if the supplier increases their price.

## CLASS LIST - Los Arboles Arena

<b>A/L - Andalusian / Lusitano Division</b>		<b>OTAB - Dressage Division</b>	
102	A/L - Halter Mares - All Ages	200	OTAB - Dressage Seat W/T - Open
105	A/L - Halter Stallions - All Ages	201	OTAB - Dressage Seat W/T - Amateur
107	A/L - Best Movement	202	OTAB - Dressage Seat W/T - Green Horse
502	A/L - Dressage Hack - Open	204	OTAB - Dressage Suitability - Open
503	A/L - Dressage Hack - Amateur	206	OTAB - Dressage Suitability - Amateur
505	A/L - Country English Pleasure - Open	208	OTAB - Dressage Suitability - Green Horse
507	A/L - Country English Pleasure - Amateur	209	OTAB - Dressage Suitability - \$100 Jackpot
603	A/L - English Pleasure Hunt Seat - Open	<b>OTAB - English Division</b>	
605	A/L - English Pleasure Hunt Seat - Amateur	509	OTAB - English Pleasure Hunt Seat - W/T - Open
<b>A/L &amp; Half A/L - Combined Division</b>		510	OTAB - English Pleasure - Any Seat - W/T - Open
203	A/L/ Half A/L - Dressage Suitability - Open	511	OTAB - English Pleasure - Any Seat - W/T - Amateur
205	A/L/ Half A/L - Dressage Suitability - Amateur	600	OTAB - English Pleasure - Any Seat - W/T - Green Horse
207	A/L/ Half A/L - Dressage Suitability - Green Horse	601	OTAB - English Pleasure - Any Seat - W/T - 17 & Under
<b>Half A/L Division</b>		602	OTAB - English Pleasure - Any Seat - WTC - 17 & Under
106	Half A/L - Halter Open - All Sexes - All Ages	604	OTAB - English Pleasure Hunt Seat - Open
108	Half A/L - Best Movement	606	OTAB - English Pleasure Hunt Seat - Amateur
<b>Americal Colonial Ranching Horse Division</b>		607	OTAB - English Pleasure Hunt Seat - Green Horse
304	American Colonial Ranching Horse - Working Western Rail	611	OTAB - English Pleasure - Any Seat - \$100 Jackpot
309	American Colonial Ranching Horse - Country Pleasure	504	OTAB - Show Hack - Open
409	American Colonial Ranching Horse Halter - All Ages - All Genders	506	OTAB - County English Pleasure - Open
<b>Sulphur Horse Division</b>		508	OTAB - English Pleasure Saddle Seat - Open
408	Sulphur Horse Halter - All Ages - All Sexes	<b>OTAB - English Equitation Division</b>	
<b>OTAB - In-Hand Division</b>		608	OTAB - English Equitation - Any Seat -W/T - Open
100	OTAB - Halter Weanlings - All Sexes	609	OTAB - English Equitation - Any Seat - W/T - 17 & Under
101	OTAB - Halter Mares - All Ages	610	OTAB - English Equitation - Any Seat - WTC - 17 & Under
103	OTAB - Halter Geldings - All Ages	<b>OTAB - Hunter / Jumper Division</b>	
104	OTAB - Halter Stallions - All Ages	701	OTAB - Hunter Hack
109	OTAB - Showmanship	702	OTAB - Walk / Trot Over Rails
110	OTAB - Sport Horse in Hand - All ages - All Sexes	703	OTAB - Walk / Trot / Canter Once Around
<b>OTAB - Leadline</b>		704	OTAB - Crossrails Hunter Under Saddle
708	OTAB - Leadline Pleasure - Walk Only 8 & Under - Any Seat	705	OTAB - Short/ Long Stirrup Twice Around
709	OTAB - Leadline - Equitation - Walk Only - 8 & Under - Any Seat	706	OTAB - Short / Long Stirrup Twice Around Equitation
<b>OTAB - Driving Division</b>		707	OTAB - Short / Long Stirrup Hunter Under Saddle
500	OTAB - Carriage Pleasure Driving	<b>OTAB - Western Division</b>	
<b>OTAB - Driving DivisionRanch Riding Division</b>		305	OTAB - Western Pleasure - W/J - Open
300	Ranch Trail - Open	306	OTAB - Western Pleasure - Open
301	Ranch Trail - Amateur	307	OTAB - Western Pleasure - Amateur
302	Ranch Trail - Green	308	OTAB - Western Pleasure - Green Horse
303	Ranch Trail - Youth	310	OTAB - Western Pleasure - \$100 Jackpot
400	Ranch Rail - Open	<b>Opportunity Division</b>	
401	Ranch Rail - Amateur	210	OPP - W/T or W/J - Any Seat - Any Rider
402	Ranch Rail - Green	501	OPP - Native Costume - W/T
403	Ranch Rail - Youth	700	OPP - Fantasy Costume - W/T
404	Ranch Riding - Open	800	OPP - Family Class W/T W/J
405	Ranch Riding - Amateur	801	OPP - Vintage Rider - W/T - Any Seat
406	Ranch Riding - Green	802	OPP - Walk and Favorite Gait - Amateur
407	Ranch Riding - Youth	803	OPP - Obedience - Any Seat
410	Ranch Conformation - Open	804	OPP - Wine Glass Class*
411	Ranch Conformation - Amateur	805	OPP - Pro/Am - Any Seat
412	Ranch Conformation - Youth	806	OPP - Egg & Spoon Class - Any Rider*
		807	OPP - Bareback Dollar Bill Class*
		808	OPP - Stick & Carrot Class*

# CLASS SCHEDULE - Los Arboles Arena

#	SATURDAY RING 1 - 8:00 AM	#	SUNDAY RING 1 - 8:00 AM
100	OTAB - Halter Weanlings - All Sexes	500	OTAB - Carriage Pleasure Driving
101	OTAB - Halter Mares - All Ages	501	OPP - Native Costume - W/T
102	A/L - Halter Mares - All Ages	502	A/L - Dressage Hack - Open
103	OTAB - Halter Geldings - All Ages	503	A/L - Dressage Hack - Amateur
104	OTAB - Halter Stallions - All Ages	504	OTAB - Show Hack - Open
105	A/L - Halter Stallions - All Ages	505	A/L - Country English Pleasure - Open
106	Half A/L - Halter Open - All Sexes - All Ages	506	OTAB - County English Pleasure - Open
107	A/L - Best Movement	507	A/L - Country English Pleasure - Amateur
108	Half A/L - Best Movement	508	OTAB - English Pleasure Saddle Seat - Open
109	OTAB - Showmanship	509	OTAB - English Pleasure Hunt Seat - W/T - Open
110	OTAB - Sport Horse in Hand - All ages - All Sexes	510	OTAB - English Pleasure - Any Seat - W/T - Open
		511	OTAB - English Pleasure - Any Seat - W/T - Amateur
	<b>BREAK</b>		<b>BREAK</b>
200	OTAB - Dressage Seat W/T - Open	600	OTAB - English Pleasure - Any Seat - W/T - Green Horse
201	OTAB - Dressage Seat W/T - Amateur	601	OTAB - English Pleasure - Any Seat - W/T - 17 & Under
202	OTAB - Dressage Seat W/T - Green Horse	602	OTAB - English Pleasure - Any Seat - WTC - 17 & Under
203	A/L/ Half A/L - Dressage Suitability - Open	603	A/L - English Pleasure Hunt Seat - Open
204	OTAB - Dressage Suitability - Open	604	OTAB - English Pleasure Hunt Seat - Open
205	A/L/ Half A/L - Dressage Suitability - Amateur	605	A/L - English Pleasure Hunt Seat - Amateur
206	OTAB - Dressage Suitability - Amateur	606	OTAB - English Pleasure Hunt Seat - Amateur
207	A/L/ Half A/L - Dressage Suitability - Green Horse	607	OTAB - English Pleasure Hunt Seat - Green Horse
208	OTAB - Dressage Suitability - Green Horse	608	OTAB - English Equitation - Any Seat - W/T - Open
209	OTAB - Dressage Suitability - \$100 Jackpot	609	OTAB - English Equitation - Any Seat - W/T - 17 & Under
210	OPP - W/T or W/J - Any Seat - Any Rider	610	OTAB - English Equitation - Any Seat - WTC - 17 & Under
		611	OTAB - English Pleasure - Any Seat - \$100 Jackpot
	<b>LUNCH</b>		<b>LUNCH</b>
300	Ranch Trail - Open	700	OPP - Fantasy Costume - W/T
301	Ranch Trail - Amateur	701	OTAB - Hunter Hack
302	Ranch Trail - Green	702	OTAB - Walk / Trot Over Rails
303	Ranch Trail - Youth	703	OTAB - Walk / Trot / Canter Once Around
304	American Colonial Ranching Horse - Working Western Rail	704	OTAB - Crossrails Hunter Under Saddle
305	OTAB - Western Pleasure - W/J - Open	705	OTAB - Short/ Long Stirrup Twice Around
306	OTAB - Western Pleasure - Open	706	OTAB - Short / Long Stirrup Twice Around Equitation
307	OTAB - Western Pleasure - Amateur	707	OTAB - Short / Long Stirrup Hunter Under Saddle
308	OTAB - Western Pleasure - Green Horse	708	OTAB - Leadline Pleasure - Walk Only 8 & Under - Any Seat
309	American Colonial Ranching Horse - Country Pleasure	709	OTAB - Leadline - Equitation - Walk Only - 8 & Under - Any Seat
310	OTAB - Western Pleasure - \$100 Jackpot		
	<b>BREAK</b>		<b>BREAK</b>
400	Ranch Rail - Open	800	OPP - Family Class W/T W/J
401	Ranch Rail - Amateur	801	OPP - Vintage Rider - W/T - Any Seat
402	Ranch Rail - Green	802	OPP - Walk and Favorite Gait - Amateur
403	Ranch Rail - Youth	803	OPP - Obedience - Any Seat
404	Ranch Riding - Open	804	OPP - Wine Glass Class*
405	Ranch Riding - Amateur	805	OPP - Pro/Am - Any Seat
406	Ranch Riding - Green	806	OPP - Egg & Spoon Class - Any Rider*
407	Ranch Riding - Youth	807	OPP - Bareback Dollar Bill Class*
408	Sulphur Horse Halter - All Ages - All Sexes	808	OPP - Stick & Carrot Class*
409	American Colonial Ranching Horse Halter - All Ages - All Genders		
410	Ranch Conformation - Open		
411	Ranch Conformation - Amateur		
412	Ranch Conformation - Youth		

\*Class Schedule subject to change.

Management reserves the right to split, combine, cancel or add classes.

Final Schedule to be posted at the Show Office.

# DRESSAGE CLASS LIST - Dressage Arena

## Sunday, March 20, 2022

Schedule to be posted after entries close

#	Dressage Classes	#	Western Dressage Classes
900	USDF Intro A	921	WDAA INTRO LEVEL TEST 1
901	USDF Intro B	922	WDAA INTRO LEVEL TEST 2
902	USDF Intro C	923	WDAA INTRO LEVEL TEST 3
903	USEF Training Level Test One - O, AA, J/Y	924	WDAA INTRO LEVEL TEST 4
904	USEF Training Level Test Two - O, AA, J/Y	925	WDAA BASIC LEVEL TEST 1
905	USEF Training Level Test Three* - O, AA, J/Y	926	WDAA BASIC LEVEL TEST 2
906	USEF First Level Test One - O, AA, J/Y	927	WDAA BASIC LEVEL TEST 3
907	USEF First Level Test Two - O, AA, J/Y	928	WDAA BASIC LEVEL TEST 4
908	USEF First Level Test Three* - O, AA, J/Y	929	WDAA LEVEL 1 TEST 1
909	USEF Second Level Test One - O, AA, J/Y	930	WDAA LEVEL 1 TEST 2
910	USEF Second Level Test Two - O, AA, J/Y	931	WDAA LEVEL 1 TEST 3
911	USEF Second Level Test Three* - O, AA, J/Y	932	WDAA LEVEL 1 TEST 4
912	USEF Third Level Test One - O, AA, J/Y	933	WDAA LEVEL 2 TEST 1
913	USEF Third Level Test Two - O, AA, J/Y	934	WDAA LEVEL 2 TEST 2
914	USEF Third Level Test Three* - O, AA, J/Y	935	WDAA LEVEL 2 TEST 3
915	USEF Fourth Level Test One - O, AA, J/Y	936	WDAA LEVEL 2 TEST 4
916	USEF Fourth Level Test Two - O, AA, J/Y	937	WDAA LEVEL 3 TEST 1
917	USEF Fourth Level Test Three* - O, AA, J/Y	938	WDAA LEVEL 3 TEST 2
918	USDF Freestyle TOC* (specify test – USDF TR-4th) Training level is not eligible for qualifying	939	WDAA LEVEL 3 TEST 3
919	USEF TOC * (state test – no freestyles, Young Horse, or rider tests)	940	WDAA LEVEL 3 TEST 4
920	Pas de Deux Level of Choice	941	WDAA LEVEL 4 TEST 1
956	FEI TEST OF CHOICE	942	WDAA LEVEL 4 TEST 2
		943	WDAA LEVEL 4 TEST 3
		944	WDAA LEVEL 4 TEST 4
		945	WDAA LEVEL 5 TEST 1
		946	WDAA LEVEL 5 TEST 2
		947	WDAA LEVEL 5 TEST 3
		948	WDAA LEVEL 5 TEST 4
		949	WDAA FREESTYLE TEST INTRO
		950	WDAA FREESTYLE TEST BASIC
		951	WDAA FREESTYLE TEST LEVEL 1
		952	WDAA FREESTYLE TESTS LEVEL 2
		953	WDAA FREESTYLE TESTS LEVEL 3
		954	WDAA FREESTYLE TESTS LEVEL 4
		955	WDAA FREESTYLE TESTS LEVEL 5

### ATTENTION DRESSAGE COMPETITORS

Each competitor is responsible for supplying management with correct CDS number and copy of membership card for rider and owner with entry form.

The scores of competitors who fail to supply proof CDS membership may not be counted toward CDS awards. Adult Amateurs who fail to supply proof of USEF Amateur standing by the closing date will ride in the Open division

[CDS Membership Form & CDS Non-Member Form](#)



# GENERAL INFORMATION

## All Exhibitors

**ARENA:** Footing consists of sand mixed with dirt and textile footing. Only those horses registered with the show management are permitted use of the show facilities, warm-up arena and show arena. Lunging is allowed in specific areas only and upon receiving permission of the ring steward.

**DOGS:** Dogs must be on a leash. All animals should be managed so as to not disturb the competitors.

**DRESSAGE -** Dressage rides will be limited to 55 per day. Order of receipt of entries will be determined by postmark date of entry. Post entries for dressage will only be accepted if ride times are available.

**ENTRIES:** Entries Due: MARCH 1, 2022 \*\$50 Late Fee applies if received after March 1, 2022  
Entry Fees and Stabling Fees MUST be accompanied with Entry Form. 1 Entry Form per horse

**FARRIER -** A farrier will be available on the grounds during show hours.

**FEED & BEDDING:** Pre-ordered bedding and feed will be delivered to the stall prior to arrival. During the show, additional feed and bedding may be purchased in the show office by noon each day. No guarantee of same day deliver if ordered after 12:00 pm.

**FIRE REGULATIONS PROHIBIT PARKING BETWEEN BARNES -** As soon as you unload your horse, please move your vehicle to a designated parking area. Parking in the barn area is prohibited. Vehicles in "No Parking" areas will be towed at the owner's expense. Access to the barn area during the show hours will be limited! Specific areas have been set aside for parking horse trailers and vans of exhibitors reserving stalls; other specific areas have been set aside for exhibitors showing from the trailer.

**FOOD/CONCESSIONS:** Food and beverages will be available for purchase on the Showgrounds

**GOLF CARTS:** and all other motorized vehicles require a valid driver's license to operate. Minors who do not have a valid driver's license which allows them to operate a motorized vehicle in the state in which they reside will not be permitted to operate a motorized vehicle of any kind, including, but not limited to, golf carts, motorcycles, scooters, or farm utility vehicles, on the competition grounds of licensed competitions. Minors who have a valid temporary license may operate the above described motorized vehicles as long as they are accompanied by an adult with a valid driver's license. The parent/legal guardian or individual who signs the entry blank as a parent or guardian of a minor operating a motorized vehicle in violation of this rule are solely responsible for any damages, claims, losses or actions resulting from that operation. Violations of this rule will be cause for penalties against those responsible for the child committing the offense. Wheelchairs and other mobility assistance devices for individuals with disabilities are exempt from this rule. The unsafe use of personal electronic transport devices, as determined by the competition officials and management in their sole discretion, that do not require a driver's license to operate, including but not limited to Segway, hover boards, and single wheeled scooters is prohibited on competition grounds. Operating such devices in areas where people gather may be deemed "unsafe use" if there is a risk of harm to others. If the operator of the device is a minor, the parent/legal guardian or individual who signs the entry blank as a parent or guardian of a minor operating the device in violation of this rule is accountable and may be subject to penalties. Wheelchairs and other mobility assistance devices for individuals with disabilities are exempt from this rule.

**INDEMNITY AND NON-RESPONSIBILITY CLAUSES -** All entries are accepted with the understanding that the Wine Country Classic Horse Show and Galway Downs will not be held responsible for any loss, damage or injury to any horse exhibited, or any article of any kind. All horses shall be under the control and direction of the Show Management but solely at the risk of the exhibitor, who will be responsible for any loss, damage or injury to any person, animal or property occasioned by him, his agents or employees, or by an animal owned or exhibited by him, and shall indemnify Wine Country Classic Horse Show and Galway Downs against any and all loss, damages and liability thus occasioned, including but not limited to any and all legal costs, including attorney fees, which may be incurred as a result thereof.

The submitting of an entry form to the Show Secretary shall constitute an acceptance by each person signing same of the revisions herein set forth.

**PARKING: NO PARKING IN THE BARN AISLES BY ORDER OF THE FIRE MARSHALL.** Day parking and trailer parking is on the right after entering the big open area. Please do not park trailers up close to the arena. RV parking adjacent to the tented center aisle barns east of the oval arenas.

**PAYMENT POLICY:**

Payment for stalls must accompany the completed Entry Form and paid upon receipt of invoice. Open Checks and Credit Card submittals will be deposited upon receipts so that the appropriate stalls and classes may be reserved. Even if entry is paid in full, an open check or credit card must be given to the show secretary before exhibitor numbers will be issued.

Make checks payable to

“Wine Country Classic Horse Show” 30116 Happy Hunter Drive, Canyon Lake, CA. 92587

PayPal: WineCountryClassicHorseShow@gmail.com

Zelle: WineCountryClassicHorseShow@gmail.com

Credit Cards will be charged 3% service fee

**CANCELLATION, SUBSTITUTION OR REFUND OF ENTRIES** - To encourage early entries, the management agrees to cancel and refund all fees for any horse not fit to show provided written notice is given to the Show Secretary on or before the close of entries. After the closing date, a partial refund of entry fees and/or stall fees are subject to Management’s decision and may be considered for any horse suffering from illness or injury upon the presentation to the Show Secretary PRIOR to the start of the show, by a written request for a refund from the exhibitor and a veterinarian’s certificate. No refunds will be considered for requests received after the start of the show.

**RETURNED CHECKS / CREDIT CARD DENIAL:** Checks returned for NSF or credit card payments that are denied will be charged \$50 per occurrence.

**PROPERTY DAMAGE:** All owners and exhibitors will. Be held responsible for any damage occurred by them, their agents or employees to stalls, building and other property on the show grounds and shall be billed accordingly.

**SCHOOLING HORSES:** Horses not entered in the show must be registered with the Horse Show office and will be given a number to be worn at all times when not in a stall or tied to a trailer. Appropriate stall or grounds fees and a \$35.00 per day fee must be paid. Any person(s) riding a schooling horse must have signed an official entry blank. A schooling horse may be allowed in the warm-up arena at the discretion of the ring steward.

**SHOW STATUS:** In the event of inclement weather, natural or other disasters prior to the show, it is the competitor’s responsibility to contact management as to the show status.

**STABLING INFORMATION:**

**STABLING ASSIGNMENTS: NO STALLS WILL BE RESERVED WITHOUT PRE-PAYMENT IN FULL**

Assignment of stalls is entirely at the discretion of the Barn & Show Manager. Horses must be placed in stalls assigned and no changes will be permitted without the express consent of the Barn Manager. Assignments will be made as fairly as possible on the basis of many considerations, including sponsorship support, number of horses, past participation in this show, optimum use and convenience, show decor, time of receipt of entries, ring use, number of classes entered and access considerations. We ask your cooperation in these assignments and once assignments have been made, please do not deviate without specific approval of the Barn Manager. Exhibitors wishing to be stabled together should submit their entries in the same envelope. Please indicate on the entry form (stable with line) any special requests. Assignments will be made on early-entry, first-assigned basis. Management will try to stable late entries as closely as possible to other entries, but there are no guarantees. Show management’s decision is final.

Arrival: no earlier than 10:00 am on Friday, March 18, 2022. Early Arrival / Late Departure: Is available only with Management permission @ \$50 per day.

**STALLS:** Stabling is a mix of permanent 12'x12' cinder block construction stalls with Dutch Doors, temporary 10'x10" wood stalls with Dutch Doors and 10"x13" vinyl and steel construction stalls with half doors. Stabling for the permanent stalls is on a first come, first served bases for premium sponsorships. No automatic waters. Water spigots are located in each barn aisle. Water buckets and hoses must be provided by the competitor. Stabling is for the show weekend. No initial bedding is provided and must be purchased on entry form. No straw is permitted and only shavings may be used fo bedding. When not stabling, a haul-in fee of \$50 per day must be paid. This includes Thursday if you haul in to practice. Night time arrivals bring lights to unload. Competitors are responsible for stall damage.

**STALL CLEANING:** Deposit manure in designated area and not in the barn aisle

**SMOKING IS PROHIBITED IN STABLING AREAS**

**VETERINARIAN**

A veterinarian will be on call during the show. All animals are subject to physical inspection by the Show Veterinarian at the discretion of the Show Management.

**Terms:**

**Green Horse:** Is open to horses in their first season of showing and includes all gaits. Trainers may show in the class. Riders and horses may cross enter between walk/trot and walk/trot/canter/lope Green Horse classes.

**OTAB:** Open To All Breeds

**A/L:** Andalusian / Lusitano

**ACRH:** American Colonia Ranching Horse Breeds: To include Spanish Barbs, BLM Mustangs, America's First Horse, Kiger Mustang, Morgan, Sulphur Horse.

**Ribbons:** To be awarded 1st - 5th.

**High Point Programs** to include: Ranch Riding Overall, Andalusian / Lusitano Division, Walk / Trot Division, Youth Division, Amateur Division, Green Horse Division, Hunter / Jumper Division, Open Division.

**Leadline:** Leadline Rider/Horse Combination must only enter Leadline classes.

## **RULES**

1. EVERY CLASS OFFERED HEREIN WHICH IS COVERED BY THE RULES AND SPECIFICATIONS OF THE CURRENT USEF RULE BOOK WILL BE CONDUCTED AND JUDGED IN ACCORDANCE THEREWITH. <https://www.usef.org/forms-pubs/PiZ5Mms1FY8/usef-rulebook>. However, the WCCHS Rules supersede when necessary.
2. All questions not covered in these rules and regulations shall be decided by the show management whose decision shall be final.
3. Every horse entered for competition will comply with the rules of the horse how management, but management will, in no case, be responsible for any loss or damage that may occur, and it shall be condition of entry that each exhibitor shall hold this horse show and the officials and employees of the show blameless for any loss or accident to his horse, employees, equipment, which may occur from sickness, fire or otherwise.
4. The management reserves the right to refuse, accept conditionally, or to cancel any entries, disqualify any riders or exhibitors, prohibit entries and cancel award prizes without claims for damages; to cancel or

combine unfilled classes, or to reschedule classes after due notice to exhibitors; to change rings or rotate judges.

5. Exhibitors are notified that any act of discourtesy or disobedience to the judges or officials, on the part of the owner, manager, rider, or groom shall disqualify the horse, and the owner shall forfeit his entry fee and other fees.

6. Show management reserves to itself the power to prohibit any person from attending or showing a horse in the ring and to remove any groom or horse from the show without being liable for compensation.

7. In accordance with the 1989 Federal Waste Tracking Act, which restricts the disposal of medical waste, bio-hazardous medical waste containers will be provided. All exhibitors and their agents are responsible for the proper disposal of this waste.

8. No person will be allowed in the show ring during the time of judging except the exhibitor and those having official or requested duties to perform.

9. It is the tradition of the show that riders be correctly attired for the class in question, that attendants be neatly dressed and the horses properly presented. Management may in its discretion bar any person from entering the ring if not suitably presented to appear before an audience.



## Entry Agreement

By entering this Competition and signing this entry blank as the Owner, Lessee, Trainer, Manager, Agent, Coach, Driver, Rider, Handler, Vaultor or Longeur and on behalf of myself and my principals, representatives, employees and agents, I agree that I am subject to the Rules of USEF, California Dressage Society and the local rules of the Competition. I agree to release and hold harmless the competition, CDS, their officials, directors and employees for any action taken under the Rules. I represent that I am eligible to enter and/or participate under the Rules, and every horse I am entering is eligible as entered.

I also agree that as a condition of and in consideration of acceptance of entry, USEF and/or the Competition may use or assign photographs, videos, audios, cable - casts, broadcasts, internet, film, new media or other likenesses of me and my horse taken during the course of the competition for the promotion, coverage or benefit of the competition, sport, or the Federation. Those likenesses shall not be used to advertise a product and they may not be used in such a way as to jeopardize amateur status. I hereby expressly and irrevocably waive and release any rights in connection with such use, including any claim to compensation, invasion of privacy, right of publicity, or to misappropriation.

### Release, Assumption of Risk, Waiver, and Indemnification This document waives important legal rights. Read it carefully before signing.

I AGREE in consideration for my participation in this Competition WINE COUNTRY CLASSIC to the following:

I AGREE that CDS and the "Competition" as used herein includes the Competition Management, as well as all of their officials, officers, directors, employees, agents, personnel, volunteers and Federation affiliates.

I AGREE that I choose to participate voluntarily in the Competition with my horse, as a rider, lessee, owner, agent, trainer, or as parent or guardian of a junior exhibitor. I am fully aware and acknowledge that horse sports and the Competition involve inherent dangerous risks of accident, loss, and serious bodily injury including broken bones, head injuries, trauma, pain, suffering, or death.

I AGREE to hold harmless and release USEF, CDS and the Competition from all claims for money damages or otherwise for any Harm to me or my horse and for any Harm of any nature caused by me or my horse to others, even if the Harm arises or results, directly or indirectly, from the negligence of the Federation or the Competition.

I AGREE to expressly assume all risks of Harm to me or my horse, including Harm resulting from the negligence of the Federation or the Competition.

I AGREE to indemnify (that is, to pay any losses, damages, or costs incurred by) the Federation and the Competition and to hold them harmless with respect to claims for Harm to me or my horse, and for claims made by others for any Harm caused by me or my horse while at the Competition. I have read the Federation Rules about protective equipment, including GR801 and, if applicable, EY114, and I understand that I am entitled to wear protective equipment without penalty, and I acknowledge that the Federation strongly encourages me to do so while WARNING that no protective equipment can guard against all injuries. If I am a parent or guardian of a junior exhibitor, I consent to the child's participation and AGREE to all of the above provisions and AGREE to assume all of the obligations of this Release on the child's behalf I represent that I have the requisite training, coaching and abilities to safely compete in this competition.

I AGREE that if I am injured at this competition, the medical personnel treating my injuries may provide information on my injury and treatment on the official USEF accident/injury report form.

**BY SIGNING BELOW, I AGREE to be bound by all applicable Rules and all terms and provisions of this entry blank and all terms and provisions of this Prize List. If I am signing and submitting this Agreement electronically, I acknowledge that my electronic signature shall have the same validity, force and effect as if I affixed my signature by my own hand.**

SIGN ALL THREE LINES, EVEN IF SAME PERSON - MANDATORY

RIDER / DRIVER / HANDLER

1. Signature \_\_\_\_\_

Print Name \_\_\_\_\_

OWNER / AGENT

2. Signature \_\_\_\_\_

Print Name \_\_\_\_\_

TRAINER: Adult on grounds with responsibility for the horse

3. Signature \_\_\_\_\_

Print Name \_\_\_\_\_

### EMERGENCY

CONTACT PHONE

NUMBER

MANDATORY

SIGN IF APPLICABLE

COACH Signature \_\_\_\_\_

Print Name \_\_\_\_\_

PARENT / GUARDIAN

Signature \_\_\_\_\_

Required if Rider/Handler is a minor

Print Name \_\_\_\_\_

## 2021 CDS MEMBERSHIP FORM



Active Membership .....\$75.00  
Additional Family Member..... \$65.00  
Life Membership .....\$1,500.00

[www.california-dressage.org](http://www.california-dressage.org) to join online

Name \_\_\_\_\_

Address \_\_\_\_\_

City \_\_\_\_\_

State \_\_\_\_\_ Zip \_\_\_\_\_

Telephone (\_\_\_\_\_) \_\_\_\_\_

Email \_\_\_\_\_

Chapter Preference \_\_\_\_\_

*Would you like to use your Visa or MC? (5% fee added)*

Card # \_\_\_\_\_

Exp Date \_\_\_\_\_ V code \_\_\_\_\_  visa  mastercard

Signature \_\_\_\_\_

Group membership in the United States Dressage Federation (USDF) (\$20) included with CDS membership. All CDS memberships go from December to December. Anyone joining after October 1 will be a member for the following year.

Please check any of the following that apply:

- Renewing Member  New Member  Amateur  
 Instructor/Trainer  Junior Rider ( / / )  Judge \_\_\_\_\_  
 T.D.  EMT  Qualified Riding Member (QRM)  
 Nominate for Regional Adult Amateur Competition (add \$25)

**CALIFORNIA DRESSAGE SOCIETY**  
P O Box 417 • Carmel Valley, CA 93924  
**831/659-5696 • (fax) 831-659-2383**

## CDS Non-Member Form

If you are competing at this show and do not have a current CDS membership, please fill out this non-member form completely for CDS. CDS offers many qualifying opportunities and year end awards and would like you to be eligible for them. ***The Rider and the Owner must be a CDS member for any scores to count.***

Please provide your name and information and answer a few questions about why you are not a CDS member at this time. Return this to the show manager so they may submit it with the show results.



Name \_\_\_\_\_

Address \_\_\_\_\_

City \_\_\_\_\_

State \_\_\_\_\_ Zip \_\_\_\_\_

Phone (\_\_\_\_) \_\_\_\_\_ Email Address (required) \_\_\_\_\_

I am a member but don't have my card or member number

I am not a CDS member at this time as I live out of the area

I am not a CDS member at this time as I only compete at a few shows

I would like to become a CDS member (mail a copy of this form with a check for \$70 to address below)

Remember joining CDS includes a Group Membership with USDF, saving you money!



California Dressage Society  
P O Box 417 • Carmel Valley, CA 93924  
(831) 659-5696 fax (831) 659-2383  
paula@california-dressage.org  
www.california-dressage.org