

SUBNIN

2022



ARABIAN & HALF-ARABIAN CHAMPIONSHIP SHOWS





AHA Nationals

GENERAL RULES FOR NATIONAL SHOWS

CONTACT INFO

Arabian Horse Association

10805 East Bethany Drive
Aurora, CO 80014-2605
(303) 696-4500 phone
(303) 696-4599 fax
NationalEvents@ArabianHorses.org
www.ArabianHorses.org

AHA OFFICERS

Deborah Johnson President
Lisa Blackstone Vice President
Larry Jerome Vice President At-Large
Peter Conway Vice President At-Large
Dave Corning Treasurer
Jan Decker Secretary
Nancy Harvey Immediate Past President

AHA DIRECTORS

Kathy Callahan-Smith Region 1
Nancy Goertzen Region 2
Gretchen McDaniel Region 3
Julie Hedden Region 4
Carrie Olson Region 5
Nancy Rohde Region 6
Marilou Balloun Region 7
John Simmons Region 8
Mark Himmel Region 9
Mary Smith Region 10
Ryan Chambers Region 11
Laurie Ann Salmi Region 12
Ann Knopp Region 13
Jeff Caldwell Region 14
Cricket Gates Region 15
Cheryl Lane-Caron Region 16
Carla Jackson Region 17
Janet Henderson Region 18
Bruce Johnson Director At-Large
TBA Director At-Large
TBA Director At-Large
TBA Director At-Large

JUDGES & STEWARDS

SELECTION COMMITTEE

Mary Jane Brown Judges & Stewards Commissioner
Matt Kwapich, Chair New Mexico
Robert Obermiller, Vice Chair South Carolina
Ann I Knopp Michigan
Judie Mitten Arizona
Carl Malicote South Carolina

*Grey highlight indicates changes for 2022

JUDGES

The Judges & Stewards Commissioner is responsible for handling written and signed complaints relating to the judges', stewards', and other show officials' conduct when filed by exhibitors, show officials, AHA members or others, and when accompanied by a ten dollar (\$10) filing fee. (Res. 5-90) Other comments, compliments, questions, inquiries are encouraged when appropriate (no filing fee required). Write to: AHA, Judges & Stewards Commissioner, 10805 E Bethany Dr., Aurora, CO 80014-2605; call 303-696-4539 or fax to 303-696-7878.

EVENT NUMBERS

These shows are recognized by the
Arabian Horse Association

Youth & Mid Summer Nationals #15601
Canadian Nationals #15602
Sport Horse Nationals #15604
U.S. Nationals #15605

Regular Member United States Equestrian Federation
Arabian Division and Recognized by Equestrian Canada.

Youth & Mid Summer Nationals 7318
Canadian Nationals Silver Level
22093
Sport Horse Nationals 317471
U.S. Nationals 206

AHA STAFF

Executive Director

R. Stanton Morey (303) 696-4551
Stan.Morey@ArabianHorses.org

Director of Marketing & National Events

Kelsey Berglund (720) 648-9220
Kelsey.Berglund@ArabianHorses.org

Event Coordinator

Lindsey Phipps (303) 696-4553
Lindsey.Phipps@ArabianHorses.org

Event Coordinator

Paige Lockard (303) 696-4535
Paige.Lockard@arabianhorses.org

National Show Secretary

Marlene Kriegbaum (303) 696-4501
Marlene.Kriegbaum@ArabianHorses.org

Senior Director of Competitions

Leslie Lockard (303) 696-4521
Leslie.Lockard@ArabianHorses.org

Graphic Designer

Liz Bilotta (303) 696-4517
Elizabeth.Bilotta@ArabianHorses.org

EVERY CLASS OFFERED HEREIN WHICH IS COVERED BY THE RULES AND SPECIFICATIONS OF THE CURRENT USEF/ EC RULE BOOK WILL BE CONDUCTED AND JUDGED IN ACCORDANCE THEREWITH.

ANY CHANGES OR CORRECTIONS AFTER THE PUBLICATION OF THE OMNIBUS FOR ANY RULES WILL AUTOMATICALLY BECOME PART OF THIS PRIZE LIST AND WILL APPEAR ON THE AHA WEBSITE (WWW.ARBANHORSES.ORG).

The Youth & Mid Summer Nationals, Sport Horse Nationals and U.S. Nationals are conducted in accordance with the rules of the United States Equestrian Federation (USEF), and Canadian Nationals is conducted in accordance with the rules of Equestrian Canada (EC). The official rulebook of each organization will prevail for all shows, particularly the Arabian, Half-Arabian and Anglo-Arabian Horse Division and the rules of the Arabian Horse Association.

Every participant in each show is responsible for knowledge of these rules and is subject to these rules. The Show Commissions reserve the right to make changes to what is listed in the omnibus at any time.

For assistance, please call the AHA office at (303) 696-4500 (option #4), or fax at (303) 696-4599, Monday through Friday, 8:00 AM to 5:00 PM (Mountain Time), or e-mail us at NationalEvents@ArabianHorses.org.

GR 1 AHA INDEMNITY & NON-RESPONSIBILITY CLAUSES

All entries are accepted with the understanding that the Arabian Horse Association and State Fair Park, World Equestrian Center and Tulsa Expo Square, their officers, officials, and employees will not be held responsible for any loss, damage, or injury to any exhibitor, his or her agent or employee, or to any horse or any article of any kind. The exhibitor will be responsible for any loss, damage, or injury to any person, animal, or property occasioned by him/her, his/her agents or employees, or by any animal owned or exhibited by him/her, and shall indemnify the Arabian Horse Association and State Fair Park, World Equestrian Center, Tulsa Expo Square and Keystone Centre, against any and all loss, damages and liability thus occasioned, including, but not limited to any and all legal costs, including attorney fees, which may be incurred as a result. The submitting of any official entry form to the show secretary shall constitute an acceptance of these provisions by each person or agent signing the entry form.

GR 2 ADMISSION TO THE RING & CONTROLLED Paddock PROCEDURE

No person will be permitted to enter the ring except participants in the class, judges, their assistants and show officials. Attendants and grooms may enter the ring only when summoned by order of the judges. Attendants and grooms who enter the ring shall be considered a part of the showing team and must be neatly dressed in proper show attire, wearing unmarked dusters at all times when they are in the ring.

Only standard grooming equipment will be allowed in this area. There will be no whips, noise makers or other such equipment, devices or objects in the in-gate area which might disturb or create a hazard to horses or handlers except a show whip carried properly by a handler.

1. FOR PERFORMANCE CLASSES

At the discretion of Show Management, order of entry into the ring may be predetermined for any class.

A maximum of two grooms and one handler per horse will be allowed at the in-gate area.

2. FOR IN-HAND CLASSES

In all breeding classes, the order of go will be determined and posted by birth date of the horse from oldest to youngest. Entries will enter in the order as posted and will be inspected for signs of abuse by the Show Steward immediately prior to entrance into the ring for judging. The manner of inspection will be at the discretion of Show Management.

3. CONTROLLED Paddock

The one specified person assisting with entrance of in-hand horses into the ring will be allowed to use only the same length whip and appendages as are currently allowed for the individual handling the horse. Rule reference AR114.2: Whips are to be no longer than 6' including snapper/lash/appendage. Small appendages (no more than 12 inches in length) of ribbon, plastic, etc. are permitted.

The designated person **will not hit or use any other objects, such as trash cans, walls, etc., to make any noise.**

In addition, **effective immediately**, the use of plastic or paper bags of any type or size is prohibited in assisting with entrance(s) into the arena.

It is the responsibility of Show Management, along with the USEF Steward(s) to ensure the "designated person" understands this policy and their role.

Should this rule/policy be violated, a warning card may be issued to both the handler and the designated person or groom who initiates this violation.

**Grey highlight indicates changes for 2022*



GR 3 ARABIAN BREEDERS SWEEPSTAKES CLASSES (ABS)

All Horses entering into Arabian Breeders Sweepstakes (ABS) classes must be Sweepstakes nominated either as a Breeding entry (BE) or an Original Entry (OE).

Yearlings must be Breeding Entries (BE).

A horse that is co-owned by two distinct non family members per USEF AR110.e. 1 – 10 cannot be shown in the ABS AAOTR/AOTR Jackpot Classes, ABS AAOTH

Performance Halter Classes, USN Performance Futurity/Maturity/Derby Classes and the SHN Performance Maturity Classes.

See each show for more detailed information relating to ABS classes held at those shows.

ARABIAN BREEDERS SWEEPSTAKES PRIZE MONEY

Classes that are eligible for Sweepstakes prize money are designated in the class list and in the time schedule.

Sweepstakes Prize Money is available in designated Sweepstakes classes for horses placing in these classes which are Sweepstakes Nominated as a Breeding Entry or Original Entry and are eligible for prize money.

The 50% rule is in effect for all designated Sweepstakes classes, with the exception of the ABS Yearling classes, ABS Green Working Hunter Derby, ABS Dressage Prospect Incentive, the ABS AAOTR/AOTR Jackpot Classes and the ABS AAOTH Performance Halter Classes.

The Sweepstakes Commission reserves the right to pay the dollar amounts printed in the online version of the AHA Handbook in the event the incorrect dollar amount is announced or presented in center ring.

Any and all disputes which arise regarding the Sweepstakes program will be presented to the Sweepstakes Commission for resolution and their determination will be final.

GR 4 AMATEUR OWNER

*****A horse that is co-owned by two distinct non family members per USEF AR110.e. 1 – 10 cannot be shown in the ABS AAOTR/AOTR Jackpot Classes, ABS AAOTH Performance Halter Classes or Performance Maturity AAOTR Classes at any National Show.**

It is unethical to transfer or assist or facilitate in the transfer of a horse with the intent to circumvent the purpose of the rules regarding ownership of horses shown in the amateur owner and/or junior owner classes. It is unethical for any AHA member to not provide information relating to the transfer in question that is requested by the Probable Cause Panel or the Ethical Practice Review Board.

In determining whether the transfer was unethical, the EPRB may consider, among others, the following:

Horse ending up back in the previous owner's name within a year of the original transfer.

Horse being transferred at less than fair market value (owner to provide proof of the sales amount).

The fact that prize money went to a person other than the owner or family member.

The fact that the owner or family member did not pay the expenses relating to the upkeep and showing of the horse.

GR 5 AWARDS

Top Ten Awards will be made regardless of the number of competing entries. However, only awards made to the top 50% (rounded up not to exceed 10 awards) will receive AHA Horse Achievement Award Points, Amateur Achievement Award Points, High Point Horse Achievement Award points, and High Point Amateur Achievement Award points.

Types of awards are as follows: trophy and championship ribbon to the National Champion; trophy and reserve championship ribbon to the Reserve National Champion; plaques and ribbons for the remainder of the Top Ten for Youth, Canadian, Sport Horse, and U.S. Nationals and Neck ribbons for Mid Summer Nationals.

Champion and Reserve Champion will NOT receive Top Ten Plaques. Champion and Reserve Champion may purchase a plaque if they wish to do so in the Awards Room.

All horses qualifying for the semi-finals will receive a ribbon from Preliminary sections (I,II,III) . In addition, all horses in A/B and SF Sections advancing to the SFF or FNL, section ribbons will be awarded.

All awards not claimed by the close of the show will be forfeited with no exceptions. No awards will be mailed.

AWARDS CEREMONY

The number of people other than authorized personnel for award photographs for the Championship and Reserve Championship awards at all the Nationals Shows will be determined by each National Show Commission.

AWARDS/SPECIAL

The National Show Commissions will determine if individual prizes and awards will be presented at the National Shows. AHA is not liable for payment of donated prize money paid by an outside organization. Exhibitors are instructed to contact the individual donors to complete any necessary paperwork.

Sponsored/Special awards (are to be considered separate from the Arabian Horse Association's prize list for a national event. Therefore, Arabian and Half-Arabian

**Grey highlight indicates changes for 2022*

Nationals and the Arabian Horse Association are not liable for providing or presenting any award (printed or otherwise) if a sponsor cancels or is unable to provide the agreed upon awards. These awards are subject to change.

GR 6 BEDDING/SHAVINGS

Shavings and feed are available for purchase on the show grounds. Outside shaving deliveries are not allowed to the show grounds.

GR 7 CANCELLATION OR DATE CHANGE OF SHOW

Show Management reserves the right to change the dates and/or the location of the show or to cancel the show altogether. In the event of a cancellation, all entry fees and stall fees will be refunded upon request. (Office fees are non-refundable.) Neither the Show Management nor AHA shall have any liability to any exhibitor, owner, handler or other person, firm or corporation by reason of any change or cancellation of the show, except for the return of the aforementioned fees.

GR 8 CLASS INFORMATION

A class is composed of all its sections including Preliminaries (I,II,III) , Eliminations (A,B,C), Semi-Finals/ Finals (SF/F), Semi Finals -1st Go (SF), and Finals - 2nd/last Go (FNL).

Many National classes are divided into sections depending on the number of entries. Please check with the Show Office regarding if a class has sections and which section you have been assigned. If you miss YOUR SECTION, you have missed YOUR CLASS and will not be allowed to advance further. This policy will be strictly enforced.

1. ADDING CLASSES

Additional class entries must be submitted on the Official Entry Form for each show. Please check the box indicating this is not a new horse but added classes for a horse already entered.

2. CANCELLATION OF CLASSES

The AHA Convention has established a minimum of three (3) entries for all National classes. The Show Commissions may cancel any class with fewer than three entries.

3. CLASS CALLS

- The two-minute limit for gate closing will be strictly enforced. The gate will close two minutes after the first horse enters the ring or in cases with large classes taking more than two minutes, after the entry of the final horse in a continuous string of horses.
- Due to unforeseeable problems with any mechanical device, the public address system and

paddock calls over that system must be considered a courtesy.

- It is the responsibility of the exhibitor to be sure that his/her horse is at the gate at the prescribed time. Every effort will be made to maintain a working public address system to carry class calls; however, no protest will be upheld, nor will any section be changed on the basis of public address malfunction alone.

4. CLASS PROCEDURES

- Riders in Reining, Trail, Working Cow, Cutting, Dressage, Working Hunter, Jumper, Sport Horse In-Hand, Ranch Riding and Obstacle Driving classes may show more than one horse in the class.
- In all other classes, a horse may be shown in a class (including sections) by only one rider and only one horse per rider.

5. CLASS SCRATCHES & NO SHOWS

PLEASE refer to the fee chart for each show for late scratch fees.

All Scratches MUST be recorded by the Show Secretary and must be made at least **TWO HOURS** prior to the session the class is to be considered official .

At the show, scratches can be done either via the app, web site or in person at the show.

NO SCRATCHES WILL BE ACCEPTED BY PHONE.

A fine will be assessed to any exhibitor who fails to properly notify of any scratch.

Exception: official scratches filled out at the gate.

Exhibitors who scratch at the gate and do not fill out a scratch form with the gate person will be charged either the failure to scratch fee or the no show fee.

6. CLASS SECTIONS

If you have multiple classes the same day, it is strongly advised to look closely at the schedule and request a section that will work best for your situation. Many sections have been split up in order to aid in conflicts.

a. SECTIONS REQUESTS

Sections can be requested up to noon 2 days prior to the section running. i.e. if sections are to run Wednesday, request may be submitted up to noon on Monday and sections will be posted Tuesday by Noon.

If a section is not specified, then random entry selection will be used for assigning sections.

If you miss **YOUR SECTION**, you have missed **YOUR CLASS** and will not be allowed to advance further. This policy will be strictly enforced.

**Grey highlight indicates changes for 2022*



Exhibitors with possible ring conflicts, should identify section requests on the Official Entry Form. Once at the show, sections and go forward sections can be requested **via the AHA App, website or in person at the show office**. All requests **MUST** be submitted BY NOON the day prior to when the sections are to be posted.

Example: if the class is Tuesday, sections will be posted Monday, section requests must be in by noon Sunday.

- b. **GO FORWARD** section requests (from elimination sections I, II, III sections to A,B sections) will **ONLY** be accepted **AFTER** you make the cut. It must be submitted within **1 hour AFTER** the completion of the elimination section.
- c. **ONCE A CLASS HAS BEEN SECTIONED**
Requests for section or working order changes must **be handled in the show office** as follows:
 - i. If an exhibitor has a conflict between scheduled classes, the exhibitor must request the change in section or working order **at least two sessions** prior to the earliest class involved. This change must be requested on the official Section Change Form and be filed with the Show Secretary in the Show Office.
 - ii. Show Management reviews all requests for changes and their rulings are final. Exhibitors must return to the Show Office to determine if their request for change has been granted and must sign the request form indicating they are aware of the action taken relative to their request.
 - iii. If Show Management creates a conflict with an exhibitor's scheduled class, due to a time change or other adjustment, a section or work order assignment may be changed by Show Management to resolve the conflict. In such case, every effort will be made by the Show Office to notify the exhibitor involved of the section/work order change.

7. CLASS/HORSE SUBSTITUTIONS

Substitutions will follow USEF/EC rules. If the owner wishes to use another horse to replace the deceased, sold or injured horse, substitutions may be made after the announced date of the closing of entries and will be handled as follows:

- a. The Office and the Scoring fee must be paid for the substitute horse, all other fees are transferable.
- b. A copy of the veterinary letter and/or a copy of

notification of death or sale (to the appropriate registry) regarding the death or sale of the horse must be provided with the substitution horse's entry. For an injury the Vet certificate should give a detailed description of the injury.

- c. The classes must be the same type and rider age breaks or level.
- d. Additional classes may be entered for which the new horse is qualified. Post entry rules apply.

8. POST ENTRIES

Please refer to each individual show's rules for dates and post fees for horses and added classes. Post entries may not be listed in the program and may not be stalled with horses from the same barn

9. RIDER/HANDLER/EQUITATION HORSE CHANGES

Any changes to the originally entered rider, driver, handler or equitation horse must be recorded with the Show Secretary least **TWO HOURS** before the session in which the change is made.

Changes can be done on the AHA App, web site or in person at the show office. Once a class section has run, rider/driver/handler changes for advancing sections are not allowed except for a medical emergency per USEF rules. Please make sure the correct rider is listed for your classes.

Failure to do so will result in a fine. Refer to Fee Chart for each show.

10. REFUNDS

- a. All refunds will be processed after the conclusion of the show.
- b. Cancellations prior to the initial close will be refunded all but the Office fee regardless of the reason. All other refunds will be considered upon receipt of a suitable Veterinarian/Doctors certificate attesting to illness or injury, along with a letter from the exhibitor explaining the circumstances.

All fees, except the office fees, will be refunded with a veterinarian certificate received at the AHA office no later than 30 days prior to the first day of the show.

Only the class entry fees, 9-90 fee, USEF fees, EC fees will be refunded, with a veterinarian certificate postmarked between 30 days and 15 days prior to the first day of the show.

No fees will be refunded for requests received at the AHA office between 14 day and the completion of the show.

Exception – AHA Halter Futurity (FUT 102) and Performance Futurity and Maturity Program fees (PERF 107)

- c. **Entries paid with a Credit card will be refunded**

**Grey highlight indicates changes for 2022*

to the Credit Card used for that entry. Entries paid by check will be refunded by check to the person who cut the check.

- d. In the case of a deceased horse, a copy of the veterinary letter and/or a copy of notification of death (to the appropriate registry) is required before a refund will be made for all fees with the exception of the office fee which will be retained by AHA.
- e. All fees paid for classes cancelled by Show Management shall be refunded in full.
- f. Class entry fees will be refunded for all non-qualified classes only. All qualified horses/riders entered in a class including classes where cross entry is not permitted will not be refunded.

GR 9 CONTROLLED PADDOCK PROCEDURE

Since the controlled paddock was first instituted, the use of large plastic bags and other items has escalated well beyond what is necessary to assist our in-hand horses into the arena. Additionally, we have erred by not clearly stating how this one specified person appointed by either

the show committee or the exhibitor is to go about assisting with entrance(s) into the arena. It is well past time for us to establish these parameters and we ask for the support of all our owners and spectators in understanding that these parameters are for the welfare of our horses and our breed. These parameters will also help remove some of the negativity expressed regarding the current practices of how our in-hand horses are presented to the judges and to the public.

The one specified person assisting with entrance of in-hand horses into the ring will be allowed to use only the same length whip and appendages as are currently allowed for the individual handling the horse. Rule reference AR 114.2: Whips are to be no longer than 6' including snapper/lash/appendage. Small appendages (no more than 12 inches in length) of ribbon, plastic, etc. are permitted.

The designated person will not hit or use any other objects, such as trash cans, walls, etc., to make any noise.

In addition, effective immediately, the use of plastic or paper bags of any type or size is prohibited in assisting with entrance(s) into the arena.

It is the responsibility of Show Management, along with

DISTANCE HORSE NATIONAL CHAMPIONSHIPS
HOSTED BY THE ARABIAN HORSE ASSOCIATION

• **September 30 - October 2, 2022**
• **Gooding, ID**
• **Autumn Sun Pioneer Ride**
www.ArabianHorses.org/dnl

RIDE WITH US!

• **OPEN AHA / AERC / 25, 50 & 100 MILE RIDES**
• **BREED NATIONAL CHAMPIONSHIPS & LD CHALLENGE**

Logos at the bottom include: Arabian Horse Association, Distance Horse Nationals, Paso Fino, American Quarter Horse, American Saddlebred, and Arabian Horse Association.



the USEF Steward(s) to ensure the “designated person” understands this policy and their role.

Should this rule/policy be violated, a warning card may be issued to both the handler and the designated person or groom who initiates this violation

GR 10 COVID & HEALTH PROTOCOLS

Exhibitors are advised that All AHA National Shows will follow the current guidelines put in place in accordance with the recommendations of the CDC, WHO, USEF and AHA in regard to social distancing and public health that are in place at the time of each National Show. Please check the AHA web site for updates.

GR 11 DISCIPLINE

Exhibitors are advised that any act of discourtesy or disobedience to the officials of this show on the part of the owner, lessee, trainer, groom, rider, driver, handler or member of the family of the person participating in the show will disqualify the horse from adjudication. The management reserves the right to remove any horse, owner, lessee, trainer, groom, rider, driver, handler, or member of the family of the person participating in the show from the show grounds without being liable for compensation of damages.

Any action(s) against a horse which are deemed excessive by a Judge, Steward or Show Veterinarian, in the show ring or anywhere on the competition grounds, may be punished by official warning, elimination, or other sanctions which may be deemed appropriate by the Commissions or the Judges & Stewards Commissioner. Such action(s) could include, but are not limited to, excessive use of whip, spurs, or bamboo poles. It is a violation of USEF and Equestrian Canada rules to commit any act or make remarks during the show that are considered offensive or made with the intent to influence or cast aspersions on the judging. (Refer to the current USEF and Equestrian Canada Rule Books).

GR 12 DISPUTE NOT COVERED BY RULES

Should any question or dispute arise not provided for in the governing rules of USEF or AHA, the question or dispute shall be referred to the Show Committee, whose decision will be final.

GR 13 DISQUALIFICATION

Refer to current USEF and Equestrian Canada Rule Books. For clarification on how a disqualified horse is replaced, refer to the current AHA Handbook.

GR 14 DNA TESTING

The Arabian Horse Association reserves the right to do

DNA testing at ANY National Show by collecting hair samples (or blood sample, if necessary) from Arabian, Half-Arabian or Anglo-Arabian horses. Samples will be collected under the overall supervision of the Registry Services Department. Any questionable results will go through the standard investigation process of that department. Prize money may be withheld pending the outcome of questionable results. All Half-Arabians competing in the Halter Futurity and Performance Futurity/Maturity/Derby must have DNA type on file of the horse and horse's purebred Arabian Parent placed on permanent record with the AHA Registry and the horse has been shown to qualify as an offspring of the purebred sire or purebred dam. *DNA must be on file with the AHA office before the horse will be eligible to compete in these classes.*

GR 15 DOGS & OTHER PETS/ANIMALS

No dogs will be allowed in the main arena or paddock area with the exception of Companion/Guide Dogs, and in accordance with USEF Rules. Dogs are not permitted to be loose on competition grounds and must be on a leash or otherwise contained. Individuals must not lead dogs on a leash while mounted. Dog owners are solely responsible for any damages, claims, losses or actions resulting from their dogs' behaviors.

Dog owners failing to comply with this rule may be subject to penalty under USEF Chapters 6 and 7, as well as issuance of warning cards. The Show Management further reserves the right to fine any exhibitor or farm whose dog is running loose and has to be confined by show officials. The first offense will be up to \$50.00. The second offense will be up to \$100.00 and expulsion of the animal from the show grounds.

No animal other than horses, dogs or cats are allowed on the show grounds without the express written consent of the National Show Commission. No animals other than horses shall be allowed on the grounds for the purpose of being sold.

GR 16 DRUG TESTING, SHOE & HOOF MEASURING

Complimentary hoof measurements will NOT be provided by USEF/EC Stewards at any National Show.

It is the prerogative of Show Management to require drug testing or to require the inspection of shoes, pads and/or hoof length for any entry at any time during the show. This is to be accomplished prior to the horse leaving a prearranged inspection area. All horses competing in the Arabian, Half-Arabian and Anglo-Arabian Hunter, Jumper, Dressage, Eventing, Combined Driving, Pleasure (Carriage) Driving, Working Western, and Sport Horse Sections are exempt from shoeing regulations. This does not exempt horses that are cross entered into any other

classes from compliance with applicable shoeing requirements while competing in those classes. See USEF Rulebook for current shoeing and toe length regulations.

Per resolution #24-04, mandatory drug testing will take place at the U.S. and Canadian Nationals. Horses will be picked at random.

GR 17 DUPLICATE TROPHIES

Duplicate Awards may be ordered any time for any National Show. See each show office for details. All prices include shipping and handling. Forms may be picked up at the Awards Room. After the Event contact AHA at (303) 696-4500 (#4), or e-mail NationalEvents@ArabianHorses.org for more information.

GR 18 EMERGENCY CONTACT

AHA and the Show Commissioners advise owners and/or trainers to leave your contact information of where you can be reached for the duration your horse(s) are on grounds for the National Show with either the barn manager and/or on a card on the stall door.

GR 19 EXHIBITOR ENTRY INFORMATION

All AHA Official Forms can be found on the AHA website for each show under Exhibitor Information.

Exhibitors are advised to use a form of expedited, traceable mail service when sending entries in order to ensure that their entries are received.

AHA will accept faxed/emailed entries with a valid credit card. However we strongly discourage faxed entries. Photos of an entry form will not be accepted. Photos and Faxed Copies are often illegible.

DO NOT SUBMIT AN ENTRY BY MORE THAN ONE METHOD AS CREDIT CARDS MAY BE CHARGED MULTIPLE TIMES.

All entries made by the closing date will be acknowledged by email to the person signing as trainer unless otherwise noted on the entry form or via the online entry system. Due to the large volume of entries, receipt of entries can not be verified by phone or fax. If confirmation is not received two weeks prior to the first day of the show, please contact AHA immediately.

METERED MAIL Will only be accepted with *an official postmark from country of origin that indicates the location and date the Postal Service accepted custody of a mail piece, and it cancels affixed postage.*

FULL PAYEMENT

Please do not split any charges for an entry between exhibitors, horses or stables.

All entries must be paid in full when entry is submitted and payments are processed upon receipt. If payment

is not received after the closing date the entry will be subject to the post entry fee. Fees are in US funds.

Checks and credit cards covering multiple entries need to be accompanied by a detailed description of how the money is to be applied listing all the horses & total fees on a per horse and a contact phone number.

Canadian/International exhibitors must draw checks from a U.S. funds account or preprinted with "U.S. Funds". Writing "Payable in U.S. Funds" on the check is NOT acceptable.

Credit cards will be charged only for the Entry Total amount listed on the entry blank. If you leave the Total amount blank, your card will be charged the amount that AHA totals your entry for.

NOTE: Issuing a "bad check" is a criminal offense. Payment made with a returned instrument will be handled in accordance with the current AHA Handbook SUS 101.

Any open checks sent with entries will be made out for the amount of the entry and deposited. NO Post Dated checks will be accepted.

Due to AHA policy, payment information in any format via email or attachment is not advised. To ensure secure delivery of private information, please CALL (303-696-4500 option 4) OR FAX (303-696-4599) all payment information. Please list detailed information on what show and horse(s) it is for.

ENTERING FOR HORSES AND RIDERS NOT QUALIFIED BY THE CLOSING DATE

Horses and riders that are not qualified as of the closing date but intend to qualify before the start of the National Show they are entering **MUST** enter and pay the fee. A Qualification report signed by the show secretary from the qualifying show **Must** be submitted before a non-qualified class will be qualified when you pick up your back numbers.

Failure to qualify for any one class will result in a refund for that class.

1. ENTRY REFUSAL

The Show Management reserves the right to refuse, accept conditionally, or to cancel any entries of any exhibitor, as stated in the current USEF or Equestrian Canada Rule Books and current AHA Handbook.

Management reserves the right to deny entry into the ring to any unruly horse or one whose actions threatens to endanger the rider, driver, handler or other exhibitors or entries.

2. INVALID ENTRIES

The following will be considered as an invalid entry and

**Grey highlight indicates changes for 2022*



subject to late or post entry fees;

- a. **UNREGISTERED HORSES.** All Horses must have a certificate of registration when entering any National Show. **Entries for pending registrations will be held until the registration is complete. A post entry fee will be charged if the registration is NOT completed by the closing date of the show.** See each show for further information.
- b. Checks or credit cards for a lesser amount than owed.
- c. NSF checks, Credit cards that are declined will be charged the current AHA NSF fee (see the AHA Handbook SUS 101.3). If Full payment is not received by the closing deadline or within 7 days of notification of the NSF, the entry may be subject to additional fees.

3. ONLINE ENTRIES

- a. Online entry is available for all National shows. When the online entry system is ready, an email news flash will be sent. If AHA does not have a current USEF/EC membership on file for you, you may enter "N/A"; however, you must send AHA a copy of all those USEF/EC membership cards. Please include which show and horse it is for.
- b. If you have problems entering a horse jointly owned online, please call AHA to link that joint ownership. Once linked, you will be able to enter online.
- c. Once your online entry is complete, an email from the AHA shopping cart will be sent confirming your entry and payment. If you did not get an email, PLEASE call AHA to confirm your entry.
- d. For group stalling for entries completed online, please fill out the Official Stable Request Form listing all the owners and horses. Please only one form per group. See each show for deadlines for when group stall requests must be in to the AHA office.

4. WHERE TO MAIL, EMAIL OR FAX ENTRIES

Email to: NationalEvents@ArabianHorses.org
with the show name in the subject line

Fax to: 303-696-4599
(Please include a cover sheet)

Mail to: Attn. (Name of National Show)
10805 East Bethany Drive
Aurora, CO 80014

EMAILED ENTRIES

Please contact AHA if you do NOT get a return email

acknowledging the receipt of your entry on the same or next business day.

5. ENTRY FORM MUST BE COMPLETE

PLEASE TYPE OR PRINT CLEARLY. Entries not complete may be returned. If the returned entry form is still not complete and is received by the closing date, it will be considered a post entry. Please see each show for the amount of the post entry fee.

Entry form is completed with the following;

1. The complete and correct name and address of the registered owner. Owner is defined as the recorded owner as listed on the registration papers. Owners may be listed in the name of a stable or farm only if, the stable or farm is the bona fide owner appearing on the horse's papers, or the stable or farm has been registered with USEF and the number shown on the USEF certificate is noted in the "USEF Farm #" space provided on the entry blank. For entry into any Owner class(es) a USEF Farm Certificate is required and must be sent with the entries.
2. The complete horse information.
3. The complete rider information for all riders.
4. The complete name (must be an adult) and address of the trainer. If there is no trainer, then the owner for the horse at the show must fill out the trainer information.
5. Entry Forms are signed in at least 3 places. The Owner, Trainer, and Rider signature lines must be signed. All signatures must be from an adult (18 or older).
 - i. If there is no trainer the owner must sign the trainer line.
 - ii. In addition, Coaches (if applicable) must sign the entry blank.
 - iii. A parent signing for minor need not be a USEF/EC or AHA member, however they must write "Parent" next to their name.
 - iv. If applicable, the Minor Exhibitor Consent to Show section must be filled in and signed.

6. INCLUDE WITH YOUR ENTRY

- a. **PHOTOCOPIES of all registration papers.** If the name shown on the registration papers is different from the person entering the horse, an affidavit, a copy of the sales contract or authorization form is required. Photocopies of signed transfer are not proof of ownership. In owner classes, Contracts of Sale or Bill of Sale will not be acceptable as proof of ownership.

Do not submit your health papers, coggins or vaccinations records with your entries. Keep

**Grey highlight indicates changes for 2022*

the certificates in your possession until such time as it is requested. You may be required to show health papers and proof of a negative Coggins test prior to being allowed to unload horses.

- b. **PHOTOCOPIES of Membership Cards** for USEF/ EC for every Owner, Trainer, Rider, Driver, Handler and Coach (if applicable).

WDAA (Western Dressage Association of America) for every Owner, Trainer, Rider, Driver, Handler and Coach if applicable are required for Youth & Sport Horse Nationals) if you are in any Western Dressage class.

USEF/EC Amateur Cards for all individuals riding in Adult Amateur classes. Proof of USEF/ EC membership must accompany your entry or you must pay the USEF Show Pass Fee or the EC Temporary Sport License. You can also join USEF/ EC /WDAA at the show. ***Each participant over the age of 18 must have completed Safe Sport.***

- c. **UPHA** membership cards for UPHA riders and trainers.
- d. **STALL REQUEST FORM** – see each show for the deadline for group stalling requests. Please submit only one form per group to be stabled together. Forms received after the due date on the form may not be honored. Please check each show and form for the due date for that show. All horses that are not entered into the show (non-competing) must be listed on the stall form.

7. EXHIBITOR CHECK IN & PACKET PICK UP AT THE SHOW

Check each show for the show office hours.

All exhibitors/barns are encouraged to make appointments for check in as soon as you know your arrival date. You can Email NationalEvents@ArabianHorses.org or call 303-696-4500 option #4 to schedule your check in appointment.

Current Covid social distancing procedures will be followed, the show office capacity will be limited to one person per actively staffed front desk.

8. EXHIBITOR SHOW ACCOUNTS

All exhibitors will be required to leave an open check or credit card, separate from their entries at check-in, before show numbers will be released, to cover early arrival, additional stalls, fines or penalties incurred at the show.

All open accounts must be closed before the closing of the Show Office before 5 PM on the last day of the show. Exhibitors are encouraged to close out their account in person. If the exhibitor does not close out

their account they automatically authorize Management to close their account using the Check or Credit card on file and may assessed a Failure to Close Out fee of \$100 and disputes in billing will NOT be considered.

GR 20 EXHIBITOR PARTIES/ALCOHOL

AHA/Show Management will not tolerate illegal activities including any underage drinking, substance abuse, or providing illegal substances to minors on the show grounds. Parents are responsible for their children. Consequences will include removal from the grounds and authorities will be contacted. Alcoholic beverages may only be purchased through the facility authorized concessionaire/liquor license holder. No other alcoholic beverages may be brought onto the grounds, and liquor may be confiscated. Please contact the individual facilities for more information.

GR 21 EQUINE HEALTH & VACCINATION REQUIREMENTS

Please refer to USEF GR 845

Please check with the state veterinarians of all states you are planning on passing through regarding possible restrictions due to current health related problems and outbreaks. It is the exhibitor's responsibility to be aware of any additional restrictions that may be in place at the time of crossing state/country boundaries.

A valid health certificate is required for every horse. All horses six months and older must be accompanied by an official health certificate of state of origin issued by a state, federal or licensed accredited veterinarian, and such certificate must include a veterinarian's statement that examination was made within the past thirty (30) days. Each horse must have a negative Coggins test, dated within a year of the showing date.

Do not submit any Health or Vaccination Certificates with your entries. Keep the certificates in your possession until such time as it is requested. You may be required to show health papers and proof of a negative Coggins test prior to being allowed to unload horses.

1. VACCINATION REQUIREMENTS

- a. At Federation licensed competitions, horses entering the grounds must be accompanied by documentation of Equine Influenza Virus and Equine Herpes Virus (Rhinopneumonitis) vaccinations within six months prior to entering the stables. Horses not in compliance with this rule may be required to leave the competition grounds upon request by Competition Management. Documentation should consist of one of the following methods mentioned below. The frequency

**Grey highlight indicates changes for 2022*



of vaccine administration should be per the vaccine manufacturers' or veterinarian's recommendations. It is recommended that vaccines are administered by or under the direction of a veterinarian.

- b. In the case of vaccines administered by a veterinarian, the exhibitor, upon request by Competition Management, must provide documentation from the veterinarian on documenting that the horse in question received the vaccinations, name of the vaccines and date of vaccine administration.
- c. In the case of vaccines administered by a person other than a veterinarian, the exhibitor, upon request by Competition Management, must provide a receipt of the vaccine purchase which is signed by the owner, or agent with care, custody, and control of the horse; name, serial number and expiration date of the vaccine; and date of vaccine administration.
- d. In the case of a horse that is unable to receive either of the vaccinations due to a history of adverse reactions, the exhibitor, upon request by Competition Management, must provide a letter from the veterinarian on official letterhead stating that the horse in question cannot be vaccinated due to medical concerns and a log of temperatures taken twice daily for the seven days prior to entering the competition grounds. These horses must also have their temperature taken and logged twice daily while on the competition grounds. The log of temperatures should be provided to the Competition Management, steward, or technical delegate when requested.

2. HEALTH CERTIFICATE REQUIREMENTS

A valid health certificate is required for every horse. All horses six months and older must be accompanied by an official health certificate of state of origin issued by a state, federal or licensed accredited veterinarian, and such certificate must include a veterinarian's statement that examination was made within the past thirty (30) days and revealed the animal to be free from symptoms of any infectious disease or exposure thereto. Each horse must have a negative Coggins test, dated within a year of the showing date.

3. HEALTH CERTIFICATE REQUIREMENTS FOR NATIONALS SHOWS IN CANADA

Health certificate Requirements— ENTERING the U.S.A. All horses require a negative Coggins test, dated and signed by the Health of Animals Veterinarian, within 6 months of entry to the U.S.A.

All horses require a health certificate, signed by your

veterinarian and a Health of Animals Veterinarian within 30 days of entering the U.S.A. The certificate must state that the horse is free of contagious diseases.

Foals that are less than 5 months old and accompanied by the mare, require no testing to enter the U.S.A.

All horses must be accompanied by a document indicating proof of ownership. If the horse is registered, a photocopy of the original registration papers must be carried with the horse.

If Canadian horses are entering the U.S.A. for breeding or sales purposes, a formal entry must be made. This is done through a customs broker at the U.S.A. Port of Entry. There is a fee charged for this service.

Canadian show and rodeo horses entering the U.S.A. temporarily are required to fill out a form at the Port of Entry. This may be done by the owner or agent.

An American horse in Canada for 72 hours or less can re-enter the U.S.A. with an American Health Certificate.

American horses participating in a public recognized show can return to the U.S.A. on the American Health Certificate for up to 90 days, if the owner supplies proof of attending rodeos, horse shows, or race meets. This means you must have a published show program identifying your horse as a competitor in the show.

All horses must submit to inspection when entering the U.S.A. If a Canadian horse is sold to an American buyer, the seller must file an export entry form at the Canadian port prior to leaving Canada.

Some American states have permit regulations, so check with state agricultural authorities to obtain a permit prior to entering the state. In many cases, this can be obtained via telephone.

GR 22 FARRIER PERMIT & REGISTRATION

An official Show Farrier will be available on the grounds. No other farrier will be permitted to work on the grounds without registering with the Show Office. Exhibitors wishing to use their private farrier must have the farrier apply at the Show Office and pay a registration fee before they can work on the show grounds (Refer to Fee Chart).

GR 23 FIRE MARSHALL REGULATIONS & SAFETY CODES/ STALL DECORATIONS

- All electrical extension cords must be at least 14 gauge of the three-wire type. AUTHORIZED ELECTRICAL APPLIANCES FOR GROOMING PURPOSES MAY BE USED IN DESIGNATED BARN AREAS ONLY. No unauthorized electrical appliances may be used, and if used, the appliances will be confiscated.

**Grey highlight indicates changes for 2022*

- THE ELECTRICAL SYSTEM MAY NOT BE ALTERED OR TAMPERED WITH UNDER ANY CIRCUMSTANCES.
- Exhibitor stalls may have the stall walls covered with nonflammable material only. Proof of flame retardant material must be verified. Please have certification of flame retardant material.
- Only stalls for tack storage, entertainment or resting can be covered on the top, and will require a working smoke detector.
- Absolutely no overhead draping of horse stalls is permitted.
- Absolutely no covering or concealment is permitted over or around a private work or exercise area in your stabling area.
- Decoration of stalls: exterior stall decorations, indoor or outdoor, shall not extend more than three (3) feet from the base of the structure unless otherwise allowed in writing by the particular national show management. Movable objects such as chairs can be out another two (2) feet. Fire extinguishers must be provided by the exhibitor. There must be one (1) extinguisher for each two (2) stalls that are covered with nonflammable materials. No aisle ways may be covered overhead. Sleeping areas are to be equipped with a smoke detector and fire extinguisher.
- No gas, electric or propane heaters, tanks or hot plates allowed in the stalls or stall area at any time. No exposed element heating appliances such as immersion heaters nor open flames are allowed.
- NO SMOKING is permitted in any arenas or barns.
- Parking is not allowed in any fire lanes.
- Combustible trash must be removed at least once a day.
- All manure and used shavings removed from stalls or trailers must be placed in areas specified by the facility and may NOT be placed in garbage cans.

- Any vehicle, truck or trailer, within the fenced area of the barn/tent area, or not obeying NO PARKING or FIRE LANE signs in other parts of the grounds will be towed and impounded at the owner's expense.
- Absolutely no overhead draping of horse stalls is permitted.
- STALL DAMAGE: DO NOT PUT NAILS INTO STALL WALLS. Stalls must be vacated in their original condition. STALLS MAY NOT BE STRUCTURALLY ALTERED IN ANY WAY.
- Exhibitors will be financially responsible for any alteration/damage to their stalls on the premises.

GR 24 **HANDICAPPED & ELECTRONIC COMMUNICATION DEVICES**

1. Electronic communication devices used for purposes of coaching exhibitors during a competition are prohibited in all classes in the Arabian Division. Exhibitors with a permanent hearing impairment are permitted to use an electronic communication device upon submission of a written certification from a treating medical professional's office certifying the permanent hearing impairment and certifying the requirement of an electronic communication device. The medical certification must be provided to the competition Steward within a reasonable time prior to competing who shall attach a copy to the Steward report.
2. Individuals must include their USEF Dispensation Certificate with entries if requiring special adaptations. See USEF and Equestrian Canada Rule Books.

An exhibitor with a disability (other than hearing) will be provided reasonable accommodation upon submission of a written certification from a treating medical professional's office certifying the disability and identifying the accommodation necessary for the exhibitor to compete safely. The medical certification must be provided to the competition Steward within a reasonable time prior to competing who shall attach a copy to the Steward report.



ATTENTION EXHIBITORS!

REMEMBER TO PICK UP YOUR AWARDS

**Grey highlight indicates changes for 2022*



AHA Nationals

GENERAL RULES FOR NATIONAL SHOWS

GR 25 IN-KIND SPONSORSHIP/ PRODUCT DONATIONS

Companies may distribute giveaways through the purchase of a commercial exhibit booth space in the Shopping Expo. AHA Corporate Partners and contracted Event Sponsors may provide premiums, products or cash (in the form of added prize money) to exhibitors only through the prior approval of AHA Show Management. All ring presentations must also have prior approval of AHA Show Management.

GR 26 INSURANCE ADVISORY

Due to the number and quality of horses at the National Shows, we urge each exhibitor to verify their liability insurance coverage and their livestock mortality coverage with their own insurance carrier.

GR 27 LEVELED CLASSES SELECT, CHOICE & ELITE CLASSES

If a competitor is eligible to compete as a Select/Choice/Elite Rider in a section on December 1, 2021, said eligibility remains throughout the current competition year.

ACHIEVEMENT LEVEL RIDERS

MAY level up to a higher level (USEF AR110.2.g), but rider may only ride 1 level on the same horse. i.e. A Choice Western Pleasure rider may level up to Western Pleasure Elite, but can't ride both Choice & Elite Western Pleasure.

Cross entry is permitted into any class in the same section provided qualification are met.

A section is defined as a particular seat or discipline.
(BOD 8/21) **Examples:**

- Western – Western Pleasure, **Western Riding**
- Hunter Seat – Hunter Pleasure
- Reining – Reining
- Western Trail – Western Trail
- English Trail – English Trail
- Saddle Seat – Park, English, Country English, Show Hack.
- Western Horsemanship/Equitation
- Hunter Seat Equitation Not to Jump
- Reining Seat Equitation
- Saddle Seat Equitation
- Showmanship

GR 28 MEMBERSHIP

1. AHA (Arabian Horse Association)

Each competitor (this includes at least one recorded

owner and all trainers, drivers, riders, halter handlers, coaches and the person(s) signing the entry blank) in an Arabian Horse Association recognized Arabian division, must have a valid AHA **business membership, a competition level card or join AHA.**

Single event membership is not acceptable at AHA Regional or National competitions.

Exhibitors in walk-trot classes must have an AHA membership with competition card at AHA competitions.

Exhibitors in the Experience YNL classes must have an AHA membership but it does not need to be a competition level membership.

Exhibitors in lead line classes or parents/guardians signing for minors are exempt from AHA membership requirements.

Any farm, business or corporation owning and/or showing a horse must be a Business Member of AHA.

2. WDAA (Western Dressage Association of America)

To be eligible to participate and/or compete as an exhibitor, owner, lessee, agent, coach, or trainer in any Western Dressage class or at any Western Dressage Federation Licensed Competition persons must be active members of WDAA or pay a non-member fee equal to the price of an annual membership for each competition. Lessees are considered owners in connection with this membership requirement. In the event of an entry under multiple ownership, only one owner need be a Member or pay a non-member fee. The competition is responsible for listing either the active member or the owner that paid the non-member fee in the results. The competitions will be responsible for forwarding a list of the names of individuals who pay non-member fees at the competition to WDAA with the post competition report. Payment of non-member fees for the purpose of competing does not entitle the individual to any privileges of the WDAA membership.

3. USEF (United States Equestrian Federation) FOR ALL OWNERS, TRAINERS & COMPETITORS 18 & OVER

Each participant over the age of 18 must have completed and have a current Safe Sport certificate.

Each participant must submit a valid USEF COMPETING membership card or pay the USEF Show Pass Fee of \$45.00. Amateur exhibitors must have an Amateur card. Exception: Exhibitors in Walk-Trot & Leadline Classes or Parents or Guardian signing for minors. Junior Exhibitors are automatically considered Amateurs. USEF "Non-Competing" Members must also pay the Show Pass Fee

For USEF memberships, contact information is www.usef.org or 859-258-2472.

**Grey highlight indicates changes for 2022*

Life, senior active and junior active members shall be eligible to participate in all classes at Regular Competitions, Eventing Competitions at the Preliminary Level or above and Combined Driving Competitions at the Advanced Level, Dressage, Reining and Vaulting Competitions and Endurance Rides. A nonmember may participate as a handler, rider, driver, owner, lessee, agent, coach or trainer at Regular Competitions, Eventing Competitions, Dressage Competitions, Reining Competitions and Combined Driving Competitions upon payment of a \$45 Show Pass fee. Participants in the following classes are exempted from the Requirements of this rule: 1) leadline; 2) exhibitions; 3) games and races; 4) classes for 4-H members; 5) walk trot (**exception:** Friesian performance FR222) and academy classes (academy classes are classes limited to horses used regularly in a lesson program); 6) USDF introductory level tests, pas de deux and quadrille classes; 7) NRHA Endorsed Reining Competitions. 8) Opportunity classes, 9) citizens of other nations who have proof, in English, of current membership in good standing of their own National Federation, 10) USEA beginner novice division; and 11) assistant handlers in Dressage Sport Horse Breeding classes.

FARM/BUSINESS OWNERS

1. If your horse shows under the ownership of a farm or other business entity, the farm or other business entity must be recorded and active with USEF or you must pay a Show Pass fee to participate in a USEF licensed competition.
Safe Sport for the business entity, the farm or other business entity is not required.
2. If you have paid a Show Pass fee and provided your email address to the competition, the competition will supply this information to USEF. Upon receipt by USEF, you will receive by email an opportunity to credit your \$45 Show Pass fee towards a USEF annual or lifetime Farm or Business entity recording.
3. This offer will be valid from the date that the Individual or Business recording application is received by USEF. By taking advantage of this option, all future points will count.
4. You may choose not to record your Farm or Business entity and continue to pay the requisite Show Pass fee. Under this option, you are not eligible for USEF points, awards, etc.

4. EC (Equestrian Canada)

For EC membership rules please refer to the EC Rule Book General Rules Article A202 – A209. For an EC membership card, contact EC at www.equestrian.ca or (613) 248-3433.

GR 29 UNITED STATES EQUESTRIAN FEDERATION ENTRY AGREEMENT

I have read the United States Equestrian Federation, Inc. (the "Federation") Entry Agreement (GR 906.4) as printed in the Prize List for the shows listed in this Omnibus (Youth Nationals, Sport Horse Nationals and U.S. Nationals Competitions) and agree to all its provisions. I understand that by entering any of these Competitions, I am subject to Federation Rules, the Prize List, and local rules of the competition. I agree to waive the right to the use of my photos from the competition and agree that any actions against the Federation must be brought in New York State.

FEDERATION ENTRY AGREEMENT By entering a Federation-licensed Competition and signing this entry blank as the Owner, Lessee, Trainer, Manager, Agent, Coach, Driver, Rider, Handler, Vaultor or Longeur and on behalf of myself and my principals, representatives, employees and agents, I agree that I am subject to the Bylaws and Rules of The United States Equestrian Federation, Inc. (the "Federation") and the local rules of AHA National Championship competitions.

I agree to be bound by the Bylaws and Rules of the Federation and the competition. I will accept as final the decision of the Hearing Committee on any question arising under the Rules, and agree to release and hold harmless the competition, the Federation, their officials, directors and employees for any action taken under the Rules.

I represent that I am eligible to enter and/or participate under the rules, and every horse I am entering is eligible as entered.

I also agree that as a condition of and in consideration of acceptance of entry, the Federation and/or the competition may use or assign photographs, videos, audios, cablecasts, or other likenesses of me and my horse taken during the course of the competition for the promotion, coverage or benefit of the competition, sport, or the Federation. Those likenesses shall not be used to advertise a product and they may not be used in such a way as to jeopardize amateur status. I hereby expressly and irrevocably waive and release any rights in connection with such use, including any claim to compensation, invasion of privacy, right of publicity, or to misappropriation.

The construction and application of Federation rules are governed by the State of New York, and any action instituted against the Federation must be filed in New York State. See GR908.4

GR 30 MOTORIZED VEHICLES

Minors who do not have a valid driver's license which allows them to operate a motorized vehicle in the state

**Grey highlight indicates changes for 2022*



in which they reside will not be permitted to operate a motorized vehicle of any kind, including, but not limited to, golf carts, motorcycles, scooters, or farm utility vehicles, on the competition grounds of licensed competitions. Minors who have a valid temporary license may operate the above described motorized vehicles as long as they are accompanied by an adult with a valid driver's license. The parent/legal guardian or individual who signs the entry blank as a parent or guardian of a minor operating a motorized vehicle in violation of this rule are solely responsible for any damages, claims, losses or actions resulting from that operation. Violations of this rule will be cause for penalties against those responsible for the child committing the offense. Wheelchairs and other mobility assistance devices for individuals with disabilities are exempt from this rule.

The unsafe use of personal electronic transport devices, as determined by the competition officials and management in their sole discretion, that do not require a driver's license to operate, including but not limited to segways, hover boards, and single wheeled scooters is prohibited on competition grounds. Operating such devices in areas where people gather may be deemed "unsafe use" if there is a risk of harm to others. If the operator of the device is a minor, the parent/legal guardian or individual who signs the entry blank as a parent or guardian of a minor operating the device in violation of this rule is accountable and may be subject to penalties. Wheelchairs and other mobility assistance devices for individuals with disabilities are exempt from this rule.

The show security for the duration of the show will impound any motorized vehicle that is operated in an unsafe or hazardous manner or parked in a restricted area.

Please drive golf carts responsibly, horses have the right of away.

GR 31 NON-COMPETING HORSE

A Non-competing horses must;

1. Pay for a stall (per availability), Office fee and a \$100 fee per horse. Please check with each show for the total fee.
2. Fill out the official entry form and check the box on the top of the entry form for "Non Showing"
3. Sign the back of the entry form in all mandatory places.
4. Send Full payment with the completed entry form.
5. Be listed on Stabling Request form

A non-competing horse that ultimately enters the show will be considered a Post Entry and must be submitted by the final closing date.

There will be a \$750.00 fine per horse for not filing an official entry form with the show office.

GR 32 PATRONSHIPS

National shows have patron programs with various benefits including preferred stalling, class sponsorship, seating and patron's lounge benefits.

Patron seniority is based on the number of consecutive years a barn/trainer/individual has been Nationals Patron. Stalling assignments will be done based off Patron seniority and when Patronship forms are received. Any year a Patronship is missed will result in the Patron losing their seniority. In order to retain seniority, Patrons must be current every year. The National Show Commissions reserves the right to review special case requests regarding seniority, and their decision will be final. Each special case will be evaluated on its own facts and circumstances.

See the individual Patron sponsorship available on the AHA website for each National Show for specific benefit and cost information and deadlines. Patronship fees are listed on the patron form for each show, and should be mailed separate from the Official Entry Form.

Any requests to change status in a Patronship, including cancellations, MUST be emailed to NationalEvents@ArabianHorses.org.

All patrons who elect to use a golf cart will be held responsible for their own cart. Should their cart be damaged or stolen, the patron will be required to replace or repair the golf cart directly through the chosen golf cart vendor.

The submission of a signed Patron form constitutes an agreement by the signing party for a payment for Patronship After the entry closing date, any cancelled patronship is refundable by 50% if paid in full. If only minimum payment was made and patronship is not paid in full by date stated on form, no money will be refunded. Prior to entry closing date, patron fees may be refunded less the non-refundable deposit. After the entry closing date, patronships may still be available. Please contact AHA National Events Sales for more information.

Patronships are encouraged to be submitted before the deadline to ensure availability, seating and stalling priority.

1. PASSING DOWN PATRONSHIPS

A patron who has maintained a Patronship seniority that is retiring may elect to pass their Patronship on to an immediate family member. The family member receiving the seniority will be required to maintain the Patronship payments annually. Additionally, in order to keep the original stabling area, the family member may not exceed the number of stalls required by the original patron. To confirm the transfer of a Patronship, an email to the barn manager will be required. *If a farm associated with a*

patronship is being retired, the trainer has the right to continue the patronship and maintain the seniority.

2. PATRON STABLING

Patron stalling is assigned prior to any non-Patrons. Priority for Patron stalling assignments will be based on the number of continuous years as a Patron, the prior year's stalling location, and number of stalls needed.

Only the named person/stable on the Patronship is allowed to hang one set of drapes that identify the Patron farm/stable. Piggybacking (stall with) will not be allowed. Patron farms/stables allowing other farms/stables/trainers to piggyback with them who are not patrons run the risk of being moved to other less desirable areas of stalling.

The entry blank (or electronic entry) must be signed by the trainer listed on the Patronship in order for the exhibitor to be stabled with said patron.

Farms, stables or trainers wishing to stall with other farms/stables in the patron stalling area must purchase a separate patronship in order to hang identifying drapes.

PATRON STABLING PROCEDURES

1. The transferring of a patronship to a non-immediate family member will not be allowed.
2. 80% of the stalls must be in the Patron's barn (for 49 stalls and under). For those with 50 Stalls or over, 90% of the stalls must be in the Patron's Barn.
3. If that 80%/90% is exceeded, then a new patronship will be immediately charged to the patron on record.
4. Barns with over 100 stalls may not be stalled together. Every attempt will be made to keep stalls as close in proximity as feasibly possible.
5. For Patrons that exceed their average number of stalls (over the last three years), the overflow may be in another location.
6. Only one set of drapes with signage representing the patron on record may be displayed.
7. A stabling form for each National Show will be used that lists horse, owner and trainer. The form should include a statement to refer to patron stabling rules for priority stabling procedures in the omnibus.
8. If necessary, a show commission can limit the number of tack stalls should be in the general rules for all shows.
9. Every effort will be made to stable non-patron groups together that have accurately filled out their stabling request form.
10. Patron stabling will be based first on historical location and secondly on patron seniority. If a patron wishes to move to another patron barn, they will be placed on a waiting list for that barn.

3. HORSE STALLS TO TACK STALLS ALLOWED

Tack stalls will be assigned subject to their availability. Exhibitors will be allowed to order as many tack stalls as they believe they will need, however, management reserves the right to limit the number of tack stalls due to availability.

| | |
|--|--------------------|
| 10 Horse Stalls & Under | 6 Tack Stalls |
| 11 to 15 Horse Stalls | 8 Tack Stalls |
| 16 to 20 Horse Stalls | 11 Tacks Stalls xd |
| 21 to 25 Horse Stalls | 14 Tack Stalls |
| 26 to 30 Horse Stalls | 16 Tack Stalls |
| 31 to 35 Horse Stalls | 18 Tack Stalls |
| 36 to 40 Horse Stalls | 20 Tack Stalls |
| 41 to 46 Horse Stalls | 22 Tack Stalls |
| 46 to 50 Horse Stalls | 24 Tack Stalls |
| 51 to 55 Horse Stalls | 26 Tack Stalls |
| 56 to 60 Horse Stalls | 28 Tack Stalls |
| 61 to 65 Horse Stalls | 30 Tack Stalls |
| 66 to 70 Horse Stalls | 32 Tack Stalls |
| 71 to 75 Horse Stalls | 34 Tack Stalls |
| 76 to 80 Horse Stalls | 36 Tack Stalls |
| 81 to 85 Horse Stalls | 38 Tack Stalls |
| 86 to 90 Horse Stalls | 40 Tack Stalls |
| 91 to 95 Horse Stalls | 42 Tack Stalls |
| 96 to 100 Horse Stalls | 44 Tack Stalls |
| Over 100 horse you get 1 additional tack stall for every 5 horses. | |

GR 33 PHOTOGRAPHS

Anyone who attends any national show automatically grants AHA permission to publish photos taken by AHA photographers and/or staff in which they and/or their horses appear. No written release is required for AHA to publish these photos for its promotional purposes.

GR 34 PHOTOGRAPHY POLICY

The Arabian Horse Association forbids any pictures taken for the use of paid commercial distribution through websites, social media or other outlets. Professional Photographers or videographers, as defined by individuals who have or will have images for sale, are not permitted to photograph or video without written permission by the Arabian Horse Association. No photographers other than the official photographer may take pictures in the ring or from the rail. Professional photography equipment, cameras with lenses longer than 4 inches, will not be permitted except for credentialed media and those holding press passes (to take pictures outside the ring only). Additionally, watermarked photography will be

**Grey highlight indicates changes for 2022*



AHA Nationals

GENERAL RULES FOR NATIONAL SHOWS

considered professional photography and will not be allowed to be posted on any media outlets by any photographers other than AHA or the official photographer.

Media credentials may be issued to credentialed journalists, photographers and videographers from recognized non-equine industry magazines, newspapers, and publications. Those issued media credentials must sign an agreement stating no photographs or videos taken will be sold. Credentials will only be issued to media for the purpose of news gathering and dissemination only.

Equine Industry press passes will be issued to photographers for the price of \$900 and these press passes will allow photographers to shoot on grounds, however, not in any show arenas. Press passes can be purchased in the commercial exhibitor office. Violation of the policy will result in removal from the show grounds. Additionally, commercial photographers found violating this policy will be assessed a \$900 fee. This policy extends to violations found post-show through websites, social media, and other outlets.

GR 35 PRIZE MONEY

Prize money will be paid only to the recorded owner at the time of the show. Checks for prize money shall be mailed within 60 days after completion of the show.

The Social Security Number or Federal Taxpayer Identification Number must be on file with AHA before AHA prize money is released. If this information is not on file or is not provided within 120 days after notification, all prize money will be forfeited.

If additional prize money requirements are not fulfilled (See Sweepstakes, Halter Futurity and Performance Futurity/Maturity Chapters), the prize money shall be forfeited.

Foreign residents winning prize money at an event held in the United States will be subject to income tax of 30% per Internal Revenue Service Regulations. This amount will be withheld from total winnings.

GR 36 PROTECTIVE HEADGEAR

Refer to current USEF and Equestrian Canada Rule Books.

GR 37 QUALIFICATIONS

You are qualified from the earliest date you earn the participation required. There is no such thing as re-qualifying.

Qualifications are required for 2022. Please refer to the AHA Handbook or for the web site the following link: www.ArabianHorses.org/competition/resources/qualifications/

**Grey highlight indicates changes for 2022*

ENTERING FOR HORSES AND RIDERS NOT QUALIFIED BY THE CLOSING DATE

Horses and riders that are not qualified as of the closing date but intend to qualify before the start of the National Show they are entering MUST enter and pay the fee.

Qualifications for classes not qualified for by the closing date can be earned up to the start of the show.

If Results from a qualifying show have not been recorded, a qualification report signed by the show secretary will be required before a non qualified class will be qualified.

Elite, Choice and Select riders must meet the definition.

Refer to each show and GR 3 for rules regarding eligibility for Arabian Breeders Sweepstakes restricted classes (ABS).

If you have any questions contact AHA Competition Services at (303) 696-4500, option #4 or email NationalEvents@ArabianHorses.org.

GR 38 SCHEDULE & RING CONFLICTS

When entering, please be aware of entering classes which might run in different rings at the same time. Every effort will be made to solve these conflicts, however rings will not be held for extensive periods to solve conflicts. Entry fees will be forfeited in case of time conflicts caused by two rings running simultaneously that can't be resolved.

It is the policy of the Nationals Show Commissions to not make schedule changes within 24 hours of a class, unless there are extenuating circumstances. No classes will be moved in the schedule once the Omnibus is printed other than sections may be added or cancelled if entries warrant.

The schedules printed in this prize list are TENTATIVE and based on entry projections for each class and the number of sections required. Any change in the number of entries may affect the corresponding number of sections in that class. The Show Commissions will review class entry numbers and sections after the entry deadline and will revise the schedule accordingly if deemed necessary.

Please note No classes will be moved to an earlier day in the schedule. Classes scheduled with only a SFF that must be divided into section due to the number of entries, will have the sections run in place of the SFF and the SFF will be later in the schedule. **If Sections listed in the tentative schedule are canceled, the SFF maybe moved to run where the sections were scheduled for that class.**

Please check the AHA App, the Web site or with the Show Office upon arrival for schedule changes and posted sections.

Please be prepared as no entry fees or other fees will be refunded due to schedule changes. Schedule conflicts between rings are the responsibility of the exhibitor.

Updates to the schedules for all the Nationals shows will

be posted on each shows home page and the AHA App. Please refer to the most current schedule prior to entering the horse show.

GR 39 SCORING SYSTEM

Scoring Systems are outlined in the AHA handbook under COMP 5 and REQ 2.

All National Championship Shows are required to use the AHA approved Majority Opinion System (MOS) (Res. 45-00, Res. 31-07) Scoring System in all applicable classes.

All Breeding/Gelding In-Hand classes will be judged comparatively using the Majority Opinion System (MOS).

Working Hunter, Hunter Hack, Jumper, Hunter Seat Equitation Over Obstacles, Hunter Seat Equitation Not to Jump, Dressage, Dressage Seat Equitation, Reining Horse, Reining Seat Equitation, Cutting, Reined Cow, Working Cow, Trail, and Sport Horse classes are exempt from using the Majority Opinion System.

Sport Horse In-Hand classes that are judged by 2 judges will use the total score system.

Performance Halter will use the AHA score card, the scorecards will be turned into placings and in turn, run through the Majority Opinion System (MOS) to determine the Champion, Reserve Champion and Top Five.

Refer to each show for exceptions to the above for AEPA, AWPA and AHPA Futurity and Maturity classes.

GR 40 SECURITY

Exhibitors are advised that it is their responsibility to secure their valuables and stall area. The Show has a limited number of security personnel on the premises. Please report any issues related to security breaches.

GR 41 SHARPS CONTAINERS

For U.S. Competitions (per USEF Rule Book): Show Management will place at least one sharps container per fifty occupied stalls for the disposal of needles and other disposable sharp instruments in convenient locations in barns housing competition horses. It is competition management's responsibility to replace such containers when full and dispose of them properly. Competition management may fine any individuals including trainers, owners, exhibitors, or their agents up to \$100 plus clean-up costs for improper disposal of needles or other sharp disposable instruments. Competition management will place a notice of this requirement either in its prize list or on a specific handout given to trainers on check in at the competition. If local law has different requirements, local law will prevail.

GR 42 SOLICITATION/SHOPPING EXPO/COMMERCIAL EXHIBITS

All flyers, signs, posters, commercial notices, etc., may

be posted in designated areas only. All others will be removed immediately. Check with the show office or the commercial exhibit office for designated locations. Solicitations will not be allowed on the grounds unless a commercial exhibit booth/space is purchased. No company or business will be permitted to exhibit or hold any sponsored activities without the express written permission of AHA. Solicitation of funds for any political, educational, charitable or other corporation, association, group, individual or cause of any kind is strictly prohibited, without prior written consent from AHA. Exhibitors must have prior written consent from AHA and the proper state authority to conduct a raffle or drawing of any kind. Commercial Exhibit space must be purchased using the "Application for Exhibit Space", which may be obtained from AHA. All Food Concessionaires are contracted by the individual facilities, and Commercial Exhibitors are not allowed to sell food or drinks.

GR 43 STABLING

Arrival is determined by when possession is taken of the block of stalls; Possession is determined by occupancy of stalls with any of the following: horses, bedding, equipment/tack/ curtains or mats.

GROUP STABLING

Exhibitors wishing to be stabled together must send entries together in the same envelope with a stall reservation form listing all the owner names. This form must be sent with the entries, as stalls are assigned using this form. *If your name does not appear on the Stabling Request Form – we cannot guarantee you will be with the group.*

Please submit only one form per group to be stabled together. Forms received after the due date on the form may not be honored. Please check each show and form for the due date for that show. All horses that are not entered into the show (non-competing) must be listed on the stall form.

Every horse is required to be stabled on the show grounds at least 12 hours before the start of the first class in which it is to be shown and must remain continuously on the show grounds until it has completed every class in which it is to be shown.

If the number of horses entered by a trainer or owner exceeds the capacity of the original stalls requested, those horses will be stabled in the order of space available at the time the entry is received.

1. ASSIGNMENT/AVAILABILITY

Check each show as to when stalls will be available.

Please note that patronships must represent one entity

**Grey highlight indicates changes for 2022*



ONLY, and all stalls assigned to any one patron must be designated under a single name (a company, a farm, training stable, an individual, and a family are all considered single entity). Additional stalls requested after the original stalls are purchased may not be assigned in the same location as the original stalls.

2. STALL DAMAGE

Stall walls may not be cut down. Stalls must be vacated in their original condition. Stalls may not be structurally or otherwise altered in any way (including putting nails into walls).

Any and all stalls used by exhibitors must be returned to their original condition prior to leaving the grounds.

Exhibitors will be billed for any alteration/damage to their stalls on the premises to or any required cleanup of any stalls they use.

3. HORSE STALLS

Each entered horse must pay for one stall, all others are considered tack stalls.

No subletting of stalls will be allowed.

Stalls for any non-competing horses must have an official entry form on file with the show office and be listed on the stall request form.

4. TACK STALLS

If you are ordering just tack stalls, Please do not list them only on the stall reservation form or they may be missed. Please use an entry form leaving the horse information blank.

Tack stalls will be assigned subject to their availability. Exhibitors will be allowed to order tack stalls per the individual National Show's policy. Management reserves the right to limit the number of total tack stalls due to availability. Tack stalls that are cancelled by show management will be refunded to the exhibitor.

GR 44 UNAUTHORIZED ANIMALS ON SHOW GROUNDS

Unauthorized animals are not allowed on the show grounds without prior permission from Show Management. At the discretion of management, owners/agents may be charged \$300 per unauthorized animal(s) and unauthorized animal(s) may be removed from the grounds.

GR 45 UNREGISTERED HORSES

All Horses must have a certificate of registration when entering any National Show. **Entries for pending registrations will be held until the registration is complete. A post entry fee will be charged if the registration is NOT completed by the closing date of the show.**

GR 46 VENDORS

A list of Official Vendors for each show is provided in this prize list and on-line at www.ArabianHorses.org. Other suppliers may be used, but deliveries from vendors other than the Official Show Vendors may not be made on the show grounds. See "Solicitations" for information on Commercial Exhibit Space.

GR 47 VETERINARIAN INSPECTION

All animals are subject to a physical inspection and may be examined for the use of mydriatic drugs by the show veterinarian at the discretion of the Show Commission. The Show Management reserves the right to refuse entry onto the show grounds to any horse exposed to, or which may be harboring, a communicable disease. AHA also reserves the right to a postmortem examination free of charge, on any horse, which dies on the show grounds.

GR 48 VETERINARIAN PERMIT & REGISTRATION

The official veterinarian shall be an AAEP member. He/she shall not rule on soundness in classes he/she or a family member may have a horse or pony entered or measure any horses or ponies where a conflict of interest may arise due to personal or family interest in the equine. The official veterinarian may be a competitor and will cover the requirements of USEF. No other veterinarian will be permitted to work on the grounds without registering with the Show Office. Exhibitors wishing to use their private veterinarians must have the veterinarian apply at the Show Office and pay a registration fee before they can work on the grounds. Private Veterinarian applications will be available at the Show Office and must be completed and submitted to the Show Office for written approval. Private veterinarians must be members, in good standing, of the AAEP, licensed in the State or province in which the show is held (proof of license to be submitted with application) and will be required to follow and abide by the AHA, USEF, Equestrian Canada, and AAEP rules and practices.

**AT THE DIRECTION OF THE
AHA JUDGE'S & STEWARD'S
COMMISSIONER**

**AND THE AHA EDUCATION AND
EVALUATION COMMISSION, THE
JUDGE(S) WILL BE PENALIZING
HORSES WITH UNNATURAL TAILS.**

**CONVERSELY, HORSES WITH
NATURAL TAIL CARRIAGE SHOWING
EXPRESSION THAT IS NOT ANGRY OR
OFFENSIVE WILL NOT BE PENALIZED.**

**Grey highlight indicates changes for 2022*

APAHA PREAMBLE

We, as Professional and Amateur Horsemen of the Arabian Horse Association, pledge to assume a positive role as leaders in the Arabian horse community.

While achieving the goals of promoting, showing, and caring for the horse, we shall protect the health, image, and welfare of the breed.

Therefore, we set forth the following standards:

HORSEMEN'S STANDARDS OF CONDUCT

We shall comply with and actively encourage all Professional and Amateur Horsemen to adhere to all rules and regulations of AHA, USEF, CAHR, and EC.

We shall instill confidence, trust, and mutual respect in our clients, fellow exhibitors, and the public by a commitment to ethical practice and avoidance of any action conducive to discrediting the Arabian horse, AHA, or our fellow horsemen.

We shall ensure that the welfare of the Arabian horse is paramount and that every Arabian horse be treated humanely and with dignity, respect, and compassion.

As Horsemen we agree that it is our obligation, not only to the horse, but to each other, to have a reciprocal relationship wherein we are compelled to comment to our peers on their actions as well as be receptive of comments on our actions, if those actions might be perceived or interpreted as abusive or inappropriate.

There should be no malicious force during training. Good horsemanship teaches a horse to respond to the aids with confidence. Abusive practices are those that inflict injury or result in intimidation and fear. This may include jerking, spurring, or whipping when employed in a manner that increases a horse's fear, confusion, or distress.

While most types of tack and training methods are not themselves abusive, we understand

that anything used wrongly, overused, or over done can prove to be abusive or perceived to be abusive by onlookers.

The duration of training sessions should take into account climate conditions, intensity of work, footing and the condition of each horse to ensure there is no undue stress.

We shall conduct all business affairs with integrity, sincerity, and accuracy in an open and forthright manner.

We shall act with integrity in financial dealings with clients, professionals, and the public. We shall employ a policy of full disclosure to our horse's owners, as well as potential buyers, about all facts and knowledge regarding a horse they own or are considering purchasing.

Horsemen will never perform, condone, or allow surgical alteration or procedure on an Arabian horse unless professionally prescribed by a licensed veterinarian, and then, only for the survival or threatened health of an Arabian or Half-Arabian horse. This includes the altering of the natural carriage of the tail, which is one of our breed standards and characteristics.

Horsemen will not administer to any horse engaged in competition drugs or medications that give an unfair competitive advantage or serve no required therapeutic purpose.



20th Annual

INFORMATION / CLASS LIST / CLASS SCHEDULE / RULES



NEW FOR 2022

- New classes for both Arabian & Half-Arabian/Anglo Arabian
- Sport Horse Under Saddle AOTR Maturity for both for 5 & 6 yr olds - nominaton required



NEW FOR 2022

- Sport Horse In-Hand 3 Yr old Jackpot “Pay to Play”
- ABS Sport Horse Under Saddle Jackpot classes are now open to horses 7 & Over
- Sport Horse Under Saddle is now split by type for both Arabians & Half-Arabians/Anglo-Arabians.

Sport Horse Nationals

Welcome to Wilmington



**4 OF THE BEST PLACES TO
TAKE PICTURES IN CLINTON
COUNTY, OHIO**

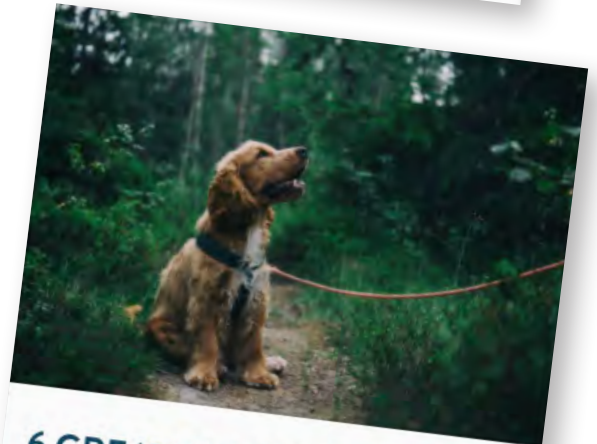

**6 GREAT PLACES TO TAKE
YOUR DOG IN CLINTON
COUNTY, OHIO**

For more information visit

- **CLINTONCOUNTYOHIO.COM**
- **WILMINGTONOH.ORG**



Sport Horse Nationals

GENERAL INFORMATION

FEES:

| | |
|--|-------|
| Class Entry Fees | \$210 |
| Post Entry Fees (per horse) | \$500 |
| Education/Evaluation Fee (Res. 9-90) (per horse) | \$25 |
| Failure to Close Open Show Accounts | \$100 |
| Hunter Warm-up (W) (included per class) | \$30 |

JACKPOT FEES

| | |
|---|--------------------------|
| (J1) ABS AOTR Classes | \$500 |
| (J2) SHN Jackpot | \$500 |
| Late Class Post Fee (per horse) | \$100 |
| Office Fee (per horse) | \$75 |
| Non Competing Horse Fee | \$380 |
| (includes stall, office and per horse fee) | |
| Over Fences Schooling Fee | \$50 |
| (all day, per horse/rider combination) 9/11 | |
| Returned checks/declined credit card fee | \$60 |
| Rider/Equitation Horse Late Change Fee | \$50 |
| Scoring (per horse) | \$15 |
| Scratch Fee (if not filed in office, per class) | \$50 |
| USEF Fees | \$23 |
| (per horse, includes \$8 Admin & \$16 Drug) | |
| USEF Show Pass | \$45 |
| (Exhibitors in Amateur classes must join USEF, show pass is NOT acceptable) | |
| WDAA Non Member Fee | \$35 Adult / \$25 Junior |

STALLING

| | |
|---|-------|
| Patron/Elite Sponsors will receive stalling preferences. | |
| Please see the Preferred Stalling Section for complete details. | |
| Horse stalls (each) | \$220 |
| Tack stalls (each) | \$220 |
| Early Stalling per stall per day | \$30 |

To avoid double billing please do not include early stabling with your entry

OPTIONAL ITEMS:

| | |
|--------------------------------------|----------------|
| Farrier Permit (each) | \$500 |
| Additional Show Program | \$10 |
| Therapist/Chiropractor Fee | \$500 |
| Veterinarian Permit (each) | \$1,000 |
| Full Hook Up RV Space | \$400 |
| Electric & Water RV Space | \$350 |
| RV Additional Days (Sep 8 & 9) | (per day) \$40 |

PATRONSHIPS/EVENT

SPONSORSHIP/PARTICIPATION:

| | |
|-------------------------------------|---------|
| Arena Signs | \$300 |
| Class Sponsorship (per class) | \$200 |
| Platinum Patron | \$2,500 |
| Gold Patron | \$2,100 |
| Elite Sponsorship | \$1,000 |

Additional Event Sponsorships

| | |
|--|-------|
| Dressage Awards Happy Hour (per class) | \$300 |
| Decorations & Flowers | \$200 |
| Class Garlands | \$150 |
| Class Champion Garland | \$115 |
| Class Reserve Champion Garland | \$60 |

GENERAL INFORMATION:

SHOW OFFICE

Office Hours:

| | |
|--|--|
| Saturday - Sunday, September 10 - 11 | 8:30 AM - 7 PM |
| Monday - Saturday, September 12 - 17 | 1 hour prior to the start of classes to 30 min after the last class each day |

BARN OFFICE

Office Hours:

| | |
|---|--------------|
| Thursday - Sunday, September 8 - 11 | 8 AM - 10 PM |
| Monday - September 12 - 17 | 7 AM - 7 PM |

FACILITY SHIPPING INFORMATION

Packages for the horse show will only be accepted from Monday, September 13 thru Friday, September 16. Neither AHA nor World Equestrian Center is responsible for lost or stolen packages.

World Equestrian Center (Fed Ex/UPS only)
Attn: Arabian Sport Horse Nationals
(Person's name or company)
4095 OH-730, Wilmington, OH 45177

SHOW COMMISSION

| | |
|--------------------------|--------------|
| Jim Porcher, Chair | New Mexico |
| Jill Barton | Ontario |
| Wanda Funk | Florida |
| Cricket Gates | Pennsylvania |
| Mike Moak | Georgia |
| Marilyn Weber | Illinois |

Show Commission can be contacted at:

Arabian Horse Association
Attn: SHN Show Commission
10805 East Bethany Drive
Aurora, CO 80014
Phone (303) 696-4500 • Fax (303) 696-4599
NationalEvents@ArabianHorses.org
www.ArabianHorses.org

Changes For 2022 Are Shaded



OFFICIALS

| | |
|---|------------------------------------|
| Show Manager | Jim Porcher |
| Director of National Events & Marketing | |
| Kelsey Berglund | (720) 648-9220 |
| Kelsey.Berglund@ArabianHorses.org | |
| Nationals Events Coordinator | |
| Lindsey Phipps | (303) 696-4553 |
| Lindsey.Phipps@ArabianHorses.org | |
| National Events Coordinator II | |
| Paige Lockard | (303) 696-4535 |
| Paige.Lockard@arabianhorses.org | |
| National Show Secretary | |
| Marlene Kriegbaum | (303) 696-4501 |
| Marlene.Kriegbaum@ArabianHorses.org | |
| Operations Manager | Matt Kwapich |
| USEF Stewards | Nancy Harvey |
| | Joan Shelton-Palalek |
| Ring Stewards | Matthew Amsden |
| | Alison Walk-Sheridan |
| Announcers | |
| Hunter/Jumper | TBA |
| Sport Horse | Andrew Bailey |
| Dressage | TBA |
| Barn Manager | Dave Daugherty (614) 989-2385 |
| | ddaughe1@insight.rr.com |
| Dressage Technical Delegate | Cheryl Tobey |
| Dressage Coordinators | Carol Spangler |
| Driving Course Designer | Karen Homer-Brown |
| Farrier | Joe Proby |
| Hunter & Jumper Course Designer | Mike Puffer |
| Photographer | Don Stine / www.donstine.com |
| Veterinarian | Equine Athlete Veterinary Services |
| | Dr. Brad Hill (517) 643-1091 |
| Web Live Streaming | Arabian Horse Association |
| | www.arabianhorses.stream |

JUDGES

The management reserves the right to vary or add to this list. Panels and/or judge order are subject to change.

HUNTER/JUMPER

| | |
|-----------------------|----------------|
| Nancy Seyfried | Athens, GA |
| Page Tredennick | Wellington, FL |

DRESSAGE

| | |
|--------------------------------|--------------|
| Brian MacMahon (WD) | Welborn, FL |
| Donna Longacre (WD) | Longview, WA |
| Fran (Dearing) Kehr | Magnolia, TX |
| Eleanor Stine-Masek (WD) | Marana, AZ |
| Susan Mandas | Dayton, OH |

SPORT HORSE IN-HAND

| | |
|----------------------------|----------------|
| John Abbott (HB) | Aiken, SC |
| Stella Prescott (HB) | Selma, NC |
| Jos Sevriens (DB) | Newnan, GA |
| Anne Moss (DB) | Coatsville, PA |

SPORT HORSE UNDER SADDLE (MOS)

Hunter Type

| | |
|---|-----------|
| John Abbott (HB) | Aiken, SC |
| Stella Prescott (HB) | Selma, NC |
| <i>The Hunter Jumper Judges, Seyfried & Tredennick will alternate</i> | |

Dressage Type

| | |
|-------------------------------|----------------|
| Jos Sevriens (DB) | Newnan, GA |
| Anne Moss (DB) | Coatsville, PA |
| Karen Winn (& Eventing) | Lexington, KY |

DRIVING

| | |
|--------------------|--|
| Katie Whaley | |
|--------------------|--|

The judges for Sport Horse Arabian & Half-Arabian National Championship Show were selected by the Judges and Stewards Selection Committee.

IMPORTANT DEADLINES & DATES

ENTRIES ACCEPTED AS FOLLOWS:

Entries Post Marked/Electronically Dated on or prior to Tuesday, July 19 Midnight (MT) *Regular fees*

POST ENTRIES ACCEPTED AS FOLLOWS:

Between Tuesday, July 20 and Monday, August 22, Midnight (MT)

Added class for horse entered by July 20

Regular class fee plus \$100 Late fee per class

New horse

Regular fees Plus \$500 Post fee per horse

POST ENTRIES MUST BE RECEIVED BY AUGUST 23, 5 PM

Post entries for new horses may be entered online starting July 20, Noon.

If you are adding a class you will need to use an entry form.

No Post entries will be accepted after August 22 for any reason.

PERFORMANCE MATURITY CLASSES

Enrollment into the National Performance Maturity is required in order for a horse to participate in these classes. Payment can be made in full (postmarked by May 1) or in payments (due May 1, June 1 and July 1). Enrollments made after these dates are subject to late fees. Enrollment into the program does not constitute entry in the Sport Horse National Championship Show. The Sport Horse National Maturity Enrollment Form can be found on the AHA website. See Chapter 20 of the AHA Handbook for additional information.

DNA FOR HALF-ARABIANS

All Half-Arabians must have DNA type of the horse and the horse's purebred Arabian parent placed on permanent record with the AHA Registry and the horse must qualify as an offspring of the stated purebred sire or purebred dam through DNA testing in order to compete in the Performance Maturity Classes. If the DNA is not on file before the class, the horse will be ineligible to be shown.

ARRIVAL & STALLING INFORMATION

Group Stabling due – Monday, August 22 Midnight (MT) In-House/Electronically Dated

NO ARRIVAL is permitted prior to Thursday, September 8, NOON

Early arrival will be charged from;

**Thursday, September 8 noon to
Saturday, September 11, prior to 8:00 AM**

\$30 per stall (horse & tack) per night for the block

After Saturday, September 11, 8:00 AM
no additional charge.

Sunday Sept 18, by 8 AM Stalls must be vacated

***NO EXCEPTIONS**



Sport Horse Nationals

CLASS LIST

| # | CLASS | TOTAL FEE per class |
|---|-------|---------------------|
|---|-------|---------------------|

**Arabian Breeders Sweepstakes Allocated Payback*

SPORT HORSE IN-HAND

| | | |
|-------|--|-------|
| *1022 | ABS Arabian Yearling Sport Horse Filly In-Hand CH | \$210 |
| *1023 | ABS Arabian Yearling Sport Horse Colt/Gelding In-Hand CH | \$210 |
| *1024 | ABS HA/AA Yearling Sport Horse Filly In-Hand CH | \$210 |
| *1025 | ABS HA/AA Yearling Sport Horse Colt/Gelding In-Hand CH | \$210 |

YEARLINGS MUST BE ENROLLED AS A BREEDING ENTRY. NO OTHER QUALIFICATIONS ARE REQUIRED FOR SPORT HORSE NATIONALS. YEARLINGS MAY NOT CROSS ENTER INTO ATH OR OPEN (COMP 1203.1)

| | | |
|-------|--|-------|
| *599 | Arabian 2 Year Old Sport Horse Colt In-Hand CH | \$210 |
| *600 | Arabian 2 Year Old Sport Horse Gelding In-Hand CH | \$210 |
| *601 | Arabian 2 Year Old Sport Horse Filly In-Hand CH | \$210 |
| *1331 | HA/AA 2 Year Old Sport Horse Colt/Gelding In-Hand CH | \$210 |
| *604 | HA/AA 2 Year Old Sport Horse Fillies In-Hand CH | \$210 |
| 2701 | Arabian Sport Horse Mare In-Hand Hunter Type 3 & Over CH | \$210 |
| 2709 | Arabian Sport Horse Mare In-Hand Hunter Type 3 & Over ATH CH | \$210 |
| 2721 | Arabian Sport Horse Stallion In-Hand Hunter Type 3 & Over CH | \$210 |
| 2729 | Arabian Sport Horse Stallion In-Hand Hunter Type 3 & Over ATH CH | \$210 |
| 2741 | Arabian Sport Horse Gelding In-Hand Hunter Type 3 & Over CH | \$210 |
| 2749 | Arabian Sport Horse Gelding In-Hand Hunter Type 3 & Over AT CH | \$210 |
| 2761 | Arabian Sport Horse Mare In-Hand Dressage Type 3 & Over CH | \$210 |
| 2769 | Arabian Sport Horse Mare In-Hand Dressage Type 3 & Over ATH CH | \$210 |
| 2781 | Arabian Sport Horse Stallion In-Hand Dressage Type 3 & Over CH | \$210 |
| 2789 | Arabian Sport Horse Stallion In-Hand Dressage Type 3 & Over ATH CH | \$210 |
| 2801 | Arabian Sport Horse Gelding In-Hand Dressage Type 3 & Over CH | \$210 |
| 2809 | Arabian Sport Horse Gelding In-Hand Dressage Type 3 & Over ATH CH | \$210 |
| 2821 | HA/AA Sport Horse Mare In-Hand Hunter Type 3 & Over CH | \$210 |
| 2829 | HA/AA Sport Horse Mare In-Hand Hunter Type 3 & Over ATH CH | \$210 |
| 1692 | HA/AA Sport Horse Gelding/Stallion In-Hand Hunter Type 3 & Over CH | \$210 |
| 2044 | HA/AA Sport Horse Gelding/Stallion In-Hand Hunter Type 3 & Over ATH CH | \$210 |
| 2881 | HA/AA Sport Horse Mare In-Hand Dressage Type 3 & Over CH | \$210 |
| 2889 | HA/AA Sport Horse Mare In-Hand Dressage Type 3 & Over ATH CH | \$210 |
| 1691 | HA/AA Sport Horse Gelding/Stallion In-Hand Dressage Type 3 & Over CH | \$210 |
| 2043 | HA/AA Sport Horse Gelding/Stallion In-Hand Dressage Type 3 & Over ATH CH | \$210 |
| 1026 | Sport Horse In-Hand Supreme Champion | \$0 |

(Champions from all Sport Horse In-Hand 3 & Over classes may show in this class)

SHN SPORT HORSE IN HAND 3 YR OLD JACKPOT

EXTRA FEE

| | | | |
|--------|---|----|-------|
| 1721 | SHN Arabian Sport Horse In Hand 3 yr old Jackpot - Mare | J2 | \$710 |
| 1722 | SHN Arabian Sport Horse In Hand 3 yr old Jackpot - Gelding | J2 | \$710 |
| 1723 | SHN Arabian Sport Horse In Hand 3 yr old Jackpot - Stallion | J2 | \$710 |
| D 1991 | SHN HA/AA Sport Horse In Hand 3 yr old Jackpot - Mare | J2 | \$710 |
| D 1992 | SHN HA/AA Sport Horse In Hand 3 yr old Jackpot - Gelding/Stallion | J2 | \$710 |

New Classes OR Changes For 2022 Are Shaded

D / DNA Required

J1 / ABS Jackpot Fee @ \$500

J2 / ABS Jackpot Fee @ \$500



| # | CLASS | TOTAL FEE per class |
|---|-------|---------------------|
|---|-------|---------------------|

UNDER SADDLE

EXTRA FEE

| | | |
|------|--|-------|
| 2680 | Arabian Sport Horse Under Saddle Hunter Type CH | \$210 |
| 2684 | Arabian Sport Horse Under Saddle Dressage Type CH | \$210 |
| 2682 | Arabian Sport Horse Under Saddle Hunter Type ATR CH | \$210 |
| 2686 | Arabian Sport Horse Under Saddle Dressage Type ATR CH | \$210 |
| 338 | Arabian Sport Horse Under Saddle AOTR CH | \$210 |
| 1679 | Arabian Sport Horse Under Saddle Junior Horse Hunter Type CH | \$210 |
| 1678 | Arabian Sport Horse Under Saddle Junior Horse Dressage Type CH | \$210 |
| 1505 | ABS Arabian Sport Horse Under Saddle ATOR Jackpot (7+ Yr olds).....J1..... | \$710 |

Restricted to horses that are enrolled as a Breeding Entry or Original Entry

| | | |
|---------------|--|-------|
| D 1743 | Arabian Sport Horse Under Saddle AOTR Maturity (5 & 6 Yr Olds)** | \$210 |
|---------------|--|-------|

****Two part entry 1. Must be enrolled in Maturity Program and all fees paid prior to the show paid up prior to the show**
2. Must enter the class on the official entry form & pay the class entry fee

| | | |
|--------|---|-------|
| 2688 | HA/AA Sport Horse Under Saddle Hunter Type CH | \$210 |
| 2692 | HA/AA Sport Horse Under Saddle Dressage Type CH | \$210 |
| 2690 | HA/AA Sport Horse Under Saddle ATR Hunter Type CH | \$210 |
| 2694 | HA/AA Sport Horse Under Saddle ATR Dressage Type CH | \$210 |
| fg 776 | HA/AA Sport Horse Under Saddle AOTR CH | \$210 |
| 1767 | HA/AA Sport Horse Under Saddle Junior Horse Hunter Type CH | \$210 |
| 1766 | HA/AA Sport Horse Under Saddle Junior Horse Dressage Type CH | \$210 |
| 1506 | ABS HA/AA Sport Horse Under Saddle ATOR Jackpot (7+ yrs olds).....J1..... | \$710 |

Open to Sweepstakes Breeding or Original Entries 7 and over

| | | |
|---------------|--|-------|
| D 1744 | HA/AA Sport Horse Under Saddle AOTR Maturity (5 & 6 Yr Olds)** | \$210 |
|---------------|--|-------|

****Two part entry 1. Must be enrolled in Maturity Program and all fees paid prior to the show paid up prior to the show**
2. Must enter the class on the official entry form & pay the class entry fee

SHOW HACK

| | | |
|------|--|-------|
| 348 | Arabian Sport Horse Show Hack CH | \$210 |
| 352 | Arabian Sport Horse Show Hack ATR CH | \$210 |
| 1051 | HA/AA Sport Horse Show Hack CH | \$210 |
| 1055 | HA/AA Sport Horse Show Hack ATR CH | \$210 |

CARRIAGE PLEASURE DRIVING

| | | |
|------|---|-------|
| 1228 | A/HA/AA Carriage Pleasure Driving Working CH | \$210 |
| 1232 | A/HA/AA Carriage Pleasure Driving Turnout CH | \$210 |
| 1236 | A/HA/AA Carriage Pleasure Driving Reinsmanship CH | \$210 |
| 1297 | A/HA/AA Carriage Pleasure Driving Pick Your Route Obstacle CH | \$210 |
| 1248 | A/HA/AA Carriage Pleasure Driving Drive & Ride CH | \$210 |
| 1272 | A/HA/AA Carriage Pleasure Driving Scurry Obstacle CH | \$210 |
| 1285 | A/HA/AA Carriage Pleasure Driving Reverse Psychology CH | \$210 |
| 1322 | A/HA/AA Carriage Pleasure Driving Timed Obstacle CH | \$210 |

New Classes OR Changes For 2022 Are Shaded

D / DNA Required

J1 / ABS Jackpot Fee @ \$500

J2 / ABS Jackpot Fee @ \$500



Sport Horse Nationals

CLASS LIST

| # | CLASS | TOTAL FEE per class |
|---|-------|---------------------|
|---|-------|---------------------|

DRESSAGE ENGLISH

| | | |
|---|--|-------|
| 1401..... | Arabian Dressage Training Level CH | \$210 |
| 1400..... | Arabian Dressage Training Level Junior Horse CH..... | \$210 |
| 1402..... | Arabian Dressage Training Level AAOTR CH | \$210 |
| 1403..... | Arabian Dressage Training Level ATR CH | \$210 |
| 1411..... | Arabian Dressage First Level CH | \$210 |
| 1405..... | Arabian Dressage First Level AAOTR CH | \$210 |
| 1406..... | Arabian Dressage First Level ATR CH | \$210 |
| 1421..... | Arabian Dressage Second Level CH..... | \$210 |
| 1409..... | Arabian Dressage Second Level AAOTR CH..... | \$210 |
| 1410..... | Arabian Dressage Second Level ATR CH | \$210 |
| 1414..... | Arabian Dressage Third Level CH | \$210 |
| 1501..... | HA/AA Dressage Training Level CH..... | \$210 |
| 1404..... | HA/AA Dressage Training Level Junior Horse CH | \$210 |
| 1502..... | HA/AA Dressage Training Level AAOTR CH | \$210 |
| 1503..... | HA/AA Dressage Training Level ATR CH | \$210 |
| 1511..... | HA/AA Dressage First Level CH..... | \$210 |
| 1407..... | HA/AA Dressage First Level AAOTR CH..... | \$210 |
| 1408..... | HA/AA Dressage First Level ATR CH | \$210 |
| 1521..... | HA/AA Dressage Second Level CH | \$210 |
| 1412..... | HA/AA Dressage Second Level AAOTR CH | \$210 |
| 1413..... | HA/AA Dressage Second Level ATR CH | \$210 |
| 1417..... | HA/AA Dressage Third Level CH | \$210 |
| *1504..... | ABS A/HA/AA Dressage Prospect Incentive..... | \$210 |
| <u>*Restricted to horses 4-5 years old and are enrolled as a Breeding Entry or Original Entry</u> | | |
| 821..... | A/HA/AA Dressage Third Level ATR CH | \$210 |
| 824..... | A/HA/AA Dressage Fourth Level CH | \$210 |
| 828..... | A/HA/AA Dressage Fourth Level ATR CH..... | \$210 |
| 883..... | A/HA/AA Dressage Prix St. George CH..... | \$210 |
| 887..... | A/HA/AA Dressage Intermediate I CH..... | \$210 |
| 888..... | A/HA/AA Dressage Intermediate II CH..... | \$210 |
| 889..... | A/HA/AA Dressage Grand Prix CH | \$210 |
| 1427..... | A/HA/AA Dressage Prix St. George ATR CH..... | \$210 |

DRESSAGE WESTERN

| | | |
|-----------|---|-------|
| 2316..... | Arabian Western Dressage Basic Level CH | \$210 |
| 2317..... | HA/AA Western Dressage Basic Level CH | \$210 |
| 1573..... | Arabian Western Dressage Basic Level ATR CH | \$210 |
| 1574..... | HA/AA Western Dressage Basic Level ATR CH | \$210 |
| 2314..... | A/HA/AA Western Dressage Basic Level ATR CH | \$210 |
| 2402..... | A/HA/AA Western Dressage Level 1 CH..... | \$210 |
| 2414..... | A/HA/AA Western Dressage Level 1 ATR CH..... | \$210 |

New Classes OR Changes For 2022 Are Shaded

W / Warm-up Round @ \$30 per class



| # | CLASS | TOTAL FEE per class |
|------|-------------------------------------|---------------------|
| 2502 | A/HA/AA Western Dressage Level 2 CH | \$210 |
| 2552 | A/AH/AA Western Dressage Level 3 CH | \$210 |

HUNTER HACK

| | | |
|-----|--|-------|
| 361 | Arabian Hunter Hack CH (2'6") | \$210 |
| 365 | Arabian Hunter Hack ATR CH (2'3") | \$210 |
| 366 | Arabian Hunter Hack AAOTR CH (2'3") | \$210 |
| 368 | Arabian Hunter Hack Junior Horse CH (2'3") | \$210 |
| 767 | HA/AA Hunter Hack CH (2'6") | \$210 |
| 771 | HA/AA Hunter Hack ATR CH (2'3") | \$210 |
| 772 | HA/AA Hunter Hack AAOTR CH (2'3") | \$210 |
| 765 | HA/AA Hunter Hack Junior Horse CH (2'3") | \$210 |

WORKING HUNTER

| | | EXTRA FEE |
|------|---|--------------|
| 266 | Arabian Working Hunter CH (3') | W \$30 \$240 |
| 269 | Arabian Working Hunter AAOTR CH (2'9") | W \$30 \$240 |
| 271 | Arabian Working Hunter ATR CH (2'6") | W \$30 \$240 |
| 278 | Arabian Green Working Hunter CH (2'6"/2'9") | W \$30 \$240 |
| 711 | HA/AA Working Hunter CH (3') | W \$30 \$240 |
| 714 | HA/AA Working Hunter AAOTR CH (2'9") | W \$30 \$240 |
| 716 | HA/AA Working Hunter ATR CH (2'6") | W \$30 \$240 |
| 724 | HA/AA Green Working Hunter CH (2'6"/2'9") | W \$30 \$240 |
| 1601 | A/HA/AA 14.2 & Under Working Hunter CH (2'6") | W \$30 \$240 |

All of the above classes include a warm-up round (W = \$30) before your judged round

| | | |
|-------|---|-------|
| *1520 | ABS A/HA/AA Green Working Hunter Derby CH (2'6"/2'9") | \$210 |
|-------|---|-------|

*Restricted to horses that are enrolled as a Breeding Entry or Original Entry

HUNTER SEAT EQUITATION

| | | |
|-----|---|-------|
| 940 | A/HA/AA Hunt Seat Equitation Not To Jump ATR CH | \$210 |
| 947 | A/HA/AA Hunt Seat Equitation Over Obstacles ATR CH (2'9") | \$210 |

JUMPER

| | | |
|------|----------------------------------|-------|
| 1149 | A/HA/AA Speed Jumper CH (0.8M) | \$210 |
| 1801 | A/HA/AA Open Jumper Stake (0.9M) | \$210 |
| 1803 | A/HA/AA Jumper ATR CH (0.8M) | \$210 |
| 1805 | A/HA/AA Novice Jumper CH (0.7M) | \$210 |

EXHIBITION

| | | |
|------|--|-------|
| 873 | A/HA/AA Hunter Derby Exhibition (2'6"/2'9"/3') | \$100 |
| 2500 | A/HA/AA Musical Freestyle Calcutta Exhibition (English or Western) | \$100 |
| 1204 | A/HA/AA Beginner Novice Combined Training Exhibition | \$100 |

Dressage Section A

Jumper Section B (0.8M)

New Classes OR Changes For 2022 Are Shaded

W / Warm-up Round @ \$30 per class



3/11/21

TENTATIVE SCHEDULE
September 12 - 17, 2022 Wilmington, OH
WORLD EQUESTRIAN CENTER

This schedule is based on entry projections for each class, and the number of sections required.

The Show Commission will review class entry numbers and sections after the entry deadline and will revise accordingly if deemed necessary. Any change in the number of entries may effect corresponding number of sections for that class. The following are the minimum number of entries required for each class and section. If the number of entries is less than the minimum, the class will be discontinued.

Please check on the App or in the show office for any changes.

When entering, please be aware of entering classes which might run in different rings at the same time. Every effort will be made to solve these conflicts however rings will not be held for extensive periods to solve conflicts. Entry fees will be forfeited in case of time conflicts caused by two rings running simultaneously that can't be resolved. Classes where sections are scheduled but cancelled, the SFF MAY run where the sections were scheduled. Classes scheduled with only a SFF that is divided into sections, will have the sections run in place of the SFF and the SFF will be later in the schedule.

****Dressage Classes may not run in the order or on day listed****

PRIZE AWARDS WILL BE APPROX 5 PM EACH DAY AND PRESENTED IN THE ORDER THEY CLOSE OUT.

Hacking will be allowed in the hunter ring in the mornings prior to the jump crew setting the course and the drag. No jumping is allowed. The rings will be open in the evening for schooling for one hour every day, weather and time permitting, and the schooling times for each day will be announced.

Judging Panels and /or Judging order is subject to change

Dressage/Western Dressage
 Fran (Dearing) Kehr (FK)
 Sue Kosiadt (SK)
 Eleanor - Sline Masek (ES) - Western Dressage
 Susan Mandas (SM)
 Donna Longacre (DL) - Western Dressage
 Brian MacMahon (BM) - Western Dressage
 Eventing: TBA (E) Karen Winn

Carriage Driving (C) = Katie Whaley

Sunday September 11, 2022

EXHIBITORS WELCOME PARTY 6 PM

9:00 am - 5:00 pm Hunter Jumper All Day Schooling

Monday September 12, 2022

| SPORT HORSE RING - SANCTUARY | | | | HUNTER JUMPER RING 9:00 AM | | DRESSAGE COURTS 8:00 am | | | |
|------------------------------|--|------|------|----------------------------|--|-------------------------|--|------|----|
| # | <u>Triangle 1 8:00 am</u> | SFC | TEAM | # | Sec | Court 1 | # | Sec | @C |
| 2801 | Arabian SH Gelding in Hand Dressage Type 3 & over CH | SF/F | DD | 361 | SF/F | H/J | Kehr, Kolstadt | SF/F | FK |
| | | | | 767 | H/A/A/A Hunter Hack CH | H/J | 1401 Arabian Dressage Training Level CH | SF/F | |
| 2741 | Arabian SH Gelding in Hand Hunter Type 3 & over CH | SF/F | HH | | | | Court 2 | | |
| | <u>Triangle 1 Afternoon TBA (Not Before Noon)</u> | | | 365 | Arabian Hunter Hack ATR CH (23") | H/J | Stine-Masek, Mandas | SF/F | ES |
| 2881 | HA/AA SH Mare in Hand Dressage Type 3 & over CH | SF/F | DD | 771 | H/A/A/A Hunter Hack ATR CH | H/J | 1406 Arabian Dressage First Level ATR CH | SF/F | |
| | | | | | | | 1501 H/A/A/A Dressage Training Level CH | SF/F | |
| 2821 | HA/AA SH Mare in Hand Hunter Type 3 & over CH | SF/F | HH | 368 | Arabian Hunter Hack Junior Horse CH (23") | H/J | Court 3 | | A |
| | <u>Triangle 2 Afternoon TBA (Not Before Noon)</u> | | | 765 | H/A/A/A Hunter Hack Junior Horse CH | H/J | A/H/A/A/A Beginner Novice Combined Training Exh Dressage section A | | E |
| | | | | | | | Longacre, MacMahon | | DL |
| 776 | H/A/A/A Sport Horse Under Saddle AOTR | A/B | T2 | | | | 821 A/H/A/A/A Dressage Third Level ATR CH | SF/F | |
| 2680 | Arabian Sport Horse Under Saddle Hunter Type CH | A/B | HT | | | | | | |
| 1051 | H/A/A/A Sport Horse Show Hack | A/B | DT | | | | | | |
| 338 | Arabian Sport Horse Under Saddle AOTR CH | A/B | T1 | 1601 | A/H/A/A/A 14.2 & Under Working Hunter CH (26") | A/B | | | |
| 2692 | H/A/A/A Sport Horse Under Saddle Dressage Type CH | A/B | DT | 1601 | A/H/A/A/A 14.2 & Under Working Hunter CH | C/F/NL | | | |
| 352 | Arabian Sport Horse Show Hack ATR CH | SF/F | DT | | | | | | |
| 1744 | H/A/A/A Sport Horse Under Saddle AOTR Maturity 5 & 6 yr olds | SF/F | T1 | | | | | | |

1744 HA/AA Sport Horse Under Saddle AOTR Maturity 5 & 6 yr olds

Tuesday September 13, 2022

| SPORT HORSE RING - SANCTUARY | | | | HUNTER JUMPER RING 9:00 AM | | | | DRESSAGE COURTS 8:00 am | | | |
|------------------------------|---|------|------|----------------------------|---|-------|------|-------------------------|---|------|----|
| # | Triangle 1 8:00 am | Sec | Team | # | Hunter Warm Up Will Precede Your Judged Round | Sec | Team | # | Court 1 | Sec | @C |
| 1691 | HA/AA Sport Horse Gelding Stallion In Hand Dressage Type 3 & over CH | SF/F | DD | 278 | Arabian Green Working Hunter CH (2'6"/2'9") | A/B | H/J | 1407 | Kehr, Kolstadt | SF/F | SK |
| 1692 | HA/AA Sport Horse Gelding Stallion In Hand Hunter Type 3 & over CH | SF/F | HH | 278 | Arabian Green Working Hunter CH | C/FNL | H/J | 1400 | Arabian Dressage Training Level Junior Horse CH | SF/F | |
| 2769 | Arabian TBA (Not Before Noon) | SF/F | DD | 724 | HA/AA Green Working Hunter CH (26"/2'9") | A/B | H/J | 889 | Stine-Masek, Mandas | SF/F | SM |
| 2709 | Arabian Sport Horse Mare In Hand Dressage Type ATH 3 & Over CH | SF/F | HH | 724 | HA/AA Green Working Hunter CH | C/FNL | H/J | 1405 | HA/AA Dressage Grand Prix CH | SF/F | |
| 2709 | Arabian Sport Horse Mare In Hand Hunter Type ATH 3 & Over CH | SF/F | HH | 266 | Arabian Working Hunter CH (3') | A/B | H/J | 1417 | HA/AA Dressage Third Level CH | SF/F | |
| 2690 | HA/AA Sport Horse Under Saddle Hunter Type ATR CH | A/B | HT | 266 | Arabian Working Hunter CH | C/FNL | H/J | | | | |
| 2686 | Arabian Sport Horse Under Saddle Dressage Type ATR CH | A/B | DT | 711 | HA/AA Working Hunter CH (3') | A/B | H/J | | | | |
| 1767 | HA/AA Sport Horse Under Saddle Junior Horse Hunter Type CH | SF/F | HT | 711 | HA/AA Working Hunter CH | C/FNL | H/J | 1404 | Longacre, MacMahon | SF/F | BM |
| 348 | Arabian Sport Horse Show Hack | SF/F | DT | | | | | 1574 | HA/AA Western Dressage Basic ATR CH | SF/F | |
| 1055 | HA/AA Sport Horse Show Hack ATR CH | A/B | DT | | | | | | | | |
| 1743 | Arabian Sport Horse Under Saddle AOTR Maturity 5 & 6 yr olds | SFF | T2 | | | | | | | | |

The Sanctuaries will be closed for 1 hour after the presentations for driving practice ONLY

Wednesday September 14, 2022

| SPORT HORSE RING - SANCTUARY | | | | HUNTER JUMPER RING 9:00 AM | | | | DRESSAGE COURTS 8:00 am | | | |
|------------------------------|--|------|------|----------------------------|---|-------|------|-------------------------|--|------|----|
| # | Triangle 1 8:00 am | Sec | Team | # | Hunter Warm Up Will Precede Your Judged Round | Sec | Team | # | Court 1 | Sec | @C |
| 2761 | Arabian Sport Horse Mare In Hand Dressage Type 3 & Over CH | SF/F | DD | 271 | Arabian Working Hunter ATR CH (2'6") | A/B | H/J | 1427 | Kehr, Kolstadt | SF/F | FK |
| 2701 | Arabian Sport Horse Mare In Hand Hunter Type 3 & Over CH | SF/F | HH | 271 | Arabian Working Hunter ATR CH | C/FNL | H/J | 1521 | HA/AA Dressage Second Level CH | SF/F | |
| 599 | Arabian 2 Year Old Sport Horse Colt In Hand CH | SF/F | T1 | 716 | HA/AA Working Hunter ATR CH (2'6") | A/B | H/J | 1414 | Arabian Dressage Third Level CH | SF/F | |
| 1331 | HA/AA 2 Year Old Sport Horse Colt Gelding In Hand CH | SF/F | T1 | 716 | HA/AA Working Hunter ATR CH | C/FNL | H/J | | | | |
| 600 | Arabian 2 Year Old Sport Horse Gelding In-Hand CH | SF/F | T1 | 1520 | AH/AA ABS Green Working Hunter Derby (26"/2'9") | A/B | H/J | 1409 | Stine-Masek, Mandas | SF/F | ES |
| 1991 | SH/HA/AA Sport Horse In Hand 3 yr old Jackpot - Mare | SF/F | T1 | 1520 | AH/AA ABS Green Working Hunter Derby | C | H/J | 1402 | Arabian Dressage Training Level AAOTR CH | SF/F | |
| 601 | Arabian Sport Horse 2 Year Old Filly In Hand CH | SF/F | T2 | | \$15,000 Available Sweepstakes Prize Money for CH - \$4,000 RC - \$3,000 TT - \$1,000 | | | | | | |
| 604 | HA/AA 2 Year Old Sport Horse Filly In Hand CH | SF/F | T2 | | | | | | | | |
| 1721 | SH/HA/AA Sport Horse In Hand 3 yr old Jackpot - Mare | SF/F | T2 | | | | | | | | |
| 1232 | AH/AA Carriage Pleasure Driving - Turnout CH | SF/F | C | | | | | | | | |
| 1248 | AH/AA Carriage Pleasure Driving - Drive & Ride CH | SF/F | C | | | | | | | | |
| 1051 | HA/AA Sport Horse Show Hack | SF/F | DT | | | | | | | | |
| 1679 | Arabian Sport Horse Under Saddle Junior Horse Hunter Type CH | SF/F | HT | | | | | | | | |
| 2688 | HA/AA Sport Horse Under Saddle Hunter Type CH | A/B | HT | | | | | | | | |
| 2684 | Arabian Sport Horse Under Saddle Dressage Type CH | A/B | DT | | | | | | | | |
| 2694 | HA/AA Sport Horse Under Saddle Dressage Type ATR CH | A/B | DT | | | | | | | | |





| Friday September 16, 2022 | | | | | | |
|------------------------------|---|----|----------------------------|---|-------------------------|---|
| SPORT HORSE RING - SANCTUARY | | | HUNTER JUMPER RING 9:00 AM | | DRESSAGE COURTS 8:00 am | |
| # | Triangle 1 - 8:00 am Arabian Sport Horse Gelding In Hand Dressage Type 3 & Over ATH CH | DD | SF/F | Hunter Warm Up Will Precede Your Judged Round | Court 1 | Sec @C |
| 2809 | Arabian Sport Horse | | | 269 Arabian Working Hunter AAOTR CH (2'9") | A/B H/J | |
| | Triangle 2 - 8:00 am | | | 269 Arabian Working Hunter AAOTR CH | C /F/NL | |
| 2749 | Arabian Sport Horse Gelding In Hand Hunter Type 3 & Over ATH CH | HH | SF/F | 714 HA/AA Working Hunter AAOTR CH (2'9") | A/B H/J | ** 1504 ABS AH/A/AA Dressage Prospect Incentive |
| | Triangle 1 - Afternoon TBA (Not Before Noon) | | | 714 HA/AA Working Hunter AAOTR CH | C /F/NL | ** MUST BE A SWEETSTAKES BREEDING OR ORIGINAL ENTRY |
| 2789 | Arabian Sport Horse Stallions In Hand Dressage Type 3 & Over ATH CH | DD | SF/F | 366 Arabian Hunter Hack AAOTR CH (2'3") | SF/F H/J | \$15,000 Available Sweepstakes Prize Money for CH - \$4,000 RC - \$3,000 TT - \$1,000 |
| | Triangle 2 Afternoon TBA (Not Before Noon) | | | 772 HA/AA Hunter Hack AAOTR CH (2'3") | SF/F H/J | 1411 Arabian Dressage First Level CH |
| 2729 | Arabian Sport Horse Stallion In Hand Hunter Type 3 & Over ATH CH | HH | SF/F | | | 887 AH/A/AA Dressage Intermediate I CH |
| | EVENING Not Before 5:30 | | | | Court 2 | |
| | Awards for The ABS Young Horse Dressage Prospect Best Dressed and Best Turnout | | | | Longacre, Mandas | |
| 2680 | Arabian Sport Horse Under Saddle Hunter Type CH | HT | SF/F | | | 828 AH/A/AA Dressage Fourth Level ATR CH |
| 1506 | ABS HA/AA Sport Horse 7 & Over Under Saddle AOTR Jackpot CH | T2 | SFF | | | 1410 Arabian Dressage Second Level ATR CH |
| | Up to \$15,000 Sweetstakes plus Jackpot fee @ \$500 per horse | | | | | 1511 HA/AA Dressage First Level CH |
| | CH = 20% RC = 10% TT = 8.75% | | | | Court 3 | |
| 1678 | Arabian Sport Horse Under Saddle Junior Horse Dressage Type CH | DT | SF/F | | | S/Line-Mask, MacMahon |
| 338 | Arabian Sport Horse Under Saddle AOTR CH | T1 | SF/F | | | 2317 HA/AA Western Dressage Basic Level Open CH |
| 2694 | HA/AA Sport Horse Under Saddle Dressage Type ATR CH | DT | SF/F | | | 1573 Arabian Western Dressage Basic ATR CH |
| 2684 | Arabian Sport Horse Under Saddle Dressage Type CH | DT | SF/F | | | LOCATION: Roberts Arena |
| 2690 | HA/AA Sport Horse Under Saddle Hunter Type ATR CH | HT | SF/F | | | 2500 Mustaf FreestVe Exhibition |
| | | | | | | TBA |

| SPORT HORSE RING - SANCTUARY | | | | HUNTER JUMPER RING 9:00 AM | | | | DRESSAGE COURTS 8:00 am | | | |
|------------------------------|--|------|------|----------------------------|--------------------|-----|------|-------------------------|---|------|----|
| # | Triangle 1 8:00 am | Sec | Team | # | Triangle 2 8:00 am | Sec | Team | # | Court 1 | Sec | @C |
| 2043 | H/A/A Sport Horse Gelding Stallion In Hand Dressage Type 3 & Over | SF/F | DD | | | | | | Kehr, Kolstadt | SF/F | SK |
| | | | | | | | | | 1421 Arabian Dressage Second Level CH | SF/F | |
| 2044 | H/A/A Sport Horse Gelding Stallion In Hand Hunter Type 3 & Over ATH | SF/F | HH | | | | | | 1502 H/A/A Dressage Training Level AAOTR CH | SF/F | |
| | | | | | | | | | | | |
| | Triangle 1 Afternoon TBA (Not Before Noon) | | | | | | | | Court 2 | | |
| 2781 | Arabian Sport Horse Stallion In Hand Dressage Type 3 & Over CH | SF/F | DD | | | | | | Stine-Masek, Mandas | SF/F | SM |
| | | | | | | | | | 883 A/H/A/A Dressage Prix St. George CH | SF/F | |
| 2721 | Arabian Sport Horse Stallions In Hand Hunter Type 3 & Over CH | SF/F | HH | | | | | | 888 A/H/A/A Dressage Intermediate II CH | SF/F | |
| | | | | | | | | | 1412 H/A/A Dressage Second Level AAOTR CH | SF/F | |
| | Triangle 2 Afternoon TBA (Not Before Noon) | | | | | | | | | | |
| | | | | | | | | | | | |
| | EVENING Not Before 5:30 | | | | | | | | Court 3 | | |
| 1236 | A/H/A/A Carriage Reinsmanship | SF/F | C | | | | | | Longacre, MacMahon | SF/F | BM |
| 1228 | A/H/A/A Carriage Driving Working | SF/F | C | | | | | | 2414 A/H/A/A Western Dressage Level 1 ATR CH | SF/F | |
| | | | | | | | | | 2552 A/H/A/A Western Dressage Level 3 CH | SF/F | |
| | Driving Excellence Award | | | | | | | | | | |
| 2682 | Arabian Sport Horse Under Saddle Hunter Type ATR CH | SF/F | HT | | | | | | | | |
| 2688 | H/A/A Sport Horse Under Saddle Hunter Type CH | SF/F | HT | | | | | | | | |
| 1505 | ABS Arabian Sport Horse 7 & Over Under Saddle AOTR Jackpot CH | SF/F | T1 | | | | | | | | |
| | Up to \$15,000 Sweetstakes plus Jackpot fee @ \$500 per horse | | | | | | | | | | |
| | CH = 20% RC = 10% TT = 8.75% | | | | | | | | | | |
| 2692 | H/A/A Sport Horse Under Saddle Dressage Type CH | SF/F | DT | | | | | | | | |
| 1026 | Supreme Sport Horse In Hand 3 & Over | SF/F | T3 | | | | | | | | |
| | Senior Star Award Presentation | | | | | | | | | | |

There are no Warm-Up rounds for the Hunter Derby or the Equestration.





Sport Horse Nationals

GENERAL RULES

PLEASE REFER TO GENERAL RULES FOR ALL SHOWS

ENTRY INFORMATION

Please refer to the General Rules GR 18

Online entry for the Sport horse National Championship Show will be available until midnight (MT) July 19, 2022.

Exhibitors are advised to use a form of expedited, traceable mail service when sending entries in order to ensure that their entries are received.

If you email your entries, please contact AHA if you do NOT get a return email acknowledging the receipt of your entry on the same or next business day.

AHA will accept faxed/emailed entries with a valid credit card. However we strongly discourage faxed entries. Photos of an entry form will not be accepted. Photos and Faxed Copies are often illegible.

DO NOT AN SUBMIT AN ENTRY BY MORE THAN ONE METHOD AS CREDIT CARDS MAY BE CHARGED MULTIPLE TIMES.

ENTERING FOR HORSES & RIDERS NOT QUALIFIED BY THE CLOSING DATE

Horses and riders that are not qualified as of the closing date but intend to qualify before the start of Sport Horse Nationals MUST enter and pay the fee.

If Results from a qualifying show have not been recorded, a qualification report signed by the show secretary will be required before a non qualified class will be qualified.

Failure to qualify for any one class will results in a refund for that class.

FULL PAYMENT must accompany your entry. Please do not split any charges for an entry between exhibitors, horses or stables.

Checks and credit cards covering multiple entries need to be accompanied by a detailed description of how the money is to be applied listing all the horses and total fees on a per horse and a contact phone number.

Mail to: Attn: Sport Horse Nationals
10805 East Bethany Drive, Aurora, CO 80014
Fax to: 303-696-4599 (please include cover sheet)
Email to: NationalEvents@ArabianHorses.org

POST ENTRIES

Post entries may not be listed in the program and may not be stalled with horses from the same barn.

ENTRY REFUNDS

Please refer to the General Rules GR 8.10

SHOW ACCOUNTS

Refer to GR 18.7

All open accounts must be closed before the closing of the Show Office by 5 PM on the last day of the show. Management will close all show accounts not closed out by the end of the show will be assessed a Failure to Close Out fee of \$100.00.

HORSES NOT ENTERED IN THE SHOW

Non-Competing horses will be accepted at Sport Horse Nationals If a stall is available and must check with the barn manager on stall availability.

Please refer to GR 31

There will be a \$750.00 fine per non-competing horse for not filing an official entry form with the show office.

UNREGISTERED HORSES

Please refer to GR 18.2.a and GR 44

RIDER/HANDLER EQUITATION HORSE CHANGES

Please refer to General Rules for all shows – GR 8.9

The order of go in all equitation classes is random.

If there is a change of Equitation horse after the order of go has been posted, the exhibitor with the change MAY be moved to the first go.

SCRATCHES & NO SHOWS

Please refer to the General Rules GR 8.5

CLASS SECTION REQUESTS

Please refer to the General Rules GR 8.6

Exhibitors with possible ring conflicts, should identify section requests on the Official Entry Form. At the show sections can be requested **via the AHA App, web site or in person at the show office.** All requests MUST be submitted BY NOON the day prior to when the sections are to be posted. Sections will be posted one day prior to the scheduled class. **If you have multiple classes the same day, it is strongly advised to look closely at the schedule and request a section that will work best for your situation.**

ARENA SIGNS

Arena signage may be purchased using the form using the Sponsorship form under the SHN Exhibitor Info page on the website. Arena signage space is limited and will be sold on a first come, first served basis. AHA will produce the arena signs as follows: one 3' x 4' sign, in the arena of your choice.

*Grey highlight indicates changes for 2022



Artwork for the signs must be emailed to NationalEvents@arabianhorses.org or mailed on CD to AHA by July 31. Artwork must be in .jpg or .png format. AHA is not liable for exact color match. Artwork must be laid out so that it will fit on a 3' x 4' horizontal sign. If you have any questions or want more information please email NationalEvents@arabianhorses.org.

AWARDS

Please refer to General Rules GR 5 for complete information.

The awards room will be open for your convenience September 13 - 18, from 8 AM until a 1/2 hour after classes end.

All awards not claimed by the close of the show will be forfeited with no exceptions.

Duplicate Awards will be for sale in the Awards Room for Champion, Reserve Champion Trophy and Top Ten Plaques.

SPECIAL AWARDS

Sponsored/Special awards (including, but not limited to those printed below) are to be considered separate from the Arabian Horse Association's prize list for a national event. Therefore, the Arabian and Half-Arabian Sport Horse Nationals and the Arabian Horse Association are not liable for providing or presenting any award (printed or otherwise) if a sponsor cancels or is unable to provide the agreed upon awards. These awards are subject to change.

MUSICAL FREESTYLE

Awards will be presented to the Champion and Reserve Champion.

Will be judged by one judge.

WESTERN DRESSAGE BASIC JUNIOR HORSE HIGH SCORE

Awards will be presented to the Champion and Reserve Champion.

DRIVING EXCELLENCE AWARD

Awards will be presented to the Champion and Reserve Champion.

To reward a superior turnout demonstrating excellence in cones, presentation, and performance. The awards will be presented to the Champion and Reserve Champion. Each place will be changed into points. For points see the chart below. No nomination is required.

Points shown under Scoring will awarded in the following classes:

- 1228** Carriage Driving Working
- 1232** Turnout
- 1236** Reinsmanship
- 1297** Pick Your Route

ABS DRESSAGE PROSPECT INCENTIVE

A Best Dressed Handler and Best Groomed Horse Award for entries in the Dressage Prospect Incentive class will be selected for entries into the jog and presented Friday evening before the start of the classes. These awards are sponsored by MaryJo Hoepner. Sweepstakes is only responsible for Sweepstakes prize money payout.

HIGH SCORE TRAINING LEVEL AWARD

The highest scoring Training Level Jr Horse six years of age or over will be presented with an award.

- 1401** Arabian Dressage Training Level Championship
- 1402** Arabian Dressage Training Level AAOTR Championship
- 1403** Arabian Dressage Training Level ATR Championship
- 1501** Half-Arabian/Anglo-Arabian Dressage Training Level Championship
- 1502** Half-Arabian/Anglo-Arabian Dressage Training Level AAOTR Championship
- 1503** Half-Arabian/Anglo-Arabian Dressage Training Level ATR Championship

SENIOR STAR AWARD

This award is to recognize the value of Arabian horses throughout their often long service years and recognized the value of older horses. Awards will be presented to horses 20 years and older who achieves 30 or more lifetime achievement points at Sport Horse Nationals.

PRIZE MONEY

ARABIAN BREEDERS SWEEPSTAKES PRIZE MONEY (ABS) CLASSES

Please refer to GR 3

RANDOMLY SELECTED CLASSES

Prize money will be paid to 9 classes [(3) Dressage classes, (1) Carriage Pleasure Driving, (1) Hunter, (2) Sport Horse In Hand and (2) Sport Horse Under Saddle] that are randomly selected each year. The Champion will receive \$1,000, the Reserve Champion will receive \$500 and the balance of the Top Ten will receive \$125

The following classes will receive prize money for 2022:

1. **266** Arabian Working Hunter
2. **821** A/H/AA Dressage Third level AATR
3. **1511** HA/AA Dressage First Level Open
4. **1322** A/HA/AA Carriage Pleasure Driving Timed Obstacles
5. **1692** HA/AA Sport Horse In Hand Geldings/ Stallions Hunter Type 3 & Over

**Grey highlight indicates changes for 2022*



Sport Horse Nationals

GENERAL RULES

6. **2316** Arabian Western Dressage
Basic Level Open
7. **2684** Arabian Sport Horse Under Saddle
Dressage Type
8. **2688** HA/AA Sport Horse Under Saddle
Hunter Type CH
9. **2881** HA/AA Sport Horse Mares In-Hand
Dressage Type 3 & Over

\$1,500 A/HA/AA OPEN JUMPER OPEN STAKE

The Champion will receive \$1,000, the Reserve Champion will receive \$500 and the balance of the Top Ten will receive \$125 in 1801 A/HA/AA Open Jumper Stake.

CAMPER & RECREATIONAL VEHICLE FACILITIES

RV Spaces will be available on a first come first serve basis for the entire show.

Please find the form on our website, www.ArabianHorses.org/export/content.export/nat-show/shn-show/22SHN_RV_Reservation_Form.pdf

CLASS INFORMATION & SPECS

When entering, please be aware of entering classes which might run in different rings at the same time. Every effort will be made to solve these conflicts, however rings will not be held for extensive periods to solve conflicts. Entry fees will be forfeited in case of time conflicts caused by two rings running simultaneously that can't be resolved.

ARABIAN BREEDERS SWEEPSTAKES CLASSES (ABS)

Refer to GR 3

**REFER TO SWP 116, SWP 117 AND SWP 118 REGARDING
PAYBACK FOR ABS NOMINATED HORSES**

ABS SPORT HORSE YEARLING IN-HAND CLASSES

The Yearling Sweepstakes Classes are restricted to Breeding Entries only. **This is the only qualification for these classes for Sport Horse Nationals.**

Yearlings are NOT permitted to cross enter into the Open or Amateur to Handle classes.

Yearlings must be shown in a plain leather stable halter as described in AR 178

ABS DRESSAGE PROSPECT INCENTIVE

The ABS Dressage Prospect Incentive class is restricted to 4 and 5 year old Sweepstakes nominated Breeding and Original Entries.

The AHA Dressage Prospect Incentive Test will be used and can be found on the AHA Website.

Horses will be examined for soundness. A jog will be scheduled prior to the Championship class at which time all horses must be presented to the treating veterinarian and a member of the judging panel for examination. Horses will be jogged on packed dirt or tarmac. Horses not presented for the jog or who do not pass the jog will not be eligible to show in the class

The two member judging panel will consist of either: One (1) USEF 'R' Judge and one (1) USEF 'S' Judge or two (2) USEF 'S' judges, both of whom will have the Young Horse designation. The panel shall sit together at C. Judges shall give one score and fill out general comments on one Marking Sheet.

Competition Management shall provide a sound system and microphone to allow the judges to give the audience a short summary after each ride.

Horses will be ranked in order of their scores in each test. Breaking of ties for individual classes will be in accordance with AR173. If two or more horses are tied for the same placing, breaking of ties will be at the judging panel's discretion.

Whips are not allowed.

ABS GREEN WORKING HUNTER DERBY CHAMPIONSHIP

The ABS Green Working Hunter Derby Championship is restricted for Green Working Hunters A/HA/AA which are nominated as a Breeding Entry or Original Entry who are eligible to compete as a green working hunter as outlined in the Arabian Working Hunter rules of USEF. No qualifications are required and the class is open to any age horse who is eligible to compete as a Green Working Hunter as outlined in the Arabian Working Hunter rules of USEF.

The Championship consists of three sections with fence heights offered at both 2'6" and 2'9" and riders choose the height at which their horse(s) compete. First year horses may compete at either 2'6" or 2'9" height but second year horses must compete at 2'9". All horses compete in the first two sections in which they receive numerical scores. The first round is 10-12 fences with the second round over a shortened course of 6-8 fences. The course will include natural elements and options. The second round will be a Handy Hunter Course. The 12 horses (or less), including those tied for 12th, with the highest combined scores from the first two rounds advance to the third Under Saddle section. Only the top four horses overall from the first two rounds are eligible to be named Champion or Reserve Champion. The remaining horses are eligible to be named in the Top Ten. This class is exempt from the 50% rule. Refer to SWP 116, SWP 117 and SWP 118 regarding payback for ABS nominated horses.

**Grey highlight indicates changes for 2022*



ABS SPORT HORSE UNDER SADDLE AOTR JACKPOT CLASSES

These classes are restricted to Arabians and Half-Arabian/Anglo-Arabians enrolled as a Breeding Entry or Original Entry and are **7 years** of age and older.

Each competitor will contribute \$500 to a prize money jackpot. The Sweepstakes Program will add \$1,000 per horse, up to a maximum of \$15,000 to each of the two purses.

Sweepstakes prize money and the additional Jackpot prize money will be awarded 20% to the Champion, 10% to the Reserve Champion, and 8.75% to each of the remaining Top Ten. Any Jackpot prize money not distributed shall be equally divided among all placings.

Sweepstakes prize money not awarded will be retained in the Sweepstakes principal fund. The 50% rule does not apply to these classes.

A horse that is co-owned by two distinct non family members per USEF AR 110.e.1 – 10 CAN NOT be shown in the AOTR Jackpot classes.

NATIONAL PERFORMANCE MATURITY

Enrollment into the Performance Maturity Program is required in order to participate in these classes. Payment can be made in full or in payments.

The nomination form and more information can be found on the AHA web site @ www.ArabianHorses.org/competition/prize-money-programs/performance/

These classes are for horses that are 5-6 years old. Enrollment into the program will serve as the qualification for the class.

Enrollment into the program *does not* constitute entry in the Sport Horse National Championship Show. You must enter into the Performance Maturity Class at Sport Horse Nationals on an official entry form or on-line at the AHA website by the day of entry close.

Enrollments may also be submitted after the deadline all the way up to the final close of Sport Horse Nationals (late fees will apply).

All Half-Arabians must have DNA type of the horse and the horse's purebred Arabian parent placed on permanent record with the AHA Registry and the horse must qualify as an offspring of the stated purebred sire or purebred dam through DNA testing in order to compete in the Performance Maturity Class. If the DNA is not on file before the class, the horse will be ineligible to be shown.

A horse that is co-owned by two distinct non family members per USEF AR 110.e.1 – 10 CAN NOT be shown in the AOTR Maturity classes.

For complete rules regarding the Performance Maturity Program, please refer to Chapter 20 of the AHA Handbook.

SHN SPORT HORSE IN HAND 3 YR OLD JACKPOT

These classes are for horses that are 3 years old. Payment of the Jackpot fee will serve as the qualification for the class, no other qualifications are required. No nominations are required.

Each competitor will contribute \$500 to a prize money jackpot. Any Jackpot prize money not distributed shall be equally divided among all placings. The 50% rule does not apply to these classes.

All Half-Arabians must have DNA type of the horse and the horse's purebred Arabian parent placed on permanent record with the AHA Registry and the horse must qualify as an offspring of the stated purebred sire or purebred dam through DNA testing in order to compete in the In hand Jackpot Class. If the DNA is not on file before the class, the horse will be ineligible to be shown. Anglo-Arabians are exempt from the DNA requirement.

This is a Jackpot Class only. No additional prize money will be issued from AHA prize money programs.

A/HA/AA MUSICAL FREESTYLE EXHIBITION (ENGLISH OR WESTERN)

This Musical Freestyle Exhibition class is not recognized by USEF or USDF. The Musical Freestyle Application (with complete rules) must be submitted with your entry.

Musical freestyle is an exciting combination of the technical and artistic aspects of a highly trained horse.

NEW FOR 2022

First Level Exhibitors are now eligible.

The helmet rule is in effect. Whips are permitted.

CARRIAGE DRIVING CLASSES

Carriage driving classes will follow USEF rules for Pleasure Driving (See Articles CP 101-120). Singles and multiples will be allowed in the Carriage Pleasure Driving classes. For multiples you will need to pick one horse to receive all points, awards, and recognition. Wire wheeled, pneumatic tired and combined driving marathon vehicles will not be permitted. No cantering allowed in the obstacle driving class. In the Ride and Drive the rider and driver may be different. A mandatory safety check will occur on all turnouts.

COMBINED TEST BEGINNER NOVICE (EXHIBITION)

Will run in accordance with USEF EV Chapter. Open to horses four years of age or older (EV Appendix 3. 3.1).

A combined test is a competition in which you and your horse complete a dressage test and then jump a show

**Grey highlight indicates changes for 2022*



Sport Horse Nationals

GENERAL RULES

jumping course. It's similar to a three-phase horse trials event, but you don't jump a cross-country course.

This class will consist of 2 sections (phases), a Dressage Section Judged by one Eventing or Dressage Judge and a Jumping Section judged by one Eventing or Hunter/Jumper Judge.

The Dressage section will run first then the Jumping section.

For Fence heights that will be 2'7" please refer to USEF EV Appendix 2 under Beginner Novice.

The dressage test will be Beginner Novice Test B. www.usef.org/forms-pubs/-a_LL_j9hmg/2018-beginner-novice-eventing-test-b. This test will also be on the AHA web site.

COMBINED TEST SCORING

Dressage Section Please Refer to USEF rule EV136

Jumping Section Please refer to USEF rule EV143
This section is timed. Penalty points are added up to produce a final total

FINAL PLACING

Competitors accumulate penalty points in each section, and at the end of the event, the pair with the lowest score takes home top honors.

DRESSAGE & WESTERN DRESSAGE CLASSES

NEW FOR 2022

To be eligible to participate and/or compete as an exhibitor, owner, lessee, agent, coach, or trainer in any Western Dressage class or at any Western Dressage Federation Licensed Competition persons must be active members of WDAA or pay a non-member fee equal to the price of an annual membership for each competition. Please refer to the General rules GR 28.2.

No readers or whips will be allowed, exception Western Dressage classes.

For Reader Exceptions see DR 122.4 and Handicapped & Electronic Communication Devices in the General Rules

DRESSAGE LEVEL RULES

Horses may enter no more than two consecutive levels, Freestyle levels included at any one competition.

Please see USEF DR 119.2 chart for the levels.

Current USEF / USDF Tests will be used as follows:

- Training Level - Test 3
- 1st Level - Test 3
- 2nd Level - Test 3
- 3rd Level - Test 3
- 4th Level - Test 3

**Grey highlight indicates changes for 2022*

- Prix St. Georges - Prix St. Georges
- Intermediate I - Intermediate I
- **Intermediate A & B (Not Offered at SHN)**
- Intermediate II - Intermediate II
- Grand Prix - Grand Prix
- AHA's Dressage Prospect Incentive Test 2019
- Western Dressage Basic Level - Test 4
- Western Dressage Level One - Test 4
- Western Dressage Level Two - Test 4
- Western Dressage Level Three - Test 4

DRESSAGE HELMET RULE

When cross entry by rider or horse/rider combination is permitted between Dressage and other Arabian classes at a competition, DR120 and DR121 apply only to the designated Dressage warm up and competition areas, or when an exhibitor is actually warming up for Dressage classes.

Helmet rule is also in effect for musical freestyle dressage riders.

HUNTER HACK CLASSES

The fences at National ATR and AAOTR classes will be set at 2'3" and Open Classes at 2'6". Hunter Hack Championship classes will follow the procedures outlined in the AHA Handbook COMP 810.

HUNTER HACK JUNIOR HORSE

Hunter Hack Championship classes will follow the procedures outlined in the AHA Handbook (REQ 210). Fence heights 2'3".

HUNT SEAT EQUITATION CLASSES

Refer to USEF EQ 107 for class routine, faults & eliminations.

1. NOT TO JUMP

Pattern will be posted 24 prior to the class.

Will have a rail work portion and also each competitor will be asked to perform two or more tests as outlined in the AHA Handbook REQ 209.8).

Judges must work competitors in groups of twenty (20) or less. Exhibitors will be excused from the ring following rail work and will perform their tests individually.

2. OVER OBSTACLES

Course will be posted 24 hours prior to class.

Fence heights are 2'9". This class will follow the procedures outlined in the USEF EQ-2. All competitors will compete over the Hunt Seat Equitation course and then the top four competitors from each judge's card will be required to perform two or more tests from USEF EQ 113, Test 1-17, as designated by the call judge. **In determining the Champion and Reserve Champion**



in the AHA Hunter Seat Equitation Final, the final test may only be completed by the top four riders).

WORKING HUNTER CLASSES

All Fence Heights are listed in the class list for each class.

Working Hunter Championship classes will be judged using AHA Score Cards and will follow the procedures outlined in the AHA Handbook REQ 213 /NATIONAL

Working Hunter Championships have two jumping classes (A, B) followed by an under saddle class (C) that is the Final. Riders may not be different from class to class (A, B and C). Exception:

In the Working Hunter Championship classes, if an exhibitor is showing more than one horse, they may appoint another rider to ride their other entries in the under saddle class per USEF AR 165.3.

All horses can compete in both jumping rounds; however this is not a requirement.

The first order of go shall be drawn. Riders may be permitted to ride back-to-back rounds at their discretion.

A rider may be permitted to compete out of order to minimize delays, but must be approved by management.

GREEN WORKING HUNTER CLASSES

Qualifications are not required for Green Working Hunter Championships. However, horses must still be eligible to show in the Green Working Hunter as defined by USEF AR162 b.1a.

WORKING HUNTER 14.2 & UNDER CH

This championship is open to any 14.2 and under Working Hunter. Measurement cards must be sent with your entry. Championship will run as defined by USEF in Article AR165 & AR166

A/HA/AA HUNTER DERBY

Hunter Derby Championships consist of two over fence classes with the top horses in the first class returning for a second over fence class. The course should include natural elements and options. The first class is 10 - 12 fences with the second class over a shortened course of 6 - 8 fences. Further the 2nd class will be a Handy Hunter Course. The number of horses returning for the second class can be determined by show management but may not exceed 12 horses nor can it be less than the number of ribbons plus 2 as entries allow. The Derby will be run as a combined hunter competition, with horses competing at 2'6", 2'9 and 3'. The height that the horse would compete at would be the maximum Hunter height that the horse/rider combination competed at during the show. A horse/rider combination may elect to jump a higher height than they jumped during the competition.

It is open to professional, amateur and junior riders; Arabian and Half-Arabian/ Anglo-Arabian horses. An individual rider may not enter more than 3 horses. There is no under saddle final class. All judges will sit together and provide one numerical score to be announced after each horse finished had completed the round. Horses entered will not be required to jog for soundness. Any unsoundness during the competition will be reflected in the scores from the judges (GR 1034.7).

JUMPER CLASSES

Jump Order: First go-round will be determined by random selection.

Jumper Attire: USEF JP111.8

Tables: Refer to USEF JP 145 - JP148

1149 A/HA/AA Speed Jumper
JP145 Table II, Sec. 1 - 1M (Time First Round)

1801 A/HA/AA Jumper
Stake JP145 Table II, Sec. 2 (a) - 1.1M
(Time First Jump-Off, leave the ring)

1803 A/HA/AA Jumper ATR
JP145 Table II, Sec. 2 (b) - 1M
(Time First Jump-Off, stay in the ring)

1805 A/HA/AA Novice Jumper
JP148 Table IV. Sec 1 - .9M
(Optimum Time First Round)

SPORT HORSE

SPORT HORSE IN-HAND CLASSES

Sport Horse In-Hand classes will be judged using the AHA Sport Horse Score Sheets as specified in the USEF Rule Book.

The Half-Arabian/Anglo Arabian-Stallion classes have been combined with Half-Arabian/Anglo Arabian-Geldings. Please refer to USEF rules GR823 and AR 176.1

To help avoid conflicts with other rings, once the number of horses in each of the Sport Horse In-Hand class has been determined, there will be a signup sheet with time frames for each class. **You will be able to sign up at the show on the AHA APP and web site.** If you do not sign up by Noon the day prior to your scheduled class, a go order will be assigned to you.

The Order of Go will be definite, but the times listed are approximate.

EXHIBITORS are requested to check the posted order of go EARLY for conflicts. In the event of a conflict with other rings, management will work with exhibitors within the time frame for each class as much as possible. If you miss your go, you missed your class.

All Sport Horse In-Hand classes will utilize the "Triangle" method of presenting their horses to the judges.

**Grey highlight indicates changes for 2022*



Sport Horse Nationals

GENERAL RULES

In keeping with the spirit and tradition of the Sport Horse, the show commission would like to remind exhibitors of the following rules and assure their enforcement.

USEF Rule AR 115.2 lists causes for mandatory elimination from the ring, including, but not limited to, removal of eyelashes, changing the natural color of the mane and/or tail, and the use of anything other than clear or transparent products on the hooves while being shown in Breeding and/or In-Hand classes.

USEF AR 115.3 An entry must be penalized for: excessive amounts of oil, grease or other similar substances, excessive use of the whip which might disturb other entries, and balding of the area around the eyes or proximal to the muzzle and nostrils.

USEF Rule AR 176 describes the conduct of sport horse in-hand classes. The commission would remind exhibitors the triangle will be trotted a second time only at the direction of the judge and that the horse is to be shown in an "open position" for conformation judging, otherwise the entry may be eliminated from judging consideration.

SPORT HORSE TWO YEAR OLD IN-HAND CLASSES

Two Year Old horses are NOT permitted to cross enter into the Open or Amateur to Handle classes. AHA Handbook QUAL 104.1.d)

Two Year Old horses may be shown in a bridle or a plain leather stable halter as described in USEF AR 178

SENIOR SPORT HORSE IN-HAND SUPREME CHAMPION

Champions from each of the Sport Horse In-Hand 3 & Over classes from both the Arabian and Half-Arabian/Anglo-Arabian classes will be allowed to show in this class. Only a Supreme Champion will be placed.

Horses will enter the ring one at a time at the trot, in back number order and be judged on:

Movement = 60 %
Conformation = 40 %.

Judges will then place 10 horses and a reserve. The total points scoring system will be used. The horses will be shown in-hand at the walk and trot and standing for conformation, but will not be shown on the triangle.

SPORT HORSE UNDER SADDLE CLASSES

Please refer to USEF AR 180 – AR184 for complete rules. Competitors with non-conforming appointments will be eliminated from judging consideration.

Appointments (tack & attire) must adhere to one discipline (dressage or hunter) and are not to be mixed. In classes not split by type, each exhibitor must ensure their appointments (tack & attire) adhere to one discipline

only (dressage or hunter). In classes split by dressage type and hunter type, each exhibitor must ensure the appointments (tack & attire) are legal for the type shown. Whips are allowed in Sport Horse Under Saddle Dressage Type per USEF AR107.17. Arabian Breed shows are exempt from rules in DR that are specific to Dressage National Championships where whips are prohibited

COMPETITION ARENAS

The climate-controlled indoor arenas at the World Equestrian Center connect to stable areas by covered walkways, so once you arrive, you'll never have to go outside. The entire facility is kept at a comfortable 68 degrees throughout. The state-of-the-art HVAC systems keep fresh air flowing. Industrial fans keep the air circulating in each arena.

The following table specifies the dimensions and footing of the competition and warm-up arenas:

- **R & L Arena** 120 X 615,
Custom blended GGT Footing, climate controlled
- **The Sanctuary** 210 X 350,
Custom blended GGT Footing, climate controlled
- **Roberts Arena** 108 x 260,
Premium footing, climate controlled
- **Roberts Arena schooling Arena** 60 X 150,
Premium footing
- **Bradley Arena schooling for the Sanctuary**
108 x 208, Custom blended GGT Footing
- **WEC Outdoor Horse Show complex:**
 - Jumper Ring 300' x 180'
 - Hunter 1 280' x 150'
 - Hunter 2 285' x 150'
 - Schooling 1 220' x 180'
 - Schooling 2 280' x 135'
 - Lunging Ring 320' x 220'

The management may move classes to other arenas if weather or class schedule issues necessitate such a move.

DOGS

Refer to the General rules GR 14

MOTORIZED VEHICLE/GOLF CARTS

All Golf Cart rentals will go through the facility of WEC.

Please refer to GR 30 and USEF Rule GR1301.7 regarding the motorized vehicles, including golf carts, motorcycles, scooters or other farm utility vehicles by minors.

QUALIFICATIONS

Please refer to GR 37

You are qualified from the earliest date you earn the participation required. There is no such thing as re-qualifying.

**Grey highlight indicates changes for 2022*



Qualifications are required for 2022. Please refer to the AHA Handbook or for the web site the following link, www.ArabianHorses.org/competition/resources/qualifications/

ENTERING FOR HORSES AND RIDERS NOT QUALIFIED BY THE CLOSING DATE

Horses and riders that are not qualified as of the closing date but intend to qualify before the start of the National Show they are entering **MUST** enter and pay the fee.

Qualifications for classes not qualified for by the closing date can be earned up to the start of the show.

A Qualification report signed by the show secretary from the qualifying show must be submitted before a non-qualified class will be qualified.

Horses must still be eligible to show in the Green Working Hunter as defined by USEF AR162 b.1a.

SCHEDULE & RING CONFLICTS

Please refer to the General Rules GR 38.

SCORING SYSTEMS

ALL Sport Horse Under Saddle classes **divided by type** will be judged using the 3 judges MOS scoring system (COMP 506).

All Sport Horse In-Hand will be scored using the Two-Judge Total Score system (COMP 502). Exception the Senior Sport Horse In-Hand Supreme will be judged with all 4 Sport Horse Judges using Total Points system.

Carriage Driving will be judged by 1 judge.

The Combined Test will utilize 1 Eventing Judge or 1 Dressage and 1 Jumper Judge.

Dressage will be judged by 2 Judges and scored according to the USEF Rulebook and the AHA Handbook (REQ 208).

The Two-Judge Total Point system will be used for Sport Horse Under Saddle (**NOT DIVIDED BY TYPE**), Working Hunter, Hunter Hack, Hunt Seat Equitation and Jumper classes.

Points Table

| Place | Points | Place | Points |
|-------|--------|-------|--------|
| 1 | 20 | 6 | 8 |
| 2 | 16 | 7 | 6 |
| 3 | 14 | 8 | 5 |
| 4 | 12 | 9 | 4 |
| 5 | 10 | 10 | 3 |

No points are awarded to any reserve or 11th place horse.

HEALTH REQUIREMENTS

Please refer to the General Rules GR 21

PLEASE DO NOT MAIL any Health papers with your entries.

All horses entering the World Equestrian Center grounds must have:

- Proof of a current negative Coggins test (within 12 months)
- A 30-day certificate of veterinary inspection, required for all horses arriving from outside the state of Ohio
- Proof of mandatory vaccinations, required per US Equestrian rules

Horses who fail to arrive with appropriate equestrian forms and paperwork cannot unload on to show grounds.

STABLING/ARRIVAL INFORMATION & FEED & BEDDING

Please refer to the General Rules GR 43

Feed and Bedding is available through the AHA Show Office. Price will be at the prevailing prices.

Shavings may be ordered with your online entry or on your entry form. **All Shavings must be ordered by August 22 to guarantee delivery to your stall upon arrival.**

No additional shavings or feed orders will be accepted after Wednesday, **September 14, Noon.**

Exhibitors are permitted to bring in outside feed and bedding for personal use, **HOWEVER, third party deliveries or sales are strictly prohibited.**

Exhibitors will be financially responsible for any alteration/

ATTENTION EXHIBITORS!
REMEMBER TO PICK UP YOUR AWARDS
THE AWARDS ROOM WILL BE OPEN FOR ONE HOUR
AFTER COMPLETION OF CLASSES EACH DAY





Sport Horse Nationals

GENERAL RULES

damage to their stalls on the premises.

Group Stabling due on or before Monday, August 22 Midnight (MT) **In-House/Electronically Dated.**

NO ARRIVAL is permitted prior to Thursday, September 8, NOON

Early arrival will be charged from:

- **Thursday September 8, noon to Saturday prior to 8:00 AM.**
- **\$30 per stall (horse & tack) per night for the entire reserved block. One stall opens the entire block.**

After Saturday 8:00 AM no additional charge.

Sunday Sept 18, by 8 AM Stalls must be vacated.

***NO EXCEPTIONS**

All stall fees must be paid in full at the time of entry as follows:

- \$220 per stall (12' x 12') (horse or tack)
- One paid stall per entered horse, all others are considered tack stalls. No subletting of stalls will be allowed.

When ordering just tack stalls, please use an entry form leaving the horse information blank. Please list the tack stalls on the stall reservation form as well.

ALL Non-Competing horses must be listed on the stall Reservation form.

GROUP STABLING

Please refer to the General Rules GR 43

AHA must receive all Stable Request forms for exhibitors wishing to be a part of a group (including on-line entries) by August 22 Midnight (MT) **In-House/Electronically Dated** to guarantee request.

PATRON/ELITE STABLING

PLEASE refer to the General Rules GR 32 & GR 43

Preferred stabling will be available only to those who are participating as Patron or Elite Sponsors for 2022.

Elite Sponsor stabling will be assigned prior to all others. These stabling assignments will be based on the date of the sponsorship form when full payment is submitted to AHA. Stalling seniority from the past sponsorship program will carry over.

Deadline to enroll as a Patron or Elite Sponsor to receive stalling preference is July 29.

Please note that Sponsorships must represent one entity only, and all stalls assigned to any one Elite Sponsor must be designated under a single name (a company, a farm, training stable, and individual, and a family are all considered single entities). The Elite Sponsor name must be

used as the Farm/Stable Name on the Sponsor Form and all horses stabled with them must be a part of that farm.

Only one set of identifying drapes or logos per paid Patron or Elite Sponsor will be allowed. Only the named Patron or Elite Sponsor shall be allowed to hang identifying drapes or logos. Farms/Stables wishing to "piggyback" with other farms/stables must purchase a Patron or Elite Sponsorship in order to hang identifying drapes or logos.

WORKING HUNTER/HUNTER HACK/JUMPER WARM UPS & SCHOOLING

ALL DAY SCHOOLING

All Day schooling will be on Sunday, September 11. The fee will be \$50 per horse and may be purchased on the Official Entry Form or from the show office.

Multiple rounds will be allowed as time permits. Show management has the right to limit the number of rounds per horse.

No horses will be allowed to participate that are not entered in Working Hunter, Hunter Hack, Jumper or Hunt Seat Equitation Over Obstacles or Hunter Derby classes.

Both trainers and exhibitors will be allowed to ride the horse during the schooling rounds. Back numbers must be worn during schooling rounds.

There will be no predetermined order of go.

HUNTER WARM UPS

One Warm up round is included for Working Hunter classes. It will precede the judged round. If an exhibitor declines to use the warm up, they may fill out a form from the Paddock/Gate person to take to the show office and a \$30.00 credit will be applied to their account after the show in the Denver Office.

There will be no warm-up rounds for the Hunter Derby or Hunt Seat Equitation Over Obstacles ATR CH.

Hunter Hack horses and riders will have the opportunity before the start of the class to school and warm up over the two fences, in the direction they are to be jumped. There is no charge for this Warm Up. Warm Up will be done in groups of five (5) or less, prior to the start of each Hunter Hack class.

WORLD EQUESTRIAN CENTER & FIRE MARSHALL & RULES

Please refer to the General Rules GR 23

Show Management and exhibitors of any animal brought to the Facility must observe all State of Ohio animal health regulations.

All dogs must be restrained on a leash at all times. Pet owners will be responsible for clean-up of droppings.

All horses must be washed in the designated wash areas only. No washing may be done in the stalls or alleyways.

Fireworks and firearms are prohibited from the grounds.

**Grey highlight indicates changes for 2022*

USDF Membership Benefits: USDF is dedicated to education, the recognition of achievement, and promotion of dressage. For details on member benefits, including educational programs, awards, and other opportunities, refer to the *USDF Member Guide* or the USDF website at www.usdf.org.

**This
competition
is recognized
by USDF
for 2022**

Membership Requirements for USEF-licensed/USDF-recognized Competitions: Owners and riders, including foreign riders and owners who are not residents of the US, wishing to participate in a USEF-licensed/USDF-recognized competition as a rider or owner/lessee, must have either a USDF Group Membership (GM), Participating Membership (PM), or have a USDF Non-Member (NM) identification number and pay the USDF Non-Member (NM) fee. (Note: USDF Business Members can own horses but cannot compete as riders with their USDF Business Membership.)

Horses competing at USEF-licensed/USDF-recognized competitions must have either a USDF Horse Identification (HID) number or a USDF Lifetime Horse Registration (LHR). Proper credentials or verification certificates must be presented to the competition secretary.

Riders and owners wishing to participate in a USEF-licensed/USDF-recognized competition, and not able to present the competition secretary with verification of a USDF membership or NM identification, and USDF LHR or USDF HID, must complete a USDF Competition Affidavit Form and pay the \$5 affidavit filing fee. A copy of a completed affidavit form from another competition may also be used for verification purposes for up to 60 days. (Exception: Affidavits cannot be used at Great American Insurance Group/USDF Regional Dressage Championships.)

Exceptions:

- Horses competing only in Individual Breed Classes (IBCs) at DSHB competitions, sires and dams of horses in DSHB group classes, where those sires or dams are not actually competing in the same competition, horses competing only in breed restricted dressage or DSHB classes at Regular Competitions (e.g. all Arabian, all Friesian, or all Morgan classes), or in USDF Introductory Level tests, pas de deux or quadrille, are exempt from this requirement. Also exempt are horses ridden in leadline, exhibitions, games and races, classes for 4-H members, walk-trot, academy, and opportunity classes.
- Riders and owners/lessees competing only in classes which are exempt from the USDF HID requirements are also exempt from the USDF NM identification number and NM fee requirements. Also exempt are handlers of horses competing in DSHB In-Hand or Group classes.

Memberships Defined

Participating Membership (PM): A membership issued to an individual directly by USDF. The membership year is December 1 through November 30. PMs are available for 1-year (\$90), 5-years (\$360), or life (\$1,800). A USDF Youth Participating Membership (YPM) is available for individuals who have not reached their 21st birthday by December 1 of the current membership year (\$72). A PM allows the member to compete at USEF-licensed/USDF-recognized competitions and to participate as a rider and/or owner/lessee for all Adequan®/USDF Year-End Awards and the Great American Insurance Group/USDF Regional Dressage Championship program.

Group Membership (GM): A membership issued to an individual by USDF when the member name and dues are submitted to USDF through an affiliate Group Member Organization (GMO). The GM year begins December 1 and ends November 30. A GM allows the member to compete at USEF-licensed/USDF-recognized competitions and participate in the USDF Rider Awards Program and the USDF Regional Schooling Show Awards Program.

Business Membership (BM): A membership that runs December 1 through November 30 and is issued to a business or organization directly by USDF. The USDF BM (\$240) offers a wider variety of advertising benefits. BMs satisfy requirements of horse ownership only.

Non-Member (NM) Identification Number: For each USDF NM owner/lessee and USDF NM rider there will be a USDF NM fee of \$35 per competition that must be collected by the show secretary and submitted to USDF, along with the USDF Report of Fees document and the \$5 affidavit fee and Competition Affidavit Form if the person cannot provide a copy of their USDF NM card. Owners/lessees or riders exempt from the NM number requirements are also exempt from paying the USDF NM fee. If there are multiple owners of a horse and all are NMs, only one of the owners must pay the NM fee. If the horse has at least one owner who is a current USDF PM, GM, or BM there is no NM fee assessed. Competition management will be invoiced for all applicable USDF NM fees not received with the USDF post-competition paperwork, along with a report listing all USDF NMs. Competition management is then required to submit the NM fees within 30 days to the USDF. An individual with a USDF NM identification number is not eligible for any USDF membership benefits. Once a USDF NM number has been assigned, a USDF NM card can be obtained from the USDF website.

Horse Identification (HID) Number: A one-time tracking number for horses (\$35). Scores earned by a horse with an HID number will be recorded, but will NOT be counted towards Adequan®/USDF Year-End Awards. A horse with an HID number is not eligible to compete in Great American Insurance Group/USDF Regional qualifying or championship classes. An HID number can be upgraded to a Lifetime Horse Registration (LHR) for a fee of \$80. If a horse has a USDF LHR it does not need an HID number. An HID number is a one-time fee that does not need to be renewed.

Lifetime Horse Registration (LHR): A horse with an LHR (\$115) is eligible for Adequan®/USDF Year-End Awards, and eligible to compete in Great American Insurance Group/USDF Regional qualifying and championship classes, assuming requirements for the owner and rider are met. If a horse has an LHR it does not need an HID number. An LHR does not need to be renewed.

How to Join USDF

Applications for USDF Participating Membership (PM), Business Membership (BM), Horse Identification (HID) number, and Lifetime Horse Registration (LHR) may be found in the following locations:

- On the USDF website: www.usdf.org. You can submit the application online or download the form and fax or mail it to the USDF office.
- In the show office at USEF-licensed/USDF-recognized competitions classified by USEF as Dressage Competitions, and Regular Competitions which are open to all breeds.
- By calling or writing the USDF office at (859) 971-2277, 4051 Iron Works Parkway, Lexington, KY 40511

The effective date of membership is the date the form and correct fees are received in the USDF office or, if applying at a competition, the date accepted by the competition secretary, provided the application is signed and dated by the competition secretary, member, and/or horse owner on that same day.



HOTELS

WORLD EQUESTRIAN CENTER LODGING

(937) 382-0985

HAMPTON INN & SUITES

201 Holiday Drive
Wilmington, OH 45177
(855) 271-3622

HOLIDAY INN WILMINGTON

123 Gano Road
Wilmington, OH 45177
(877) 895-5095

HOLIDAY INN EXPRESS

155 Holiday Drive
Wilmington, OH 45177
(877) 859-5095

WILMINGTON INN

909 Fife Avenue
Wilmington, OH 45177
(844) 382-3689

*Book early and mention you are with the Arabian Horse Association block.
Visit the Event Page at ArabianHorses.org to book online.*

VENDORS

FARRIER

Joe Proby
(708) 673-9692

GOLF CARTS

World Equestrian Center
(937) 382-0985

VETERINARIAN

**Equine Athlete
Veterinary Services**
12630 Merrill Rd
Pilot Point, TX 76258
(940) 686-0112

EMT

Ryan Davis

PHOTOGRAPHER

Don Stine
Don Stine Photography
1886 Highway 330
South Shirley, AR 72153
www.donstine.com

WEBSTREAMING

Arabian Horse Association
www.arabianhorses.stream

FEED & BEDDING

Must be purchased thru the
show office

Information subject to change before show dates. Visit the Event Page at ArabianHorses.org for updates.



For updates and event news follow us on
Twitter @AHAArabian, **TikTok** @arabianhorseassoc,
Facebook @ Arabian Horse Association,
Instagram @ arabianhorseassoc & on the **AHA APP**



Sport Horse Nationals

FACILITY MAP

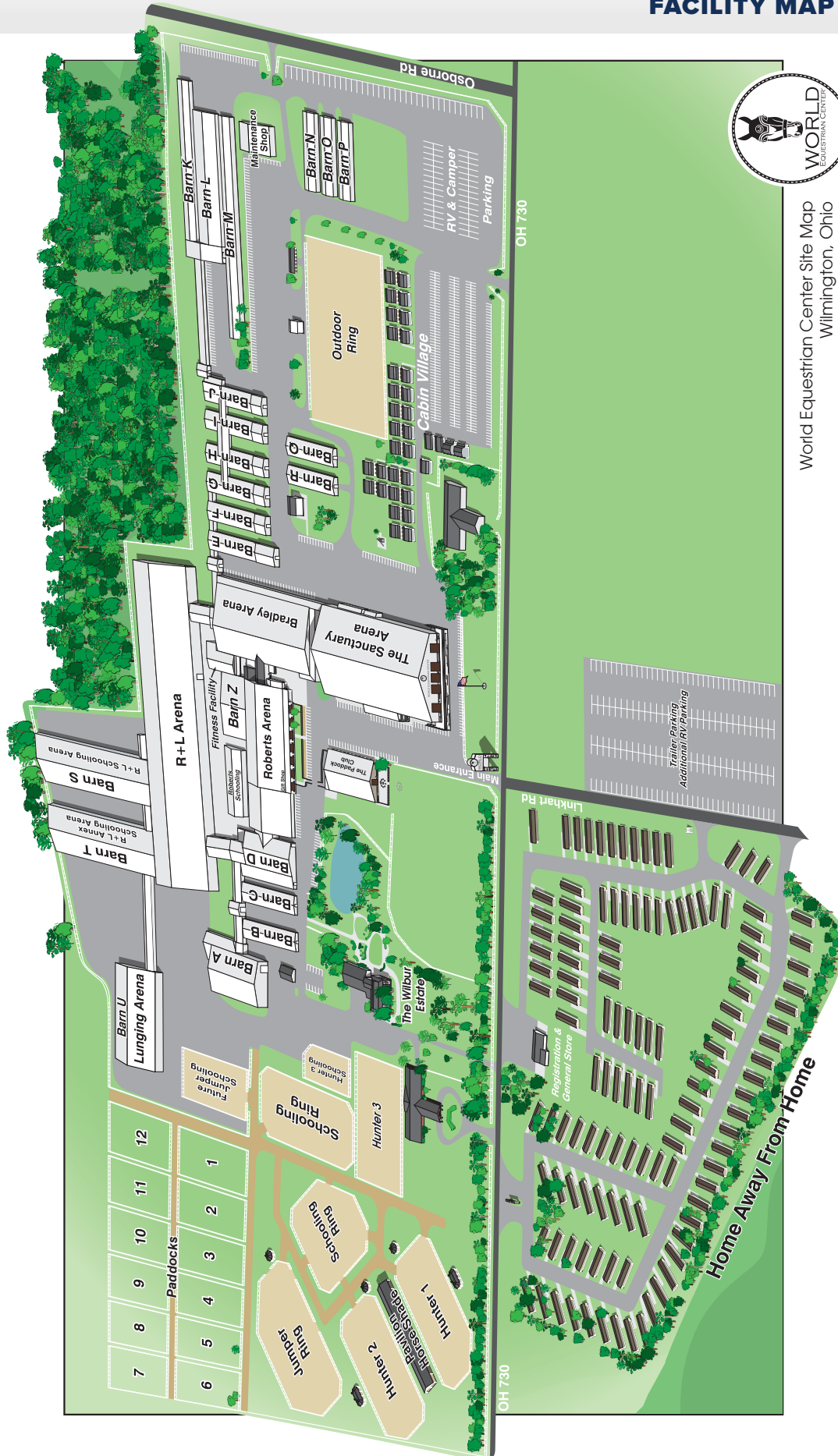

World Equestrian Center Site Map
Wilmington, Ohio



2022 SPORT HORSE NATIONAL ARABIAN & HALF-ARABIAN CHAMPIONSHIP

Official Entry Form

PLEASE TYPE OR PRINT ❖ ONLY ONE HORSE PER ENTRY FORM.

Please do not split any charges between exhibitors, horses or stables

- ☐ Please check here if this is a Non Competing Horse (Total fee due \$395)
- ☐ Please check here if this is adding classes for a horse already entered

| | | | | | | | |
|----------------------------|----------|--------------------|-------------------------------|----------------|--|--------------|-----------------------|
| Horse's Name | | Reg. No. | | DOB MM/DD/YY | Sex | Color | Sweepstakes Yes No |
| Sire | | Dam | | Horse USEF ID# | | Horse USDF # | |
| Rider 1 | | Classes / Sections | | | | | Total Rider 1 |
| **First Time Rider? Yes NO | | Entry Fees | \$ | \$ | \$ | \$ | \$ |
| Name | | DOB MM/DD/YY | Amateur Certificate Yes No | | Rider's Relation to horse owner(s) for owner classes | | |
| AHA# | USEF/EC# | USDF# | WDAA# | | US Citizen: Yes No | | |
| Rider 2 | | Classes / Sections | | | | | Total Rider 2 |
| **First Time Rider? Yes NO | | Entry Fees | \$ | \$ | \$ | \$ | \$ |
| Name | | DOB MM/DD/YY | Amateur Certificate Yes No | | Rider's Relationship to horse owner(s) for owner classes | | |
| AHA# | USEF/EC# | USDF# | WDAA# | | US Citizen: Yes No | | |

Each person signing this entry form acknowledges that he/she has read the front and reverse of this Entry Form and agrees to the applicable terms, conditions, waivers. Each person agrees that the information is accurate to the best of his/her knowledge

**** SAVE PAPER AND POSTAGE!!****

PLEASE ONLY SEND Photo copies of registration papers and USEF/EC Membership cards for each Rider / Driver / Handler / Trainer / Owner with your entry!

OWNER INFORMATION

Owner name as it appears on registration papers/purchase contract

Name _____

If Joint owner check one: Non Related Co Owner _____ Related _____ Relationship? _____

AHA# _____ USEF/EC# _____ USDF# _____ WDAA# _____

Farm/Ranch _____ USEF Farm# _____

Current Address _____ Phone _____

City _____ ST _____ Zip _____

Email _____

TRAINER INFORMATION

(must be filled out, if there is no trainer, the person responsible for the horse at the show)

Name _____

AHA# _____ USEF/EC# _____ WDAA# _____

Address _____ Phone _____

City _____ ST _____ Zip _____

Email _____

All Acknowledgements will ONLY be emailed to either the Owner _____ OR Trainer _____ (Check 1 Only)

Email Address (Please Print) _____

NO ENTRIES will be accepted for new horses OR added classes after Aug 22

Total Entry Fees _____ \$ _____

____ Post Entry Fee (per horse) @ \$500 ----- \$ _____
FOR HORSES ENTERING AFTER JULY 19

____ Late Class Fee PER CLASS @ 100 ----- \$ _____
FOR HORSES ENTERED BY JULY 19

Competing Horse Mandatory fees include the following
*** Mandatory fees are not due when adding classes

- 1 Office Fee per horse ----- @ 75
- 1 USEF Fee 15. Drug, 8. Admin ----- @ 23
- 1 AHA Resolution 9-90 ----- @ 25
- 1 AHA Scoring ----- @ 15
- 1 Horse Stall ----- @ 220

Mandatory Fees Total 358.00 ----- \$ _____

Additional Fees

PLEASE - DO NOT SPLIT COST OF TACK STALLS

____ Tack Stall @ \$220. ----- \$ _____

____ Shavings @ \$10 Per bale(subject to change) \$ _____

Non Competing Horse Mandatory Fees ----- \$ _____
(\$395 Includes stall, office & Non Competing horse fee)

Non Member

____ USEF Show Pass Non member @ \$45 -- \$ _____

Optional Items

____ All Day Schooling @ \$50 per horse ----- \$ _____

Donation to AHYA ----- \$ _____

Leave TOTAL FEES DUE blank for AHA to total your entry

TOTAL FEES DUE (with Check or MO) \$ _____

**Convenience Fee is due for
Credit cards payments only**

**** Convenience fee @ 3% ----- \$ _____**

TOTAL DUE (with Convenience Fee) - \$ _____

Office use

A/P _____

A/C# _____

O/S _____

INV# _____

POST MARK DATE _____

CLOSING DATES - July 19 with out Late Fees - IN HOUSE BY August 22 With Late Fees

NO ENTRIES will be accepted for new horses OR added classes after Aug 22

Mail entries to AHA: %Sport Horse Nationals 10805 E Bethany Dr, Aurora, CO 80014

Method Of Payment (US Funds Only) Payment in **FULL** is due with entries

****Effective June 1, 2019, a required 3% Convenience Fee will be added by AHA to payments made by Credit Card. A Convenience Fee charge does not apply if the customer submits payment by check or money order.**

☐ Credit Card ☐ Check Enclosed Payable to AHA Check # _____

Credit Card# _____ \$ _____

Print Name as it
appears on CC

Exp Date _____ CVS _____ Signature _____

Credit Card Billing Address (include zip)

AHA ENTRY AGREEMENT

I have read the rules concerning competitions as printed in the Arabian Horse Association (AHA) Handbook / Directory and Competition Prize List and agree to be bound by and subject to those Rules.

AHA ASSUMPTION OF RISK, RELEASE AND INDEMNIFICATION **This document waives very important legal rights. Read it carefully before signing.**

In consideration for AHA permitting me to participate in this Competition, and by signing the entry blank, I agree as follows:

I AGREE that I choose to participate voluntarily in this Competition, as a rider, driver, handler, lessee, owner, agent, coach, trainer, junior exhibitor, or as a parent or guardian of a junior exhibitor. **I AM FULLY AWARE AND ACKNOWLEDGE THAT HORSE SPORTS AND PARTICIPATION IN THIS COMPETITION INVOLVE SERIOUS RISK OF HARM INCLUDING, BUT NOT LIMITED TO, RISKS OF ACCIDENT, SERIOUS BODILY INJURY, INCLUDING DEATH, BROKEN BONES, HEAD INJURIES, TRAUMA, PAIN, AND SUFFERING, AND PROPERTY DAMAGE. I ASSUME ALL RISKS OF HARM TO ME, MY HORSE OR MY PROPERTY.**

I AGREE as a Horse Show Participant (or Parent/Guardian of Participant if a minor) to waive all claims which may otherwise arise from, including but not limited to infectious bacteria, viruses, fungi/mold, parasites or other agents which may be present at the Horse Show (and most other outdoor locations) and can cause infection in humans, as well as in animals.

I AGREE for myself, my heirs, executors, administrators, successors and assigns to release AHA, the Competition, the facilities leased by the Competition and the owner(s) of the facilities, and all of their respective officers, officials, directors, employees, agents, personnel, volunteers, affiliated organizations and insurers (collectively, the "Released Parties") from any and all claims for damage, loss, or injury to myself, other persons, horses or other property belonging to me to the fullest extent permitted by law that arises out of or relates in any way to the Competition and my participation in the Competition INCLUDING, BUT NOT LIMITED TO, DAMAGES, LOSS, OR INJURY RESULTING FROM ANY ACTS, FAILURE TO ACT, NEGLIGENCE OR NEGLECT OF OTHER ENTRANTS, THE RELEASED PARTIES, THEIR CONTRACTORS OR INVITEES, as well as for theft, vandalism, fire, other casualty damage, or damage arising out of any defects in the premises.

I AGREE to indemnify and hold harmless (that is pay all losses, damages, attorneys fees and costs of) the Released Parties from and against any and all claims, demands, penalties, actions, losses, costs, damages, injuries, liabilities and obligations (including attorneys fees) of whatsoever kind and nature, which may be asserted against or incurred by any of them as a result of (1) my participation in the Competition or (2) any act, failure to act, or neglect (a) by me, my agents, employees, riders, handlers, trainers, coaches, drivers, contractors or invitees, or (b) by any animal owned or exhibited by me or in my custody or control.

I AGREE and represent that I am qualified and eligible to enter and/or participate in the Competition, and every horse I am entering is qualified and eligible as entered.

I AGREE to accept AS FINAL any decision of AHA, the Show Commission or Show Officials concerning my qualification or the qualification of my horse to enter the Competition or any results of the Competition, except to the extent that the Rules of AHA, the Competition, EC or USEF Equestrian permit a protest or hearing of such decisions. Should a hearing be requested, I agree to accept AS FINAL the decision of the particular hearing body. I agree to release, hold harmless and not to sue AHA, the Competition Sponsor, their officers, directors, employees, volunteers or members concerning any decision of AHA, the Competition, its Show Commission, Show Officials or any hearing body that relates to my qualifications or my horse(s)' qualifications to enter the Competition or any results of the Competition.

I AGREE that AHA has the sole right to control, sell, supervise or give away (or assign to others the right to do so) the exclusive rights to broadcast, televise, reproduce, transmit and disseminate all or part of this event, and I agree that AHA may use or assign, in any way AHA sees fit, photographs, films, videos, audios, cablecasts, or other likenesses of me and my horse taken during the course of the Competition for the promotion, coverage or benefit of the Competition or AHA. Those likenesses shall not be used to advertise a product and they may not be used in such a way which implies endorsement of any company, product, product category or service. I hereby expressly and irrevocably waive and release any rights in connection with such use, including any claim to compensation, invasion of privacy, right of publicity, or to misappropriation.

By signing below as a parent or guardian of a junior exhibitor, I consent to the child's participation and agree to all of the above provisions, and further agree to assume all of the obligations of this AHA Assumption of Risk, Release and Indemnification personally and on behalf of the child.

This AHA Assumption of Risk, Release and Indemnification is governed by the Laws of the State of Colorado and is intended to be interpreted as broadly as possible. I agree that exclusive jurisdiction and venue (place) for any legal action against AHA, its officers, directors, employees, volunteers or agents shall be in the local district courts or the federal court of the State of Colorado. If any part of this agreement is determined to be unenforceable, all other parts shall remain effect.

USEF FEDERATION ENTRY AGREEMENT

By entering a Federation-licensed Competition and signing this entry blank as the Owner, Lessee, Trainer, Manager, Agent, Coach, Driver, Rider, Handler, Vaultor or Longeur and on behalf of myself and my principals, representatives, employees and agents, I agree that I am subject to the Bylaws and Rules of The United States Equestrian Federation, Inc. (the "Federation") and the local rules of the Arabian Horse Association National Championships (Competition). I agree to be bound by the Bylaws and Rules of the Federation and of the competition. I will accept as final the decision of the Hearing Committee on any question arising under the Rules, and agree to release and hold harmless the competition, the Federation, their officials, directors and employees for any action taken under the Rules. I represent that I am eligible to enter and/or participate under the Rules, and every horse I am entering is eligible as entered. I also agree that as a condition of and in consideration of acceptance of entry, the Federation and/or the Competition may use or assign photographs, videos, audios, cable - casts, broadcasts, internet, film, new media or other likenesses of me and my horse taken during the course of the competition for the promotion, coverage or benefit of the competition, sport, or the Federation. Those likenesses shall not be used to advertise a product and they may not be used in such a way as to jeopardize amateur status. I hereby expressly and irrevocably waive and release any rights in connection with such use, including any claim to compensation, invasion of privacy, right of publicity, or to misappropriation. The construction and application of Federation rules are governed by the laws of the State of New York, and any action instituted against the Federation must be filed in New York State. See GR908.4.

I HAVE CAREFULLY READ THIS DOCUMENT IN ITS ENTIRETY, UNDERSTAND ALL OF ITS TERMS AND CONDITIONS, AND KNOW IT CONTAINS AN ASSUMPTION OF RISK, RELEASE AND WAIVER FROM LIABILITY, AS WELL AS A HOLD HARMLESS AND INDEMNIFICATION OBLIGATIONS.

By signing below, I (as the participant or as the Parent/Legal Guardian of the minor identified below) hereby accept and agree to the terms and conditions of this Agreement in connection with my (or the minor's) participation in any USEF Event. If, despite this Agreement, I, or anyone on my behalf or the minor's behalf, makes a claim for Liability against any of the Released Parties, I will indemnify, defend and hold harmless each of the Released Parties from any such Liabilities as the result of such claim.

BY SIGNING BELOW, I AGREE to be bound by all applicable Federation Rules and all terms and provisions of this entry blank and all terms and provisions of this Prize List. If I am signing and submitting this Agreement electronically, I acknowledge that my electronic signature shall have the same validity, force and effect as if I affixed my signature by my own hand.

| | | |
|--|---------------------------------|-------------------|
| Owner ** Mandatory Must be Adult | Print Name | **Adult Signature |
| Trainer or Custodian of horse @ show ** Mandatory Must be Adult | Print Name | **Adult Signature |
| Rider 1 ** Mandatory Must be Adult | Print Name | **Adult Signature |
| Rider 2 ** Mandatory Must be Adult | Print Name | **Adult Signature |
| Coach – (if applicable) USEF # | Print Name | **Adult Signature |
| Print Minor Name Here | Print Parent/Guardian Name Here | **Adult Signature |
| Print Minor Name Here | Print Parent/Guardian Name Here | **Adult Signature |
| ***** EMERGENCY PHONE NUMBER FOR EXHIBITOR | | |
| <i>BOTH WAIVERS MUST BE SIGNED BY ADULTS ONLY</i> AHA or USEF/EC Membership is not required for Parents/Guardians signing for minors. | | |



WAIVER AND RELEASE OF LIABILITY, ASSUMPTION OF RISK AND INDEMNITY AGREEMENT

Part 2

Both waivers must be signed

For and in consideration of United States Equestrian Federation, Inc. dba US Equestrian ("USEF") allowing me, the undersigned, to participate in any capacity (including as a rider, driver, handler, vaulter, longeur, lessee, owner, agent, coach, official, trainer or volunteer) in a USEF sanctioned, licensed or approved event or activity, including but not limited to equestrian clinics, practices, shows, competitions and related or incidental activities and _____ ("USEF Event" or "USEF Events"); I, for myself, and on behalf of my spouse, children, heirs and next of kin, and any legal and personal representatives, executors, administrators, successors,, and assigns, hereby agree to and make the following contractual representations pursuant to this Agreement (the "Agreement"):

A. RULES AND REGULATIONS: I hereby agree to be bound and abide by the rules, regulations, and policies of USEF as published in the USEF Rule Book and on the website at www.usef.org, as amended from time to time.

B. ACKNOWLEDGMENT OF RISK: I knowingly, willingly, and voluntarily acknowledge the inherent risks associated with the sport of equestrian and know that horseback riding and related equestrian activities are inherently dangerous, and that participation in any USEF Event involves risks and dangers including, without limitation, the potential for serious bodily injury (including broken bones, head or neck injuries), sickness and disease (including communicable diseases), trauma, pain & suffering, permanent disability, paralysis and death; loss of or damage to personal property (including my mount & equipment) arising out of the unpredictable behavior of horses; exposure to extreme conditions and circumstances; accidents involving other participants, event staff, volunteers or spectators; contact or collision with other participants and horses, natural or manmade objects; adverse weather conditions; facilities issues and premises conditions; failure of protective equipment (including helmets); inadequate safety measures; participants of varying skill levels; situations beyond the immediate control of the USEF Event organizers and competition management; and other undefined, not readily foreseeable and presently unknown risks and dangers ("Risks").

WARNING:

Under Colorado Law, an equine professional is not liable for an injury to or the death of a participant in equine activities resulting from the inherent risks of equine activities, pursuant to section 13-21-119, Colorado Revised Statutes .

C. ASSUMPTION OF RISK: I understand that the aforementioned Risks may be caused in whole or in part or result directly or indirectly from the negligence of my own actions or inactions, the actions or inactions of others participating in the USEF Events, or the negligent acts or omissions of the Released Parties defined below, and I hereby voluntarily and knowingly assume all such Risks and responsibility for any damages, liabilities, losses, or expenses that I incur as a result of my participation in any USEF Events. I also agree to be responsible for any injury or damage caused by me, my horse, my employees or contractors under my direction and control at any USEF Event.

D. WAIVER AND RELEASE OF LIABILITY, HOLD HARMLESS AND INDEMNITY: In conjunction with my participation in any USEF Event, I hereby release, waive and covenant not to sue, and further agree to indemnify, defend and hold harmless the following parties: USEF, USEF Recognized Affiliate Associations, the United States Olympic & Paralympic Committee (USOPC), USEF clubs, members, Event participants (including athletes/riders, coaches, trainers, judges/officials, and other personnel), the Event owner, licensee, and competition managers; the promoters, sponsors, or advertisers of any USEF Event; any charity or other beneficiary which may benefit from the USEF Event; the owners, managers, or lessors of any facilities or premises where a USEF Event may be held; and all directors, officers, employees, agents, contractors, and volunteers of any of the aforementioned parties (**Individually and Collectively, the "Released Parties" or "Event Organizers"**), with respect to any liability, claim(s), demand(s), cause(s) of action, damage(s), loss, or expense (including court costs and reasonable attorney fees) of any kind or nature ("**Liability**") which may arise out of, result from, or relate in any way to my participation in the USEF Events, including claims for Liability caused in whole or in part by the negligent acts or omissions of the Released Parties.

E. COMPLETE AGREEMENT AND SEVERABILITY CLAUSE: This Agreement represents the complete understanding between the parties regarding these issues and no oral representations, statements or inducements have been made apart from this Agreement. If any provision of this Agreement is held to be unlawful, void, or for any reason unenforceable, then that provision shall be deemed severable from this Agreement and shall not affect the validity and enforceability of any remaining provisions.

I HAVE CAREFULLY READ THIS DOCUMENT IN ITS ENTIRETY, UNDERSTAND ALL OF ITS TERMS AND CONDITIONS, AND KNOW IT CONTAINS AN ASSUMPTION OF RISK, RELEASE AND WAIVER FROM LIABILITY, AS WELL AS A HOLD HARMLESS AND INDEMNIFICATION OBLIGATIONS.

By signing below, I (as the participant or as the Parent/Legal Guardian of the minor identified below) hereby accept and agree to the terms and conditions of this Agreement in connection with my (or the minor's) participation in any USEF Event. If, despite this Agreement, I, or anyone on my behalf or the minor's behalf, makes a claim for Liability against any of the Released Parties, I will indemnify, defend and hold harmless each of the Released Parties from any such Liabilities as the result of such claim.

The parties agree that this agreement may be electronically signed. The parties agree that the electronic signatures appearing on this agreement are the same as handwritten signatures for the purposes of validity, enforceability, and admissibility.

Check all that apply

☐ RIDER/DRIVER/HANDLER/VAULTER/LONGEUR ☐ OWNER ☐ TRAINER ☐ OFFICIAL ☐ STAFF ☐ VOLUNTEER ☐ COACH (IF APPLICABLE)

Signature: _____ Date: _____ Print Name: _____

Parent/Guardian Signature: (Required if Rider/Driver/Handler/Vaulter/Longeur is a minor) _____ Date: _____

Print Parent//Guardian Name: _____ Emergency Contact Phone No. _____

If you are attending for any reason not listed above please list _____ 6.17.20